

# DETOUR SIGN LEGEND

NO.	SIGN	SIGN DESIGNATION	SIGN DIMENSION
1	MAIN ST. CLOSED AT LOCH ARBOUR BRIDGE FOLLOW DETOUR (BLACK ON ORANGE)	SIGN A	60" x 30"
2	ROAD CLOSED AHEAD	W20-3	48" x 48"
3	DETOUR AHEAD	W20-2	48" x 48"
4	TO	M4-5	24" x 12"
5	NORTH	M3-1	24" x 12"
6	SOUTH	M3-3	24" x 12"
7	MAIN ST	SIGN B	24" x 12"
8	GRASSMERE AVE	SIGN C	36" x 12"
9	LOCH ARBOUR	SIGN D	36" x 12"
10	ALLENHURST	SIGN E	36" x 12"
11	ASBURY PK	SIGN F	30" x 12"
12	INTERLAKEN	SIGN G	30" x 12"
13	DETOUR	M4-9R	30" x 24"
14	DETOUR	M4-9L	30" x 24"
15	DETOUR	M4-9X	30" x 24"
16	BRIDGE CLOSED	R11-2 (MOD.)	48" x 30"
17	DETOUR	M4-10L	48" x 18"
18	END DETOUR	M4-8a	24" x 18"
19	ON OR ABOUT 2012 THIS BRIDGE WILL BE CLOSED FOR APPROX. 180 DAYS FLURAL ROUTE (BLACK ON ORANGE)	SIGN H	84" x 42"
20	DIP	W8-2	36" x 36"
21	ROAD CLOSED	R11-2	48" x 30"
22	ROAD CLOSED TO THRU TRAFFIC	R11-4	60" x 30"
23	NO LEFT TURN	R3-1	36" x 36"
24	NO RIGHT TURN	R3-2	36" x 36"
25	SIDEWALK CLOSED AHEAD CROSS HERE	R9-11	24" x 18"

**LEGEND**

- 15 SIGN NUMBER
- SIGN
- ⌋ BREAKAWAY BARRICADE
- ⌋ BREAKAWAY BARRICADE WITH SIGN
- ▬ PRECAST CONCRETE CURB, CONSTRUCTION BARRIER, TYPE 4
- ▨ WORK ZONE
- DETOUR ROUTE
- ▭ BODY OF WATER

### GENERAL NOTES:

- SPECIAL SIGNS SHALL HAVE A BLACK MESSAGE OR ARROW ON A FLUORESCENT ORANGE RETROREFLECTIVE BACKGROUND AND SHALL BE FABRICATED FROM THE MATERIAL SPECIFIED IN THE CURRENT EDITION OF STANDARD SPECIFICATIONS FOR ROAD AND BRIDGE CONSTRUCTION FROM NEW JERSEY'S DEPARTMENT OF TRANSPORTATION. FOR PROPER LETTER STROKE AND DESIGN, REFER TO THE CURRENT EDITION OF STANDARD ALPHABETS FOR HIGHWAY SIGNS AND PAVEMENT MARKINGS FROM THE FEDERAL HIGHWAY ADMINISTRATION. SPACING BETWEEN WORDS IN A LINE, BETWEEN LINES OF A MESSAGE, AND BORDER REQUIREMENTS SHOULD BE DETERMINED BY GOOD SIGN-DESIGN PRACTICES.
- FOR MORE INFORMATION ABOUT STANDARD AND SPECIAL SIGNS, REFER TO THE CURRENT EDITIONS OF STANDARD HIGHWAY SIGNS AND MANUAL ON UNIFORM TRAFFIC CONTROL DEVICES FOR STREETS AND HIGHWAYS, BOTH FROM THE FEDERAL HIGHWAY ADMINISTRATION.
- ONLY TYPE III BREAKAWAY BARRICADES THAT ARE NCHRP-350 COMPLIANT SHALL BE USED; WOODEN BARRICADES ARE NOT ALLOWED. IN ADDITION, FLASHING/STEADY WARNING LIGHTS SHALL NOT BE AFFIXED TO ANY SIGN OR BARRICADE.
- THE ADVANCE WARNING SIGNS ARE TO BE POSTED A MINIMUM OF TWO WEEKS PRIOR TO THE EFFECTIVE DATE OF THE DETOUR, AND ARE TO BE REMOVED AT THE START OF CONSTRUCTION.
- THE CONTRACTOR IS TO NOTIFY THE MUNICIPALITIES OF LOCH ARBOUR, INTERLAKEN, ALLENHURST, ASBURY PARK, AND OCEAN AT LEAST 48 HOURS PRIOR TO THE INSTALLATION OF DETOUR SIGNS.
- UNLESS NOTED OTHERWISE, ALL SIGNS AND BARRICADES SHALL BE FURNISHED BY THE CONTRACTOR AND PLACED AT THE LOCATIONS DESIGNATED BY THE ENGINEER. IF SO DIRECTED BY THE ENGINEER, AND AT THE UNIT PRICE BID, THE CONTRACTOR SHALL SUPPLY AND PLACE ADDITIONAL SIGNS AND BARRICADES.
- THE CONTRACTOR SHALL COORDINATE WITH THE ENGINEER AND THE LOCAL MUNICIPALITY SHOULD THE NEED ARISE TO CLOSE A LOCAL ROAD.
- ALL SIGNS SHALL BE LOCATED WITHIN THE MUNICIPAL, COUNTY OR STATE RIGHT-OF-WAY.
- THE CONTRACTOR SHALL NOTIFY THE MUNICIPALITIES OF LOCH ARBOUR, INTERLAKEN, ALLENHURST, ASBURY PARK, AND OCEAN POLICE AND FIRE DEPARTMENTS, SCHOOL DISTRICT, AND ENGINEER ONE WEEK PRIOR TO THE START OF CONSTRUCTION AND 24 HOURS PRIOR TO ROAD CLOSURE.
- POSITIVE CLOSURE SHALL BE MAINTAINED BETWEEN THE PRECAST CONCRETE CURBS DURING NONWORKING HOURS. THE CURB NEED NOT BE BOLTED DOWN.
- CONTRACTOR SHALL COVER ALL EXISTING SIGNS THAT ARE CONFLICTING WITH THE DETOUR PLAN SIGNS AS SHOWN ON THIS PLAN.
- WHERE A ROAD CONSTRUCTION AREA IS ADJACENT TO SIDEWALKS, ORANGE PLASTIC RETROREFLECTIVE CONSTRUCTION FENCING SHALL BE USED FOR PEDESTRIAN PROTECTION.

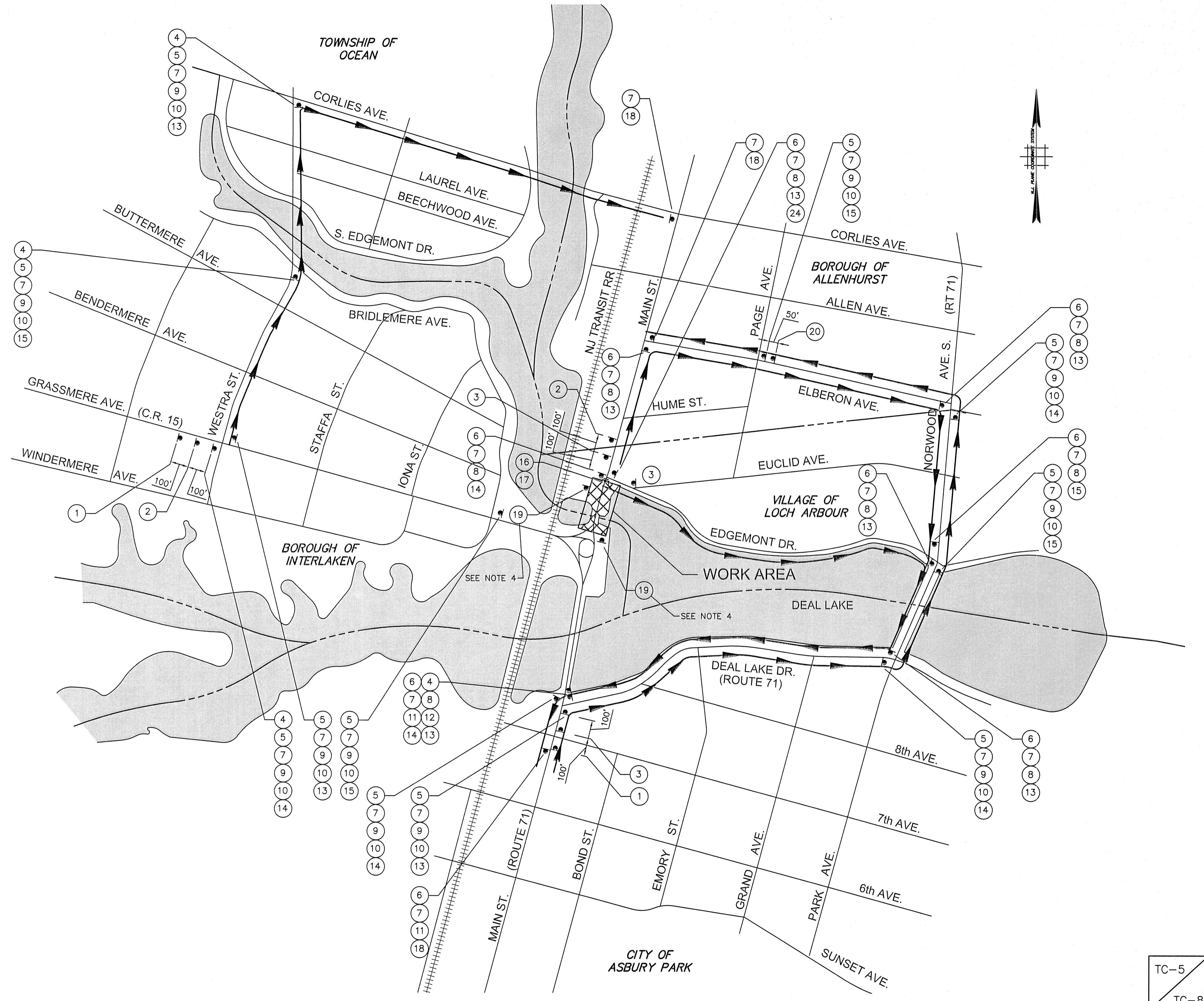

STAGE 1 AND 2  
DETOUR PLAN

DATE	AUTH.	BY	REVISIONS

**MONMOUTH COUNTY ENGINEERING**

TRAFFIC CONTROL & STAGING PLANS  
COUNTY BRIDGE O-11  
MAIN STREET OVER DEAL LAKE  
AND CRAWFORD CIRCLE IMPROVEMENTS  
BOROUGH OF INTERLAKEN  
VILLAGE OF LOCH ARBOUR  
LAWRENCE M. DIFFLEY, P.E., P.T.O.E.  
NEW JERSEY PROFESSIONAL ENGINEER LICENSE NUMBER GE42159

DATE: 9/26/13

SCALE: 1" = 300'

DATE: SEPTEMBER 2013

Cherry, Weber & Associates  
MEMBER OF THE VAN CLEEF ENGINEERING GROUP  
FRENCHTOWN, NEW JERSEY

DRAWN BY: KW  
CHECK BY: LMD

SHEET 21 OF 64

FILE NAME: F:\PROJECTS\NJ-MN-X-107\0-11\DWG\TC05-STAGE 1.DWG  
LAYOUT: TC05  
PLOT DATE: 9/27/2013 11:33:12 AM