

TOWNSHIP OF MIDDLETOWN
COUNTY OF MONMOUTH

BOROUGH OF RED BANK
COUNTY OF MONMOUTH

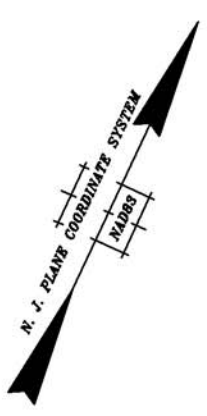
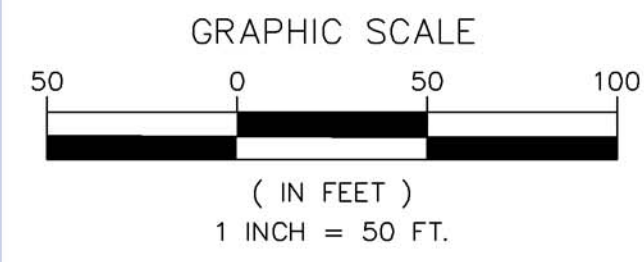

RECONSTRUCT
TRAFFIC SIGNAL
SEE NOTE 4

RECONSTRUCT
TRAFFIC SIGNAL
SEE NOTE 4

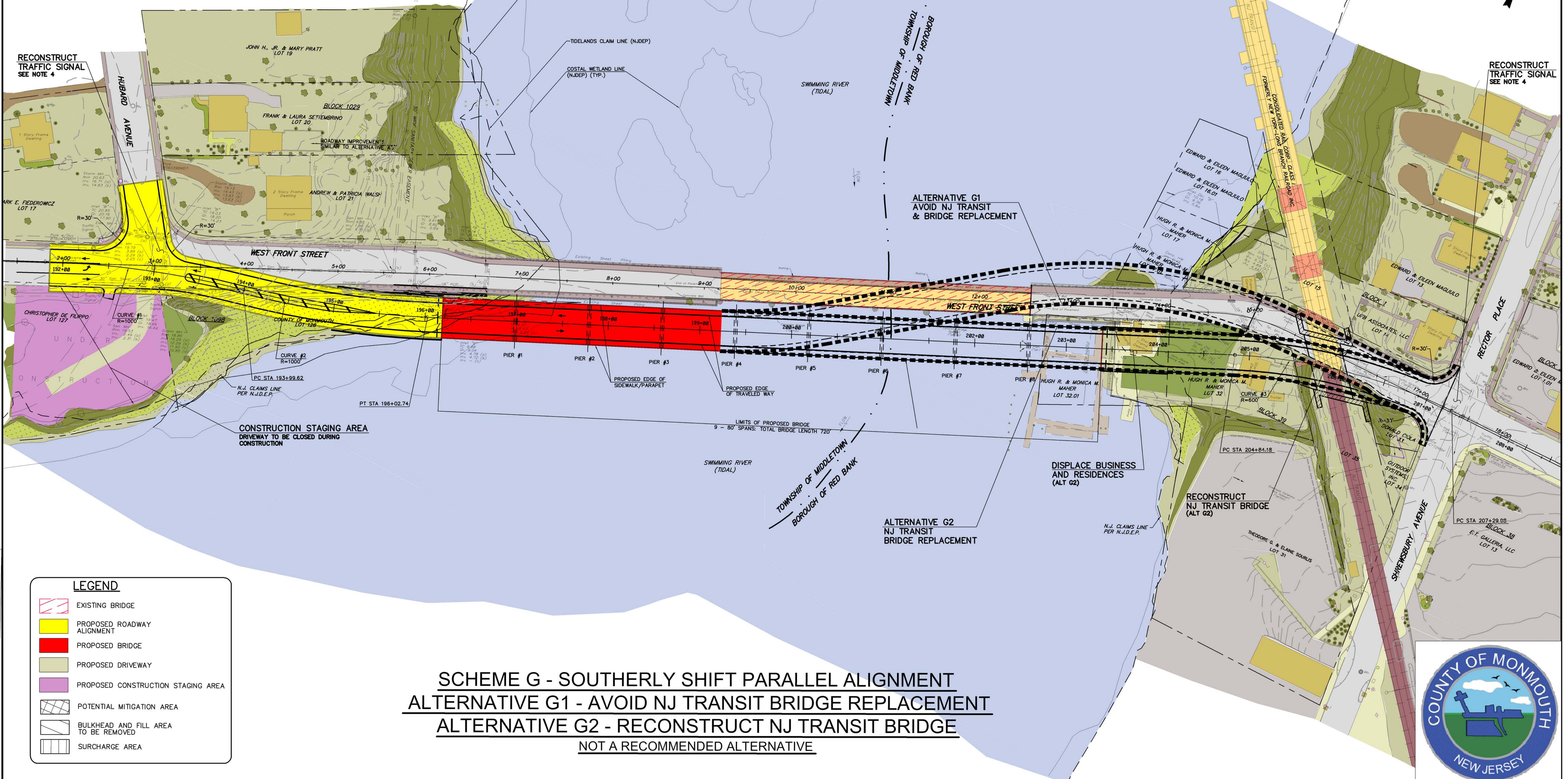

LEGEND

- EXISTING BRIDGE
- PROPOSED ROADWAY ALIGNMENT
- PROPOSED BRIDGE
- PROPOSED DRIVEWAY
- PROPOSED CONSTRUCTION STAGING AREA
- POTENTIAL MITIGATION AREA
- BULKHEAD AND FILL AREA TO BE REMOVED
- SURCHARGE AREA

SCHEME G - SOUTHERLY SHIFT PARALLEL ALIGNMENT
ALTERNATIVE G1 - AVOID NJ TRANSIT BRIDGE REPLACEMENT
ALTERNATIVE G2 - RECONSTRUCT NJ TRANSIT BRIDGE
NOT A RECOMMENDED ALTERNATIVE

- NOTES:
- EXISTING BRIDGE APPROACH TO REMAIN AND REGRADED WITH PAVER BLOCKS, DECORATIVE RAIL AND BENCHES. *OPTIONAL*
 - CONTOURS REPRESENTING RIVER BOTTOM ARE APPROXIMATE AND BASED ON CROSS SECTIONAL SOUNDINGS.
 - NAVIGATIONAL REQUIREMENTS TO BE COORDINATED WITH UNITED STATES COAST GUARD UNDER FINAL DESIGN AND SECURING OF PERMIT.
 - EXISTING TRAFFIC SIGNAL TO BE UPGRADED/REPLACED. INTERSECTION TO MILLED, RESURFACED AND RESTRIPEDED.

NUMBER	DATE	REVISION

FRENCH & PARRELLO
ASSOCIATES P.A. CONSULTING ENGINEERS
 1800 Route 34, Suite 101 • Wall, NJ • 07719 • 732 312-9800

MICHAEL TRONCONE, P.E.
 NEW JERSEY PROFESSIONAL ENGINEER LIC. NO. 442019

ALTERNATIVE PLAN
 SCOPING STUDY FOR IMPROVEMENTS TO
 MONMOUTH COUNTY
 C.R. 10, WEST FRONT STREET
 OVER SWIMMING RIVER

BOROUGH OF RED BANK TOWNSHIP OF MIDDLETOWN
 MONMOUTH COUNTY NEW JERSEY

DATE: APRIL, 2008 SCALE: AS NOTED PROJECT NUMBER: 007007
 DRAWN BY: T.D.L. DESIGNED BY: M.T. SHEET: OF X

