

TOWNSHIP OF MIDDLETOWN
COUNTY OF MONMOUTH

BOROUGH OF RED BANK
COUNTY OF MONMOUTH

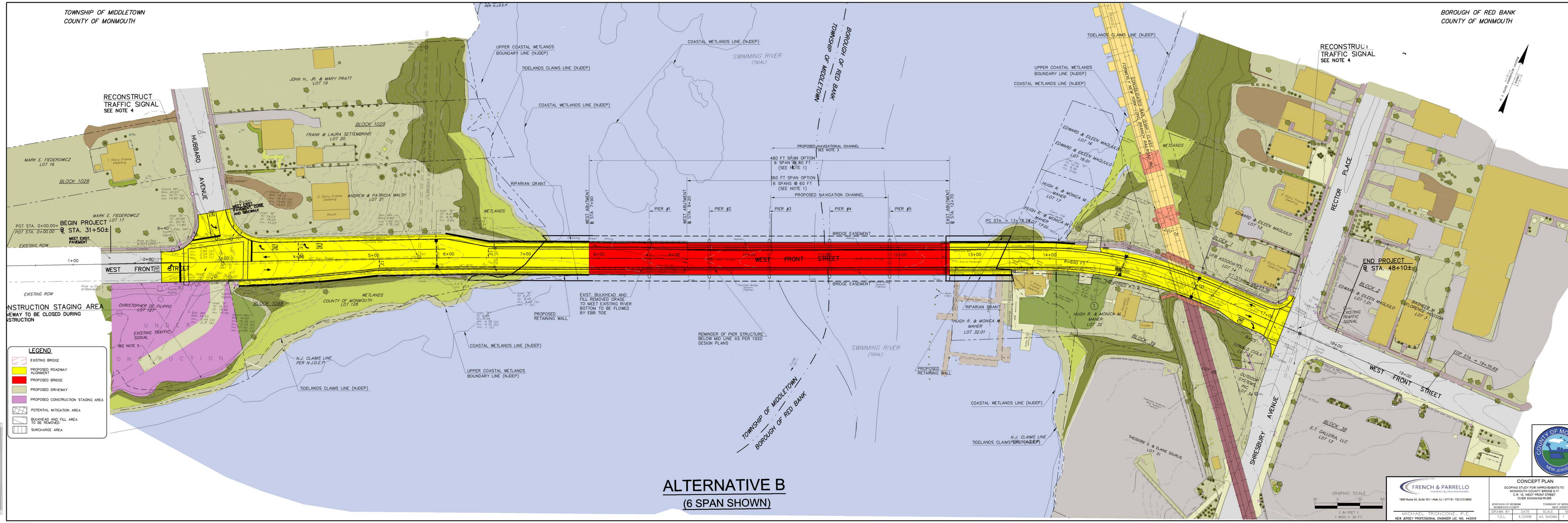

RECONSTRUCT
TRAFFIC SIGNAL
SEE NOTE 4

END PROJECT
@ STA. 48+10±

ALTERNATIVE B (6 SPAN SHOWN)

GRAPHIC SCALE
1" = 30'

FRENCH & PARRELLO
INCORPORATED
1888 Route 30, Suite 101 - Pine, NJ 07713-1203-0000
MICHAEL TRONCONE, P.E.
NEW JERSEY PROFESSIONAL ENGINEER NO. 442819

CONCEPT PLAN
SCOPING STUDY FOR IMPROVEMENTS TO
MONMOUTH COUNTY BRIDGE 642
C.B. 10 WEST FRONT STREET
OVER SWIMMING RIVER
BOROUGH OF RED BANK
MONMOUTH COUNTY
TOWNSHIP OF MIDDLETOWN
NEW JERSEY
DEPART BY DATE SCALE SHEET
1.0.1 4/20/08 45' SPANS 1 OF 1

© 2008 FRENCH & PARRELLO ASSOCIATES, P.A. - ALL RIGHTS RESERVED. THE COPY OR REUSE OF THIS DOCUMENT OR PORTIONS THEREOF WITHOUT THE WRITTEN PERMISSION OF FRENCH & PARRELLO ASSOCIATES, P.A. IS PROHIBITED. DUE TO CURRENT ERRORS IN REPRODUCTION METHODS, ERRORS MAY OCCUR WHEN SCALING THIS DRAWING.