

TOWNSHIP OF MIDDLETOWN  
COUNTY OF MONMOUTH

BOROUGH OF RED BANK  
COUNTY OF MONMOUTH

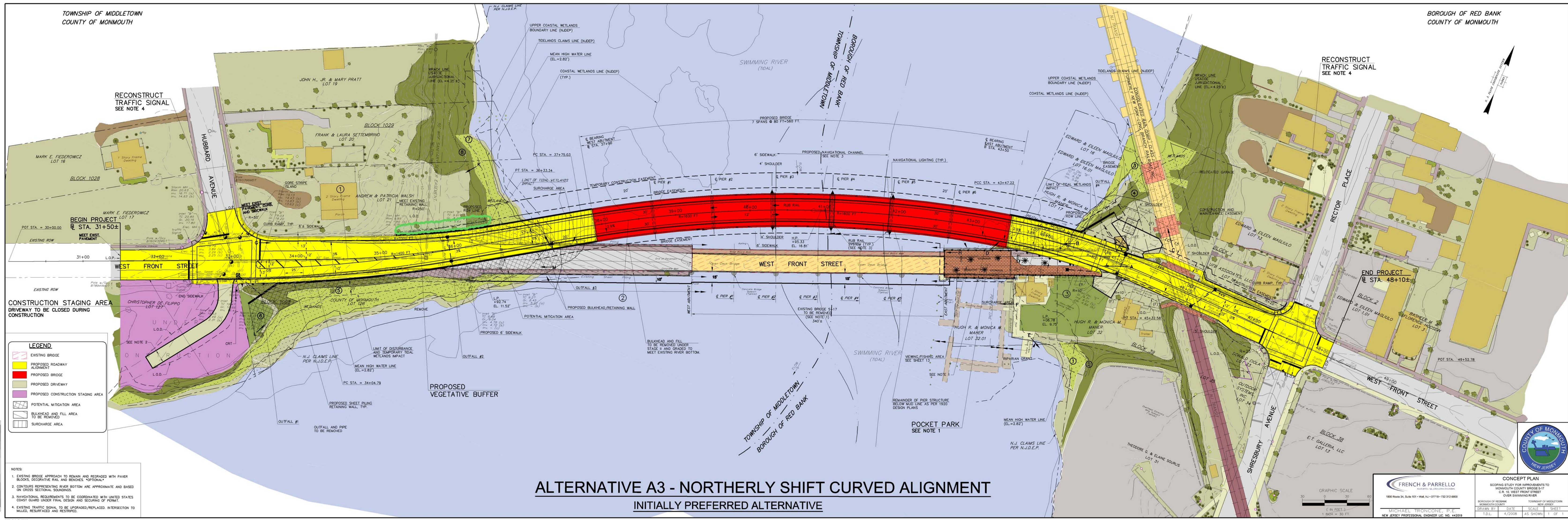

**ALTERNATIVE A3 - NORTHERLY SHIFT CURVED ALIGNMENT**  
INITIALLY PREFERRED ALTERNATIVE

- LEGEND**
- [Symbol] EXISTING BRIDGE
  - [Symbol] PROPOSED ROADWAY ALIGNMENT
  - [Symbol] PROPOSED BRIDGE
  - [Symbol] PROPOSED DRIVEWAY
  - [Symbol] PROPOSED CONSTRUCTION STAGING AREA
  - [Symbol] POTENTIAL MITIGATION AREA
  - [Symbol] BULKHEAD AND FILL AREA TO BE REMOVED
  - [Symbol] SURCHARGE AREA
- NOTES:**
1. EXISTING BRIDGE APPROACH TO REMAIN AND REGRADED WITH PAVER BLOCKS TO IMPROVE DRAINAGE AND REMOVE "HOTSPOTS"
  2. CONTOURS REPRESENTING RIVER BOTTOM ARE APPROXIMATE AND BASED ON CROSS SECTIONAL SOUNDINGS
  3. NAVIGATIONAL REQUIREMENTS TO BE COORDINATED WITH UNITED STATES COAST GUARD UNDER FINAL DESIGN AND SECURING OF PERMIT
  4. EXISTING TRAFFIC SIGNAL TO BE UPGRADED/REPLACED INTERSECTION TO ALL-RED, RESURFACED AND RESTRAINED

**FRENCH & PARRELLO**  
INCORPORATED  
1888 Route 30, Suite 101 • PO Box 411 • 70719 • 732-512-8888

**CONCEPT PLAN**  
SCOPING STUDY FOR IMPROVEMENTS TO  
MONMOUTH COUNTY BRIDGE 6-12  
C.B. 10 WEST FRONT STREET  
OVER SWIMMING RIVER

**MICHAEL TRONCONI, P.E.**  
NEW JERSEY PROFESSIONAL ENGINEER LIC. NO. 442819

**COUNTY OF MONMOUTH**  
NEW JERSEY

GRAPHIC SCALE  
0 10 20  
[Symbol] (IN FEET)  
1:5000 = 30'-0"

DATE: 4/20/24  
SCALE: AS SHOWN  
SHEET: 1 OF 1

PROJECT 2024  
FRENCH & PARRELLO ASSOCIATES, P.A. - ALL RIGHTS RESERVED. THE CONTENT OR USE OF THIS DOCUMENT OR PORTIONS THEREOF WITHOUT THE WRITTEN PERMISSION OF FRENCH & PARRELLO ASSOCIATES, P.A. IS PROHIBITED. DUE TO CURRENT ERRORS IN REPRODUCTION METHODS, ERRORS MAY OCCUR WHEN SCALING THIS DRAWING.