

TOWNSHIP OF MIDDLETOWN
COUNTY OF MONMOUTH

BOROUGH OF RED BANK
COUNTY OF MONMOUTH

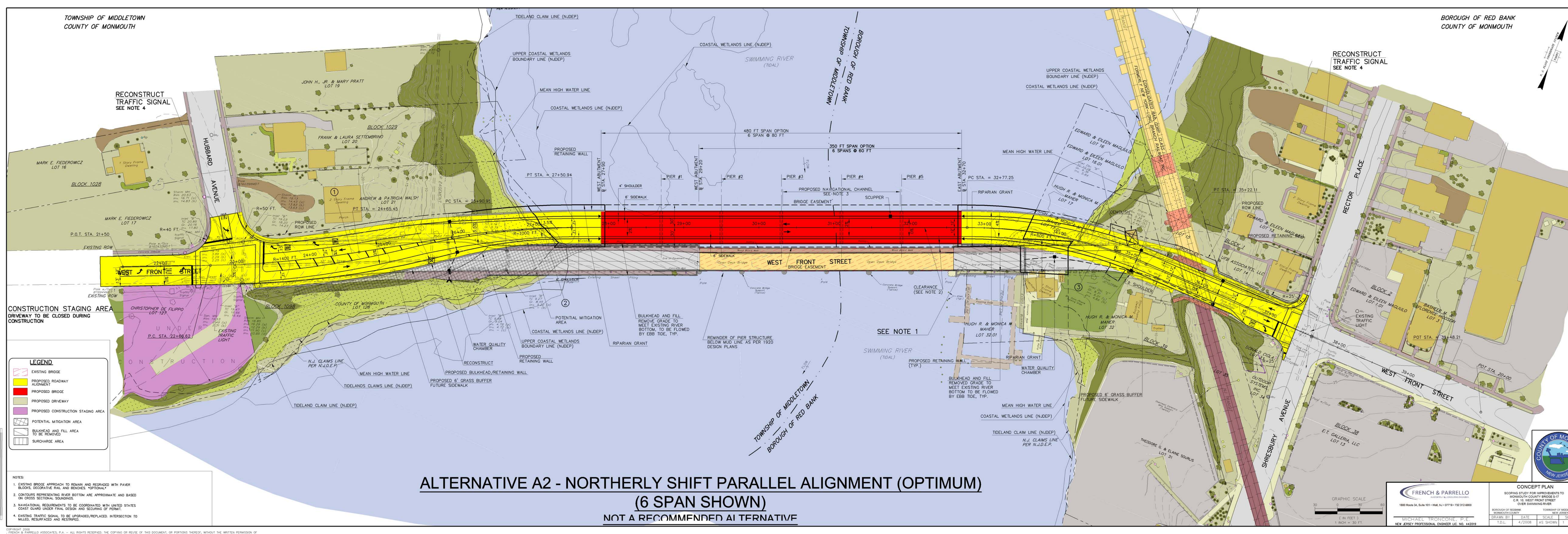

CONSTRUCTION STAGING AREA
DRIVEWAY TO BE CLOSED DURING
CONSTRUCTION

LEGEND

- EXISTING BRIDGE
- PROPOSED ROADWAY ALIGNMENT
- PROPOSED BRIDGE
- PROPOSED DRIVEWAY
- PROPOSED CONSTRUCTION STAGING AREA
- POTENTIAL MITIGATION AREA
- BULKHEAD AND FILL AREA TO BE REMOVED
- SURCHARGE AREA

- NOTES:**
1. EXISTING BRIDGE APPROACH TO REMAIN AND RESEGREG WITH PAVEMENT SURCHARGE FILL AND REINFORCE OPTIMUM
 2. CONTOURS REPRESENTING RIVER BOTTOM ARE APPROXIMATE AND BASED ON CROSS SECTIONAL SOUNDINGS
 3. NAVIGATIONAL REQUIREMENTS TO BE COORDINATED WITH UNITED STATES COAST GUARD UNDER FINAL DESIGN AND SECURING OF PERMIT
 4. EXISTING TRAFFIC SIGNAL TO BE UPGRADED/REPLACED, INTERSECTION TO BE RECONSTRUCTED AND RESTORED

ALTERNATIVE A2 - NORTHERLY SHIFT PARALLEL ALIGNMENT (OPTIMUM)
(6 SPAN SHOWN)
NOT A RECOMMENDED ALTERNATIVE

 FRENCH & PARRELLO <small>INCORPORATED IN NEW JERSEY</small>		CONCEPT PLAN SCOPING STUDY FOR IMPROVEMENTS TO MONMOUTH COUNTY BRIDGE #10 C.B. 10 WEST FRONT STREET OVER SWIMMING RIVER
1888 Route 30, Suite 101 • P.O. Box 41 • 07718-0041 MICHAEL TRONCONE, P.E. NEW JERSEY PROFESSIONAL ENGINEER LIC. NO. 44289	BOROUGH OF RED BANK MONMOUTH COUNTY TOWNSHIP OF MIDDLETOWN NEW JERSEY DRAWN BY: DATE: SCALE: SHEET: T.S.L. 4/20/08 AS SHOWN 1 OF 1	GRAPHIC SCALE 1" = 30'-0" (IN FEET) 1" = 30'-0"