

TOWNSHIP OF MIDDLETOWN
COUNTY OF MONMOUTH

BOROUGH OF RED BANK
COUNTY OF MONMOUTH

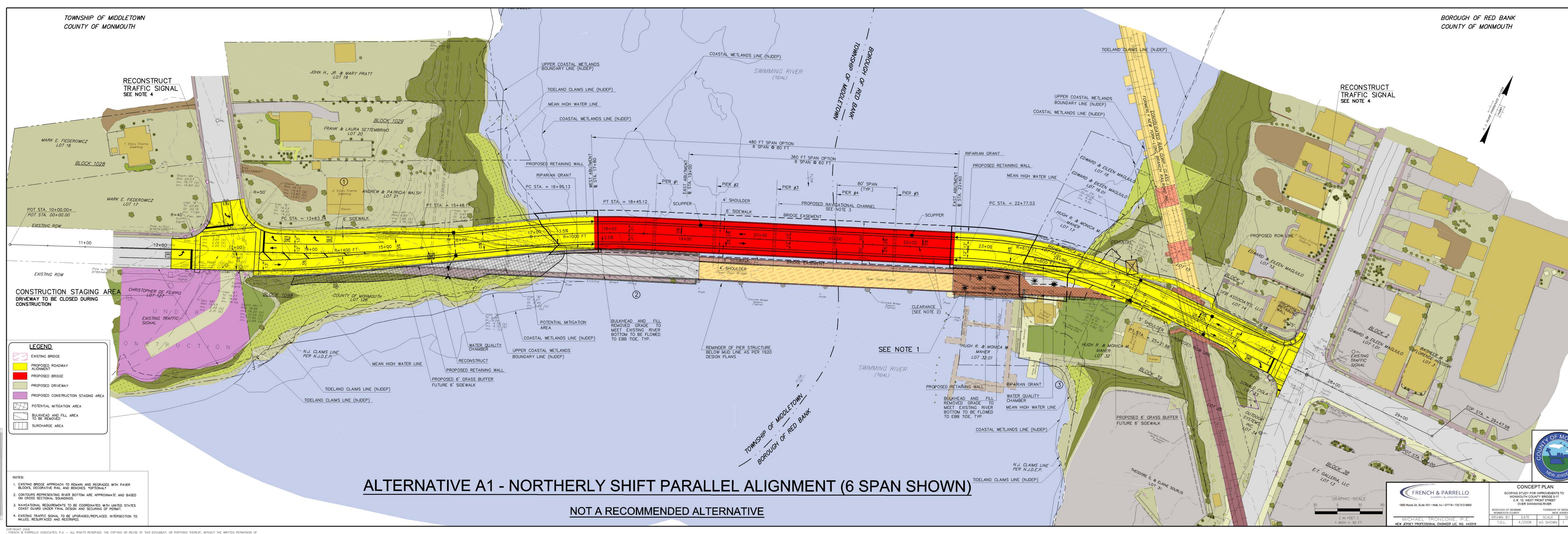

ALTERNATIVE A1 - NORTHERLY SHIFT PARALLEL ALIGNMENT (6 SPAN SHOWN)

NOT A RECOMMENDED ALTERNATIVE

- LEGEND**
- EXISTING BRIDGE
 - PROPOSED ROADWAY ALIGNMENT
 - PROPOSED BRIDGE
 - PROPOSED DRIVEWAY
 - PROPOSED CONSTRUCTION STAGING AREA
 - POTENTIAL MITIGATION AREA
 - BULKHEAD AND FILL AREA TO BE REMOVED
 - SURCHARGE AREA

- NOTES:**
1. EXISTING BRIDGE APPROACH TO REMAIN AND REGRADED WITH PAVER BLOCKS DISCRETE FILL AND REMOVED "OPTIONAL"
 2. CONTOURS REPRESENTING RIVER BOTTOM ARE APPROXIMATE AND BASED ON CROSS SECTIONAL SOUNDINGS
 3. NAVIGATIONAL REQUIREMENTS TO BE COORDINATED WITH UNITED STATES COAST GUARD UNDER FINAL DESIGN AND SECURING OF PERMIT
 4. EXISTING TRAFFIC SIGNAL TO BE UPGRADED/REPLACED INTERSECTION TO BE RECONSTRUCTED AND RESTORED

FRENCH & PARRELLO
INCORPORATED
1888 Route 30, Suite 101 - Pine, NJ 07713-1303-0000
MICHAEL TRONCONE, P.E.
NEW JERSEY PROFESSIONAL ENGINEER LIC. NO. 44289

CONCEPT PLAN
SCOPING STUDY FOR IMPROVEMENTS TO
MONMOUTH COUNTY BRIDGE 642
C.B. 10 WEST FRONT STREET
OVER SWIMMING RIVER

BOROUGH OF RED BANK
MONMOUTH COUNTY

TOWNSHIP OF MIDDLETOWN
MONMOUTH COUNTY

DATE: 4/20/24
SCALE: AS SHOWN
SHEET: 1 OF 1

GRAPHIC SCALE
0 10 20
(IN FEET)
1" EQUALS 30'-0"