

BOROUGH OF RUMSON
BOROUGH OF SEA BRIGHT

MONMOUTH COUNTY

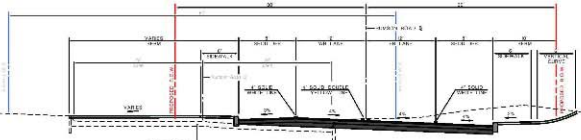

SECTION A-A
RUMSON ROAD
TOP TO SCALE

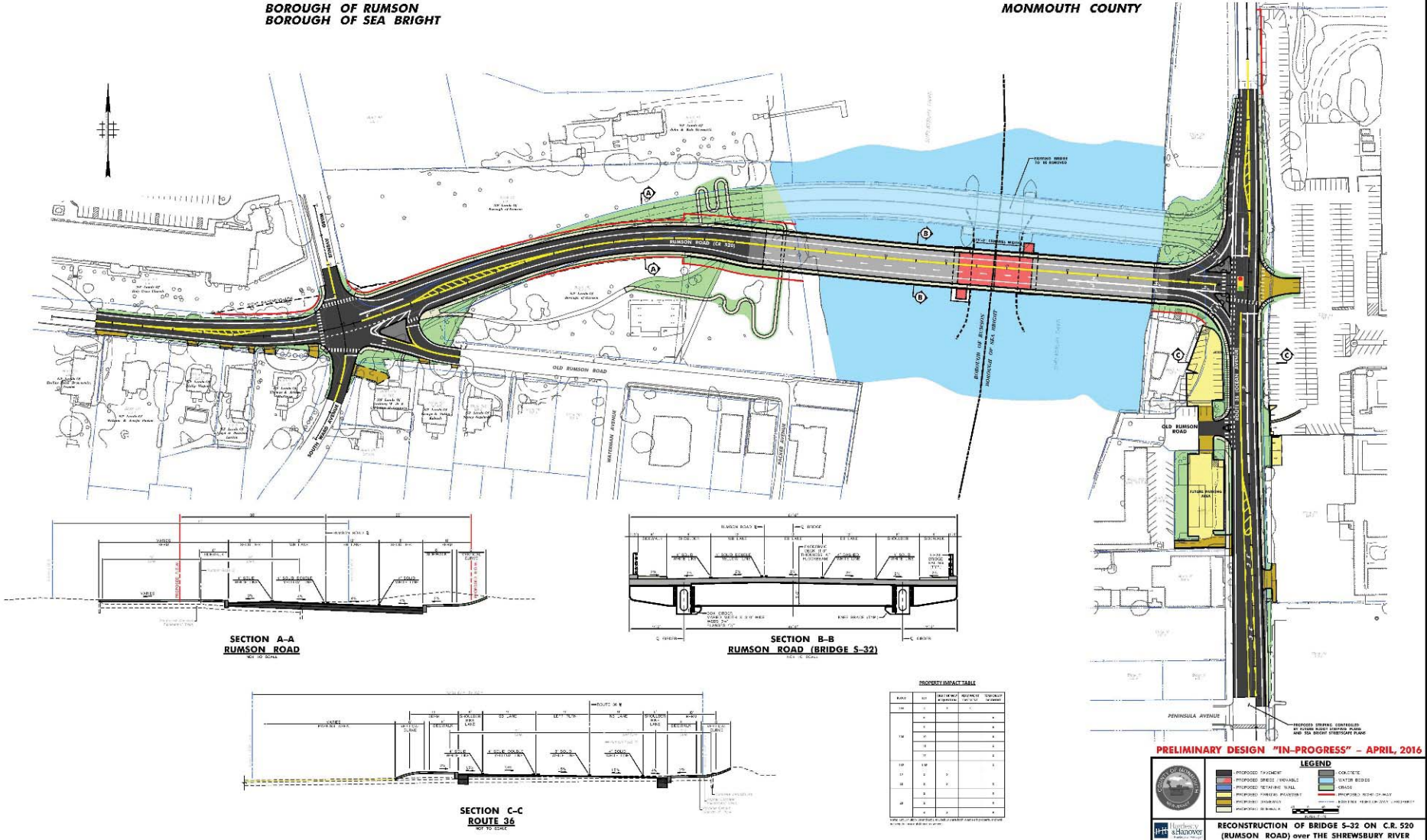
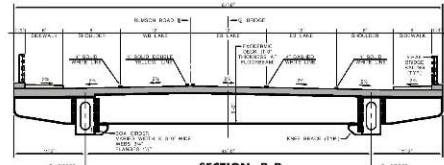

SECTION B-B
RUMSON ROAD (BRIDGE 5-32)
TOP TO SCALE

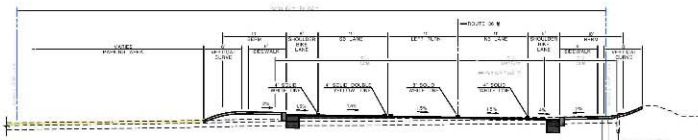

SECTION C-C
ROUTE 36
TOP TO SCALE

PROPERTY IMPACT TABLE

NO.	OWNER	ADJACENT PROPERTY	ADJACENT PROPERTY	ADJACENT PROPERTY	ADJACENT PROPERTY
1					
2					
3					
4					
5					
6					
7					
8					
9					
10					
11					
12					
13					
14					
15					
16					
17					
18					
19					
20					

PRELIMINARY DESIGN "IN-PROGRESS" - APRIL, 2016

LEGEND

- PROPOSED TYPED
- PROPOSED SPEED / INVALE
- PROPOSED RETAINING WALL
- PROPOSED FENCING / FENCE
- PROPOSED SIDEWALK
- PROPOSED DRIVEWAY
- EXISTING
- EXISTING WATER BRIDGE
- EXISTING CRUISE
- EXISTING SIDEWALK / DRIVEWAY
- EXISTING DRIVEWAY / DRIVEWAY

RECONSTRUCTION OF BRIDGE 5-32 ON C.R. 520 (RUMSON ROAD) over THE SHREWSBURY RIVER