

PLANT LIST

| Key | Botanical Name | Common Name | Qty. | Size |
|-----|--------------------------------|----------------------------------|--------|--------------|
| A | Rhus aromatica 'Gro-Low' | 'Grow-Low' Sumac | 19 | 3 gallon |
| B | Panicum 'Shenandoah' | 'Shenandoah' Switch Grass | 95 | 38 deep plug |
| C | Panicum 'Hanse Herms' | 'Hanse Herms' Switch Grass | 190 | 38 deep plug |
| D | Panicum 'Strictum' | 'Strictum' Switch Grass | 147 | 38 deep plug |
| E | Muhlenbergia capillaris | Muhly Grass | 51 | 38 deep plug |
| F | Sedum 'Autumn Joy' | 'Autumn Joy' Sedum | 53 | 38 deep plug |
| G | Echinacea pallida | Pale Purple Coneflower | 107 | 38 deep plug |
| H | Aster novae-angliae | New England Aster | 52 | 38 deep plug |
| I | Solidago rigida | Stiff-leaved Goldenrod | 55 | 38 deep plug |
| J1 | Iris germanica | Bearded Iris | 31 | 38 deep plug |
| J2 | Iris 'Butter & Sugar' | 'Butter & Sugar' Siberian Iris | 29 | 38 deep plug |
| J3 | Iris 'Caesar's Brother' | 'Caesar's Brother' Siberian Iris | 34 | 38 deep plug |
| K | Santolina chamaecyparissus | Lavender-cotton | 6 | 38 deep plug |
| L | Rudbeckia 'Goldsturm' | Black Eyed Susan | 113 | 38 deep plug |
| M | Achillea 'Appleblossom' | 'Appleblossom' Yarrow | 76 | 38 deep plug |
| N | Hemerocallis 'Happy Returns' | 'Happy Returns' Daylily | 60 | 38 deep plug |
| O | Veronica spicata | Spike Speedwell | 52 | 38 deep plug |
| P | Amsonia hubrechtii | Hubricht's Amsonia | 43 | 38 deep plug |
| Q | Eupatorium 'Little Joe' | 'Little Joe' Joe Pye Weed | 55 | 38 deep plug |
| R | Armeria maritima splendens | Sea Thrift | 28 | 38 deep plug |
| S | Leucanthemum 'Becky' | 'Becky' Shasta Daisy | 100 | 38 deep plug |
| T | Schizachyrium 'The Blues' | 'Little Blue' Stem | 90 | 38 deep plug |
| U | Panicum 'Heavy Metal' | 'Heavy Metal' Switch Grass | 77 | 38 deep plug |
| V | Vernonia noveboracensis | Ironweed | 40 | 38 deep plug |
| W1 | Salvia 'Snow Hill' | 'Snow Hill' Salvia | 34 | 38 deep plug |
| W2 | Salvia 'May Night' | 'May Night' Salvia | 16 | 38 deep plug |
| X | Eryngium 'Big Blue' | Sea Holly | 20 | 38 deep plug |
| Y | Echinops ritro | Small Globe Thistle | 35 | 38 deep plug |
| Z | Perovskia atriplicifolia | Russian Sage | 27 | 38 deep plug |
| AA | Viburnum dentatum | Arrowwood Viburnum | 14 | 3 gallon |
| BB | Prunus maritima | Beach Plum | 25 | 3 gallon |
| CC | Clethra 'Sixteen Candles' | 'Sixteen Candles' Clethra | 13 | 3 gallon |
| DD | Hydrangea 'Sister Theresa' | 'Sister Theresa' Hydrangea | 6 | 3 gallon |
| EE | Hydrangea 'Nikko Blue' | 'Nikko Blue' Hydrangea | 5 | 3 gallon |
| FF | Hydrangea 'Endless Summer' | 'Endless Summer' Hydrangea | 21 | 3 gallon |
| GG | Ilex verticillata 'Winter Red' | 'Winter Red' Winterberry Holly | 4 | 3 gallon |
| HH | Ilex verticillata 'Red Sprite' | 'Red Sprite' Winterberry Holly | 11 | 3 gallon |
| JJ | Itea virginica 'Little Henry' | 'Little Henry' Itea | 7 | 3 gallon |
| KK | Spiraea 'Shirobana' | 'Shirobana' Spiraea | 6 | 3 gallon |
| LL | Vitex agnus-castus | Chaste Tree | 2 | 5 gallon |
| LL | Myrica pensylvanica | Northern Bayberry | 24 | 3 gallon |
| PP | Existing tree to remain. | - | - | - |
| QQ | Existing grass to remain. | - | - | - |
| | Seeded Lawn | - | 22,000 | square feet |

NOTE:
PAVILION DRAWINGS ARE SHOWN FOR SITE PLANNING PURPOSES ONLY. STRUCTURAL INTEGRITY AND SUITABILITY FOR ITS INTENDED PURPOSE ARE THE RESPONSIBILITY OF THE DESIGNER AND FABRICATOR, THE BACKYARD SHOWCASE.

- GENERAL LANDSCAPE NOTES:**
- The Contractor shall protect from damage all existing pavements, utilities, structures, etc., and shall repair any damage resulting from the Contractor's operations at no cost to the Owner.
 - The Landscape Contractor shall provide continuous oversight of all landscaping activities by an experienced supervisor and shall be responsible for the means and methods of construction and for all safety precautions in connection with the work of this Contract.
 - All plant material shall conform to the standards of the American Association of Nurserymen: ANSI Z60.1-2014.
 - All plants are subject to inspection by the Landscape Architect in the nursery and at the project site prior to installation.
 - The placement of all new plants shall be approved by the Owner and Landscape Architect prior to final installation. The Contractor shall make whatever adjustments to plant locations that the Owner and Landscape Architect may require.
 - The Contractor shall inspect the subsoil when excavating the plant pits to determine whether the soil will support plant growth. If the Contractor determines that the soil is inadequate, he shall notify the Owner and the Landscape Architect prior to installing any plants. The Owner, Landscape Architect and Contractor shall agree upon remedial measures. No subsequent claims shall be allowed for plant growth problems arising from soil conditions or poor drainage unless this procedure is followed.
 - See written specification for fertilizer requirements.
 - Mulch all beds with two inches of double shredded hardwood bark.
 - No plant substitutions shall be allowed except if approved by the Owner and Landscape Architect.
 - The Contractor shall warrant all plant materials to be alive and growing for a period of one year following acceptance by the Owner. The Contractor shall maintain, water, prune, etc., all materials during the period of installation. Following acceptance of the work by the Owner, the Contractor shall visit the site periodically and inspect the quality of maintenance being provided by the Owner. If, in the Contractor's opinion, the Owner is providing inadequate maintenance, the Contractor shall notify the Owner and the Landscape Architect in writing of the conditions requiring attention. If the Owner does not correct the situation to the satisfaction of the Contractor and the Landscape Architect, the Contractor shall be relieved of warranty responsibilities for those specific plants and conditions. If the Contractor does not periodically inspect the Owner's maintenance he shall not subsequently be allowed to claim that plant failure was the result of the Owner's procedures.
 - Written quantities take precedence over graphic depiction.

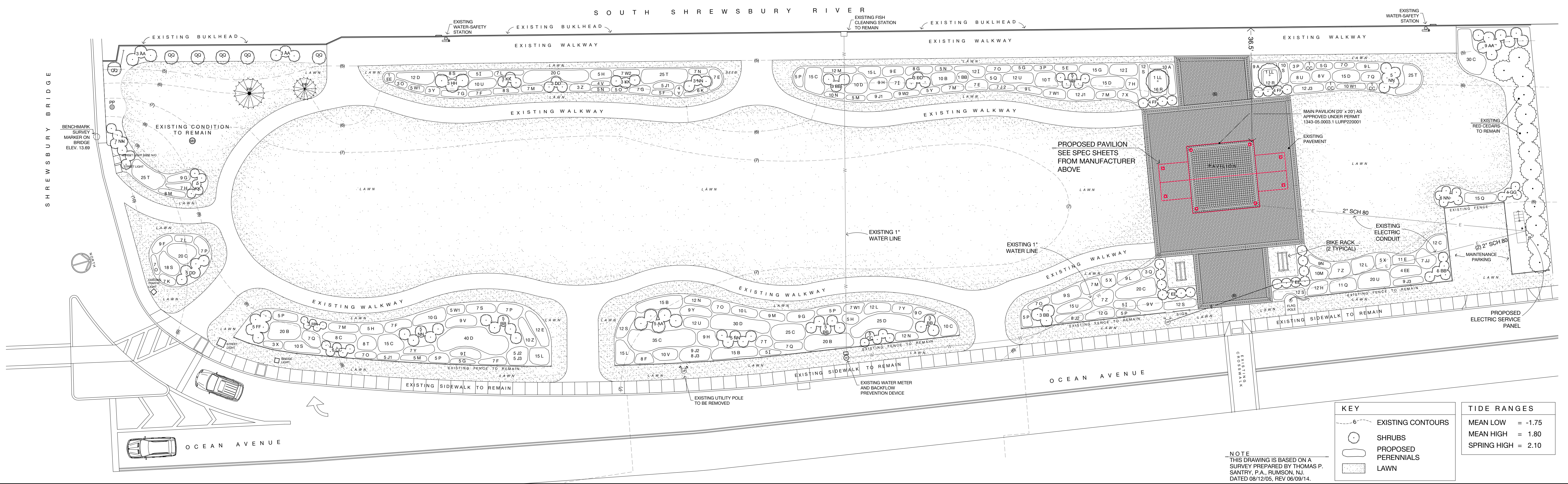
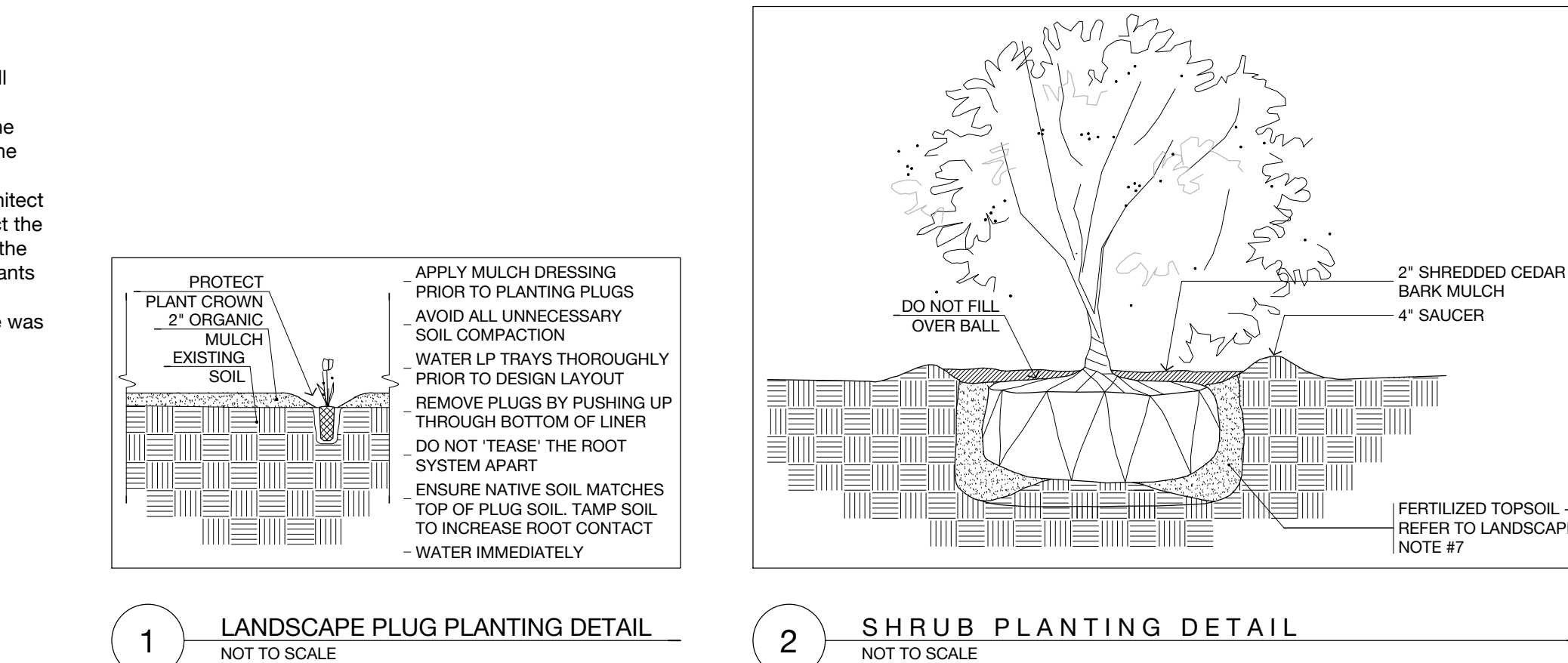

STEVEN R. KROG
LANDSCAPE ARCHITECT, P.C.

19 HARRIS PARK
RED BANK, NJ
07701

914.672.2581
www.stevenkrog.com

PRINTS NOT VALID WITHOUT ORIGINAL SIGNATURE AND SEAL

STEVEN R. KROG
LICENSED LANDSCAPE ARCHITECT
N.J. LICENSE #21AS-00031600

SHREWSBURY RIVERFRONT PARK
OCEAN AVENUE
SEA BRIGHT, NEW JERSEY

MARCH 15, 2022

SITE AND LANDSCAPING PLAN

SCALE: 1/16" = 1'-0"

DRAWN BY: PROJECT SHEET:
J.H./M.E. 2014-13 1 OF 1

L-1