

---

## **PAVED TRAIL REPAIRS FOR THE HENRY HUDSON TRAIL AND HOMINY HILL GOLF COURSE & PAVED TRAIL CONSTRUCTION FOR PINE BROOK GOLF COURSE 2013**

An overview of the work to be performed under each individual Contract shall include but will not be limited to the following construction operations:

• **PROPOSAL I – Henry Hudson Trail**

The Work shall include milling, HMA paving, striping and constructing concrete ramps. Entire scope of work is more fully described in the project documents. All work shall be completed within 30 calendar days commencing on the day next following the Contractor's receipt of the Notice to Proceed.

**PROPOSAL II – Hominy Hill Golf Course**

The Work shall include milling, repairing/reconstructing and HMA paving select cart path sections. Entire scope of work is more fully described in the project documents. All work shall be completed within 45 calendar days commencing on the day next following the Contractor's receipt of the Notice to Proceed.

**PROPOSAL III – Pine Brook Golf Course**

Work shall include milling where path meets road, parking lot, bridge or as needed to ensure continued stormwater drainage across path. Work includes HMA paving cart path sections at back nine holes of course as well as sections indicated at new crossing of Covered Bridge Blvd. Pave existing stone dust cart path and construct new cart paths sections with DGA base. Work includes root and branch pruning, concrete curbing, Belgian block curbing, linestriping and restoration. Entire scope of work is more fully described in the project documents. Note: Deliveries and work on-site shall not commence until September 9, 2013 and completed by October 23, 2013.

---

# PROPOSAL I

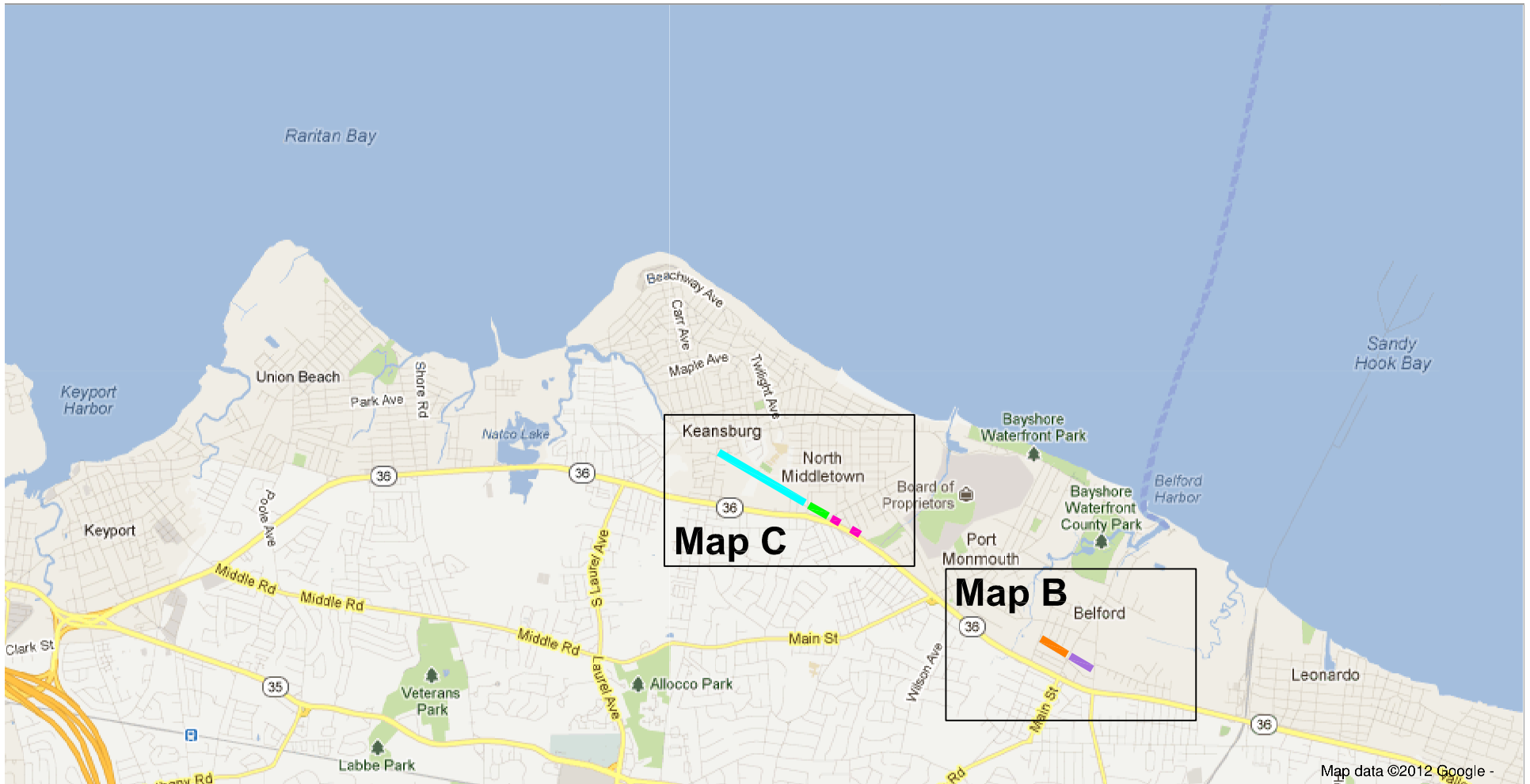

# Key Map A

## Henry Hudson Trail 2013 Resurfacing Project

**HENRY HUDSON TRAIL 2012 RESURFACING PROJECT  
BASE BID SECTIONS**

SECTION	Section Length *Linear Feet	Mill and Resurface 3" *Linear Feet	No Mill Overlay 1.5" *Linear Feet	Grass Shoulder (Note 5)	DGA Shoulder tons	Concrete Ramp	Estimated HMA I-5 tons
East Rd. to Main St. in Belford (See Note 2)	921 lf x 9'	306 lf x 9'	615 lf x 9'	819 sy	0	0	106 tons
Main St. to Chruch St. in Belford (See Note 3)	1042 lf x 9'	746 lf x 9'	296 lf x 9'	927 sy	0	0	155 tons
Bray Av. to Thompson Av. in Port Monmouth/Keansburg (See Note 4)	173 lf x 9' 172 lf x 9'	172 lf x 9' 173 lf x 9'	0	306 sy	0	0	60 tons
Thompson Av. to Atlantic Av. in Keansburg	619 lf x 9'	619 lf x 9'	0	0	46 tons	1	106 tons
Atlantic Ave. to Main St. in Keansburg	3,232 lf x 9'	3,232 lf x 9'	0	2,695 sy	15 tons	2	556 tons
Totals	6,159 lf x 9'	5,248 lf x 9'	911 lf x 9'	4,747 sy	61 tons	3	983 tons

\*Note:

- 1) Linear feet shall be measured along the centerline of the paved trail. Trail average width is 9 feet.  
Thickness of the existing asphalt pavement is approximately 3 inches.
- 2) Starting from East Rd.-Mill 15'-Overlay 84'-Mill 62'-Overlay 89'-Mill 178'-Overlay 73'-Mill 36'-Overlay 369'-Mill 15'-Main St.  
At 467 ft and 829.5 ft from East Rd. cut out 12 inches X 9ft width of the trail, compact base and install HMA I-5 prior to Overlay work.
- 3) Starting from Main St.-Mill 680'-Overlay 97'-Mill 50'-Overlay 199'-Mill 16'-Church St.
- 4) Starting from Thompson Av. Mill 173'.  
The other section starts at 764' from Thompson Av. - Mill 36'-Overlay 55'-Mill 81'.
- 5) The areas consist of an average of 4' on each side of the paved trail and an average of 2" depth
- 6) Where the milled section abuts a no mill section, mill a 15' long bevel from base to top of no mill pavement.
- 7) Root grubbing on milled sections.

# PROPOSAL II

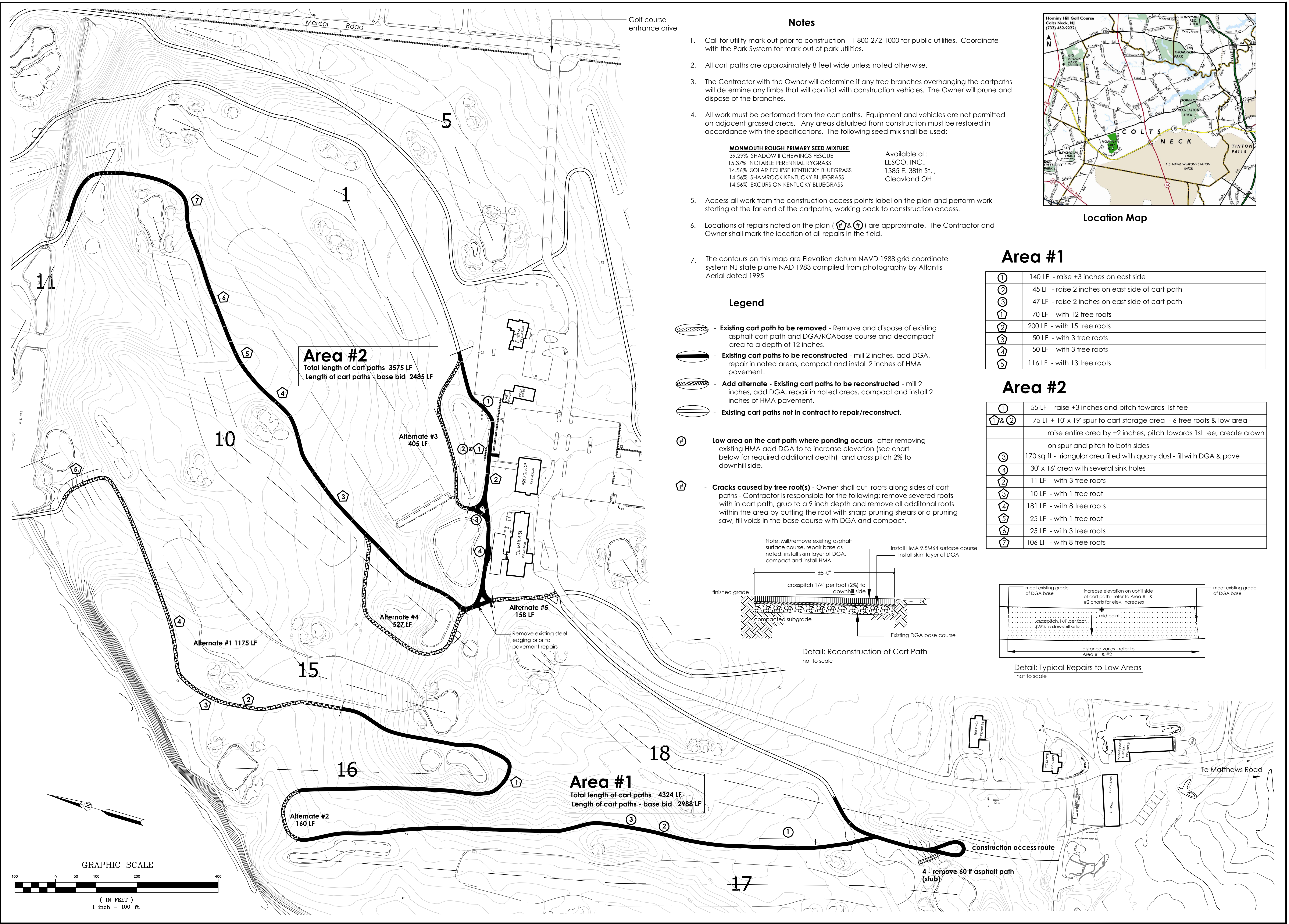

- ### Notes
1. Call for utility mark out prior to construction - 1-800-272-1000 for public utilities. Coordinate with the Park System for mark out of park utilities.
  2. All cart paths are approximately 8 feet wide unless noted otherwise.
  3. The Contractor with the Owner will determine if any tree branches overhanging the cartpaths will determine any limbs that will conflict with construction vehicles. The Owner will prune and dispose of the branches.
  4. All work must be performed from the cart paths. Equipment and vehicles are not permitted on adjacent grassed areas. Any areas disturbed from construction must be restored in accordance with the specifications. The following seed mix shall be used:
 

**MONMOUTH ROUGH PRIMARY SEED MIXTURE**  
 39.29% SHADOW II CHEWINGS FESCUE  
 15.37% NOTABLE PERENNIAL RYGRASS  
 14.56% SOLAR ECLIPSE KENTUCKY BLUEGRASS  
 14.56% SHAMROCK KENTUCKY BLUEGRASS  
 14.56% EXCURSION KENTUCKY BLUEGRASS

Available at:  
 LESCO, INC.,  
 1385 E. 38th St.,  
 Cleavland OH
  5. Access all work from the construction access points label on the plan and perform work starting at the far end of the cartpaths, working back to construction access.
  6. Locations of repairs noted on the plan (Ⓜ & Ⓝ) are approximate. The Contractor and Owner shall mark the location of all repairs in the field.
  7. The contours on this map are Elevation datum NAVD 1988 grid coordinate system NJ state plane NAD 1983 compiled from photography by Atlantis Aerial dated 1995

- ### Legend
- Existing cart path to be removed - Remove and dispose of existing asphalt cart path and DGA/RCA base course and compact area to a depth of 12 inches.
  - Existing cart paths to be reconstructed - mill 2 inches, add DGA, repair in noted areas, compact and install 2 inches of HMA pavement.
  - Add alternate - Existing cart paths to be reconstructed - mill 2 inches, add DGA, repair in noted areas, compact and install 2 inches of HMA pavement.
  - Existing cart paths not in contract to repair/reconstruct.
  - Low area on the cart path where ponding occurs - after removing existing HMA add DGA to increase elevation (see chart below for required additional depth) and cross pitch 2% to downhill side.
  - Cracks caused by tree root(s) - Owner shall cut roots along sides of cart paths - Contractor is responsible for the following: remove severed roots within in cart path, grub to a 9 inch depth and remove all additional roots within the area by cutting the root with sharp pruning shears or a pruning saw, fill voids in the base course with DGA and compact.

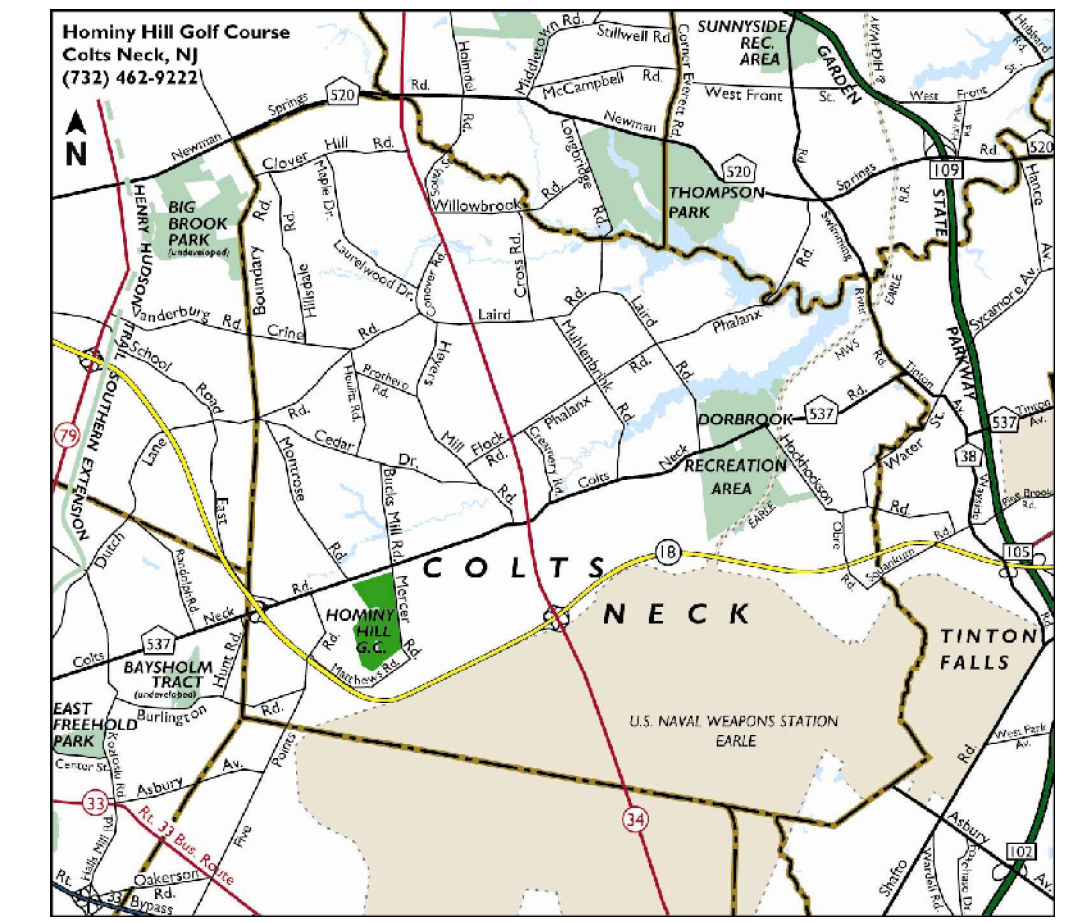
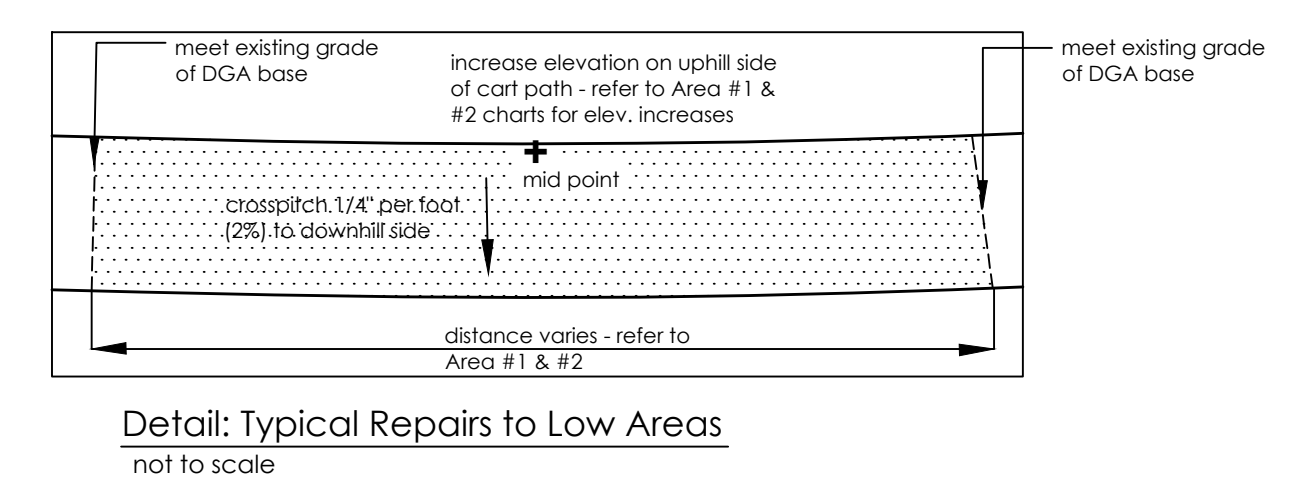
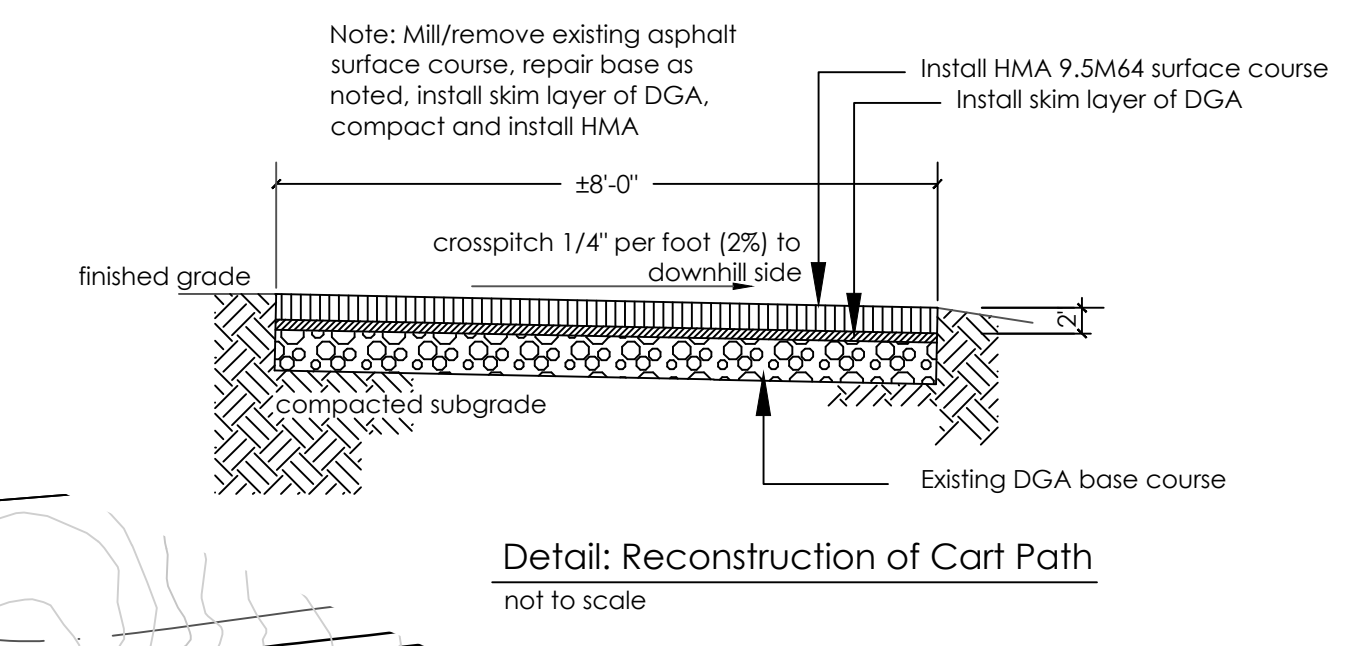

Location Map

### Area #1

①	140 LF - raise +3 inches on east side
②	45 LF - raise 2 inches on east side of cart path
③	47 LF - raise 2 inches on east side of cart path
④	70 LF - with 12 tree roots
⑤	200 LF - with 15 tree roots
⑥	50 LF - with 3 tree roots
⑦	50 LF - with 3 tree roots
⑧	116 LF - with 13 tree roots

### Area #2

①	55 LF - raise +3 inches and pitch towards 1st tee
②	75 LF + 10' x 19' spur to cart storage area - 6 tree roots & low area - raise entire area by +2 inches, pitch towards 1st tee, create crown on spur and pitch to both sides
③	170 sq ft - triangular area filled with quarry dust - fill with DGA & pave
④	30' x 16' area with several sink holes
⑤	11 LF - with 3 tree roots
⑥	10 LF - with 1 tree root
⑦	181 LF - with 8 tree roots
⑧	25 LF - with 1 tree root
⑨	25 LF - with 3 tree roots
⑩	106 LF - with 8 tree roots

CHECKED BY: \_\_\_\_\_ DATE: \_\_\_\_\_ REVISION: \_\_\_\_\_

MONMOUTH COUNTY PARK SYSTEM  
 BOARD OF PARK AND RECREATION COMMISSIONERS  
 805 NEWMAN SPRINGS ROAD  
 LINCOLN, NEW JERSEY 07738-1965  
 PHONE (732) 842-4000 FAX (732) 842-3640

Joseph V. Sardonis, C.I.A. NJ Lic. No. AS050561

PROJECT # 122103 DRAWN: RO CHECKED: JVS  
 DATE 10/01/12 SCALE shown PROJECT # 122103 DRAWN: RO CHECKED: JVS

Paved Trail Repairs  
 Hominy Hill Golf Course  
 Mercer Rd., Colts Neck, NJ

SHEET NO. 1  
 1 OF 1

# PROPOSAL III

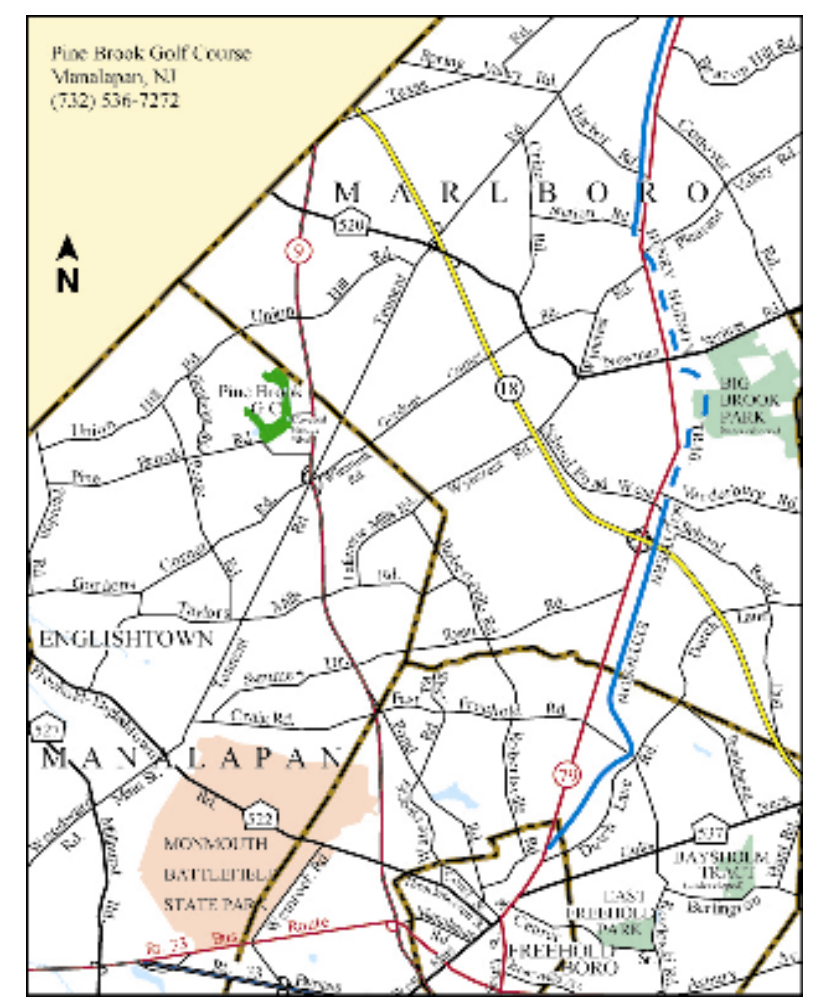
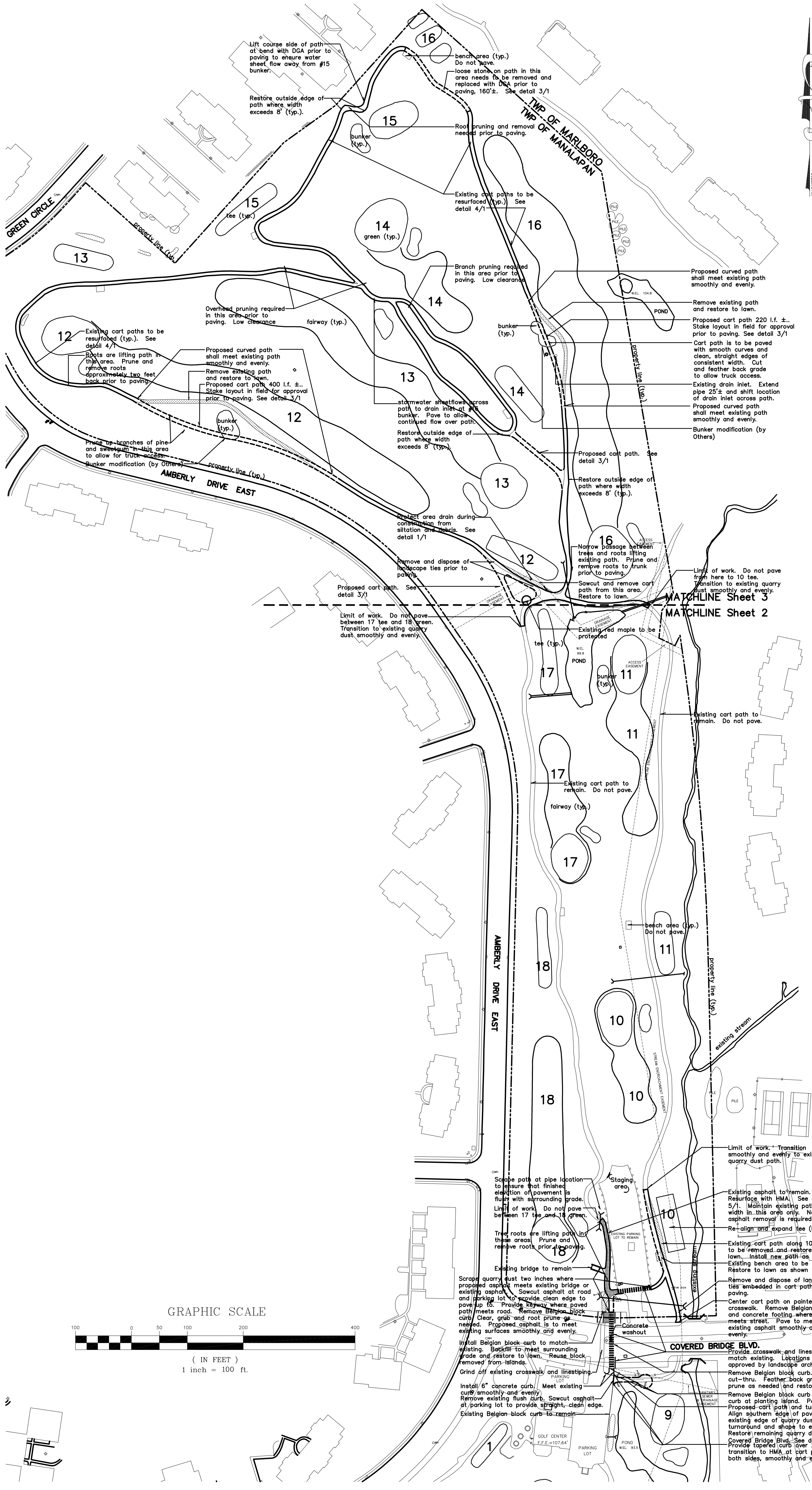

LOCATION MAP

**GENERAL NOTES**

- Base survey data obtained from Atlantis Aerial Survey Co., Inc., 295 Route 46, P.O. Box 276, Budd Lake, NJ 07828. Elevation datum N.A.V.D. 1988. Grid Coordinate System NJ State Plane NAD 1983. Compiled from photography dated 12-12-95.
- It is the intent of this contract that the golf course be disturbed as minimally as possible. Contractor shall access the site and perform all work from the cart paths without disturbing the remainder of the site, unless otherwise directed by the landscape architect. The contractor shall submit a work plan to the landscape architect for approval that shows work sequence and access routes for all work.
- Park System irrigation lines and utilities network the course and are shown schematically on the plans. The contractor shall review utility locations with the landscape architect prior to site disturbance.
- Public utility locations shown on plans are schematic. Prior to land disturbance the contractor shall contact the Board of Public Utilities for a markout of the underground utilities as per Public Law 1994; Chapter 118. The telephone number is 800.272.1000.
- All cart path realignment is to be approved in the field by the landscape architect prior to construction. Grades and layout will be altered as necessary to save existing vegetation and to ensure positive drainage off of all paved surfaces.
- Existing cart path width shown on plan is schematic only. Width of existing path varies throughout the course between approximately six feet and fifteen feet. Existing quarry dust paths eight feet or wider will require restoration along sides of path. Existing quarry dust paths eight feet or narrower will require additional pavement and base treatment along sides of path.
- Access for paver vehicle is limited in some areas of the course due to narrow passageways between trees, low branches, bridges and underground utilities. Contractor must provide alternate paving methods in these areas that meet the approval of the Park System representative.

Primary rough Seed Mix:  
 40% Zodiac Chewings Fescue  
 15% Solar Eclipse Kentucky Bluegrass  
 15% Blue Note Kentucky Bluegrass  
 15% Bluestone Kentucky Bluegrass  
 15% Homerun Perennial Ryegrass

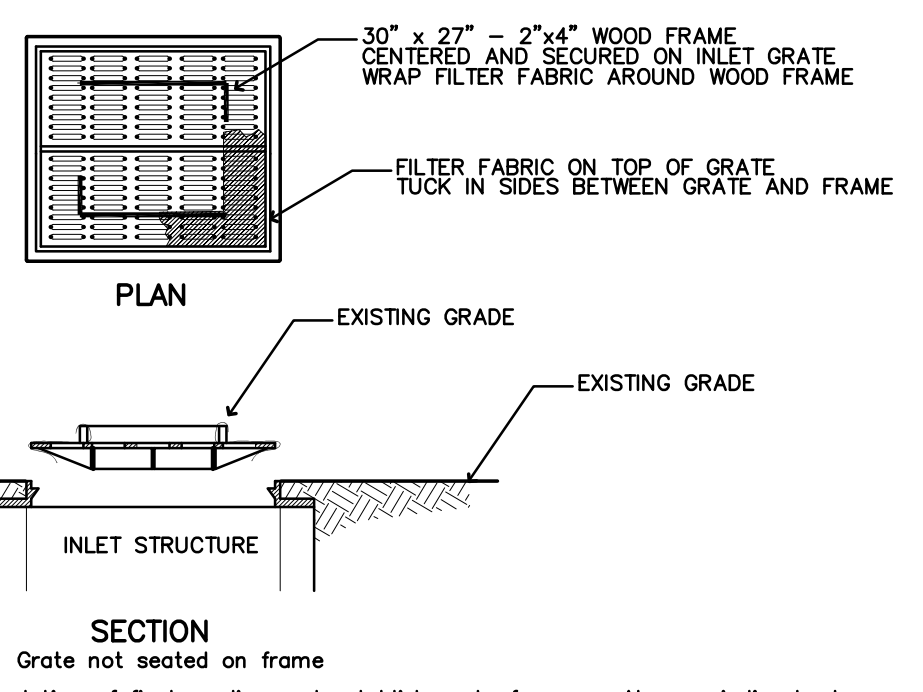
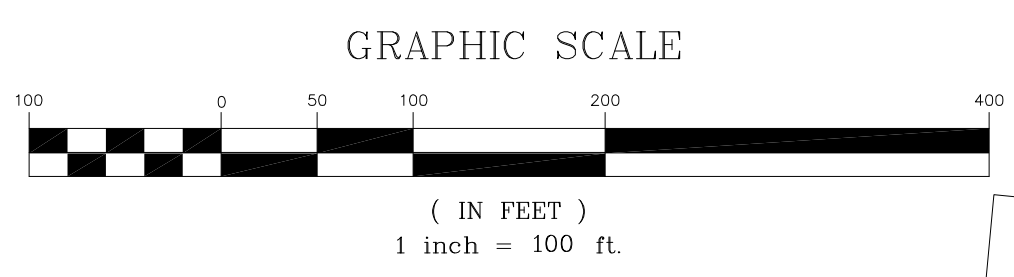

**Area Drain Protection Measures**  
 not to scale

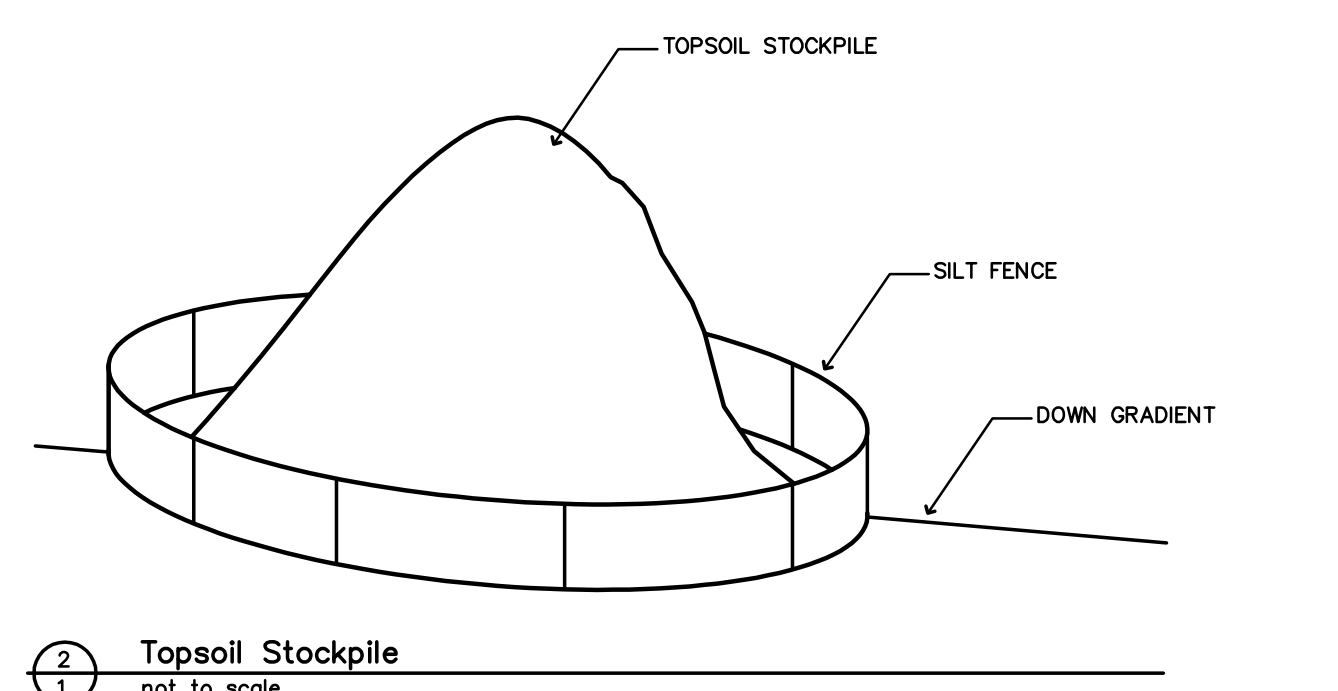

**Topsoil Stockpile**  
 not to scale

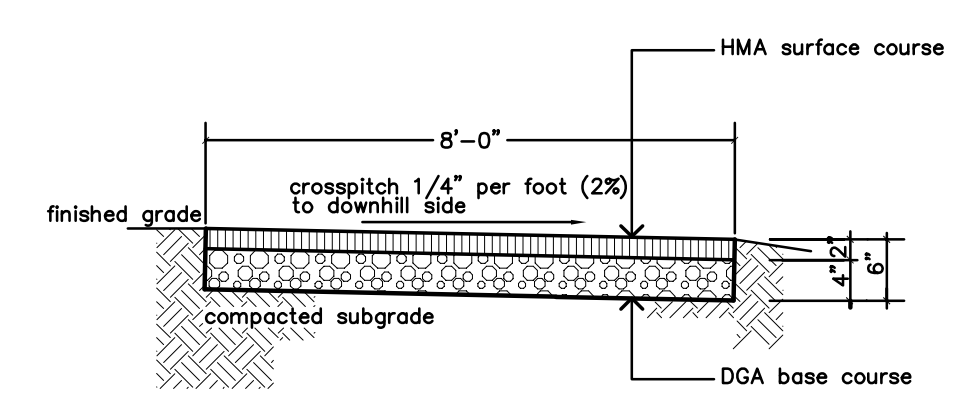

**Proposed Cart Path Detail**  
 not to scale

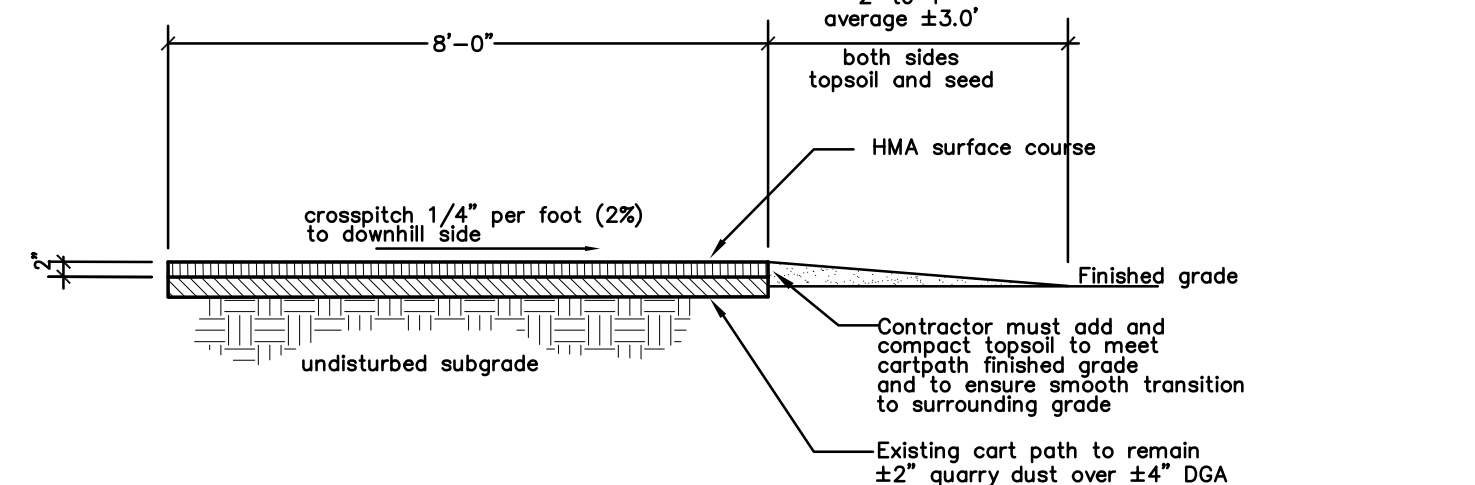

**Paving Over Quarry Dust Detail**  
 not to scale

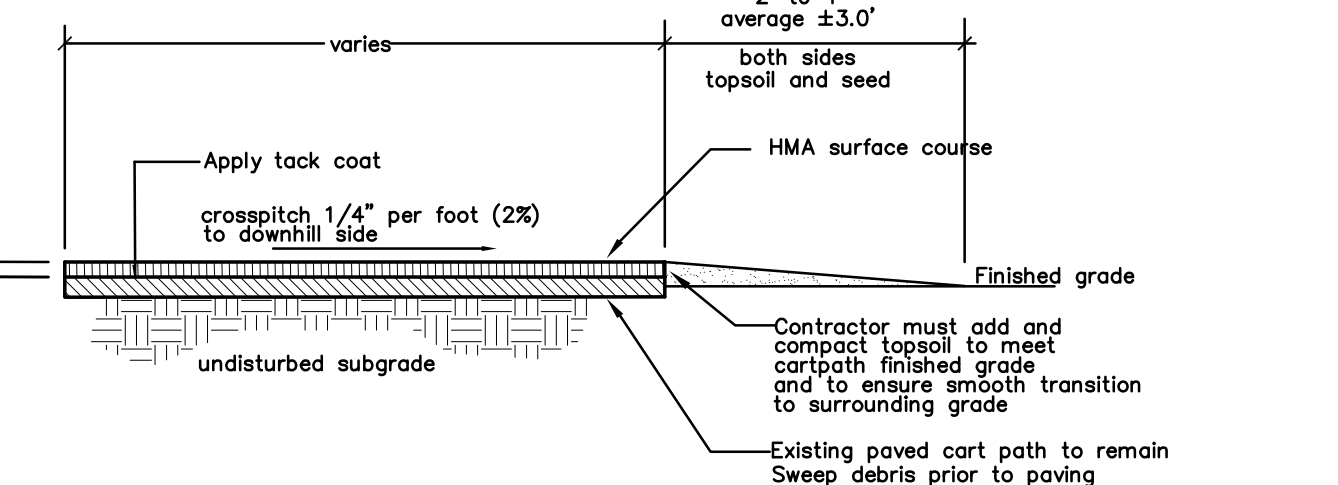

**Paving Over Asphalt Detail**  
 not to scale