

# Green Link



An Employee & Volunteer Newsletter of the Monmouth County Park System

March/April 2009

## PHOTOS, PHOTOS, PHOTOS! PARK EMPLOYEES GET RECOGNIZED

Better late than never! It's been almost 6 months since the Annual Employee Recognition Program, and we just now have enough space in the Green Link to give this year's annual ceremony the coverage it deserves. But first, a little history...the Park System has been giving out pins to acknowledge years of service for as long as anyone can remember (at least 30 years), but the achievement award portion of this event is relatively new, started in 2006. Recipients are selected from nominations submitted by their fellow employees, and sometimes whole divisions, rather than individuals, win an award. Finally, since photos provide a great opportunity for staff to get to know each other better, we'll let these pictures do the talking...



**Employees Celebrating a Milestone Anniversary 5 Years** (front row, l to r): Shark River Golf Course Ranger Eric Wetherbee; Chief Landscape Architect Rich Pillar; Graphic Artist Joanne Jubert; Betty Leong of Administration at Dorbrook Activity Center; and Claire Morris, Recreation Program Specialist at Sunnyside Equestrian Center. (back row, l to r): Jeff Faistl, Greenskeeper, Hominy Hill Golf Course; Manasquan Reservoir Ranger Patrick Becker, Turkey Swamp Park Ranger Mike Towle; Urban Recreation Supervisor Courtney Bison; Jacques DiPane of Thompson Park Maintenance; and Public Information Officer Susan Walsh. Not pictured: Jan Galanti, Wayne Connolly, John Skimelis, Nick Samaras, Jeff Semanchick, Greg Sharin and Tim LaVance.



**10 Years** (front row, l to r): Golf Ranger Peter Kucker of Shark River Golf Course; Pat Douglas of Reservations; and Senior Park Ranger at Sunnyside Andy Spears. (back row, l to r): Charleston Springs South Golf Superintendent Dave Mishkin; Troy Schinzel, formerly a Senior Park Manager at Thompson Park (Troy recently moved to the county's Public Works Department); Senior Park Ranger Nick Podsvirow of Dorbrook; and Charlie Todd, a Senior Gardener at Deep Cut Gardens. Not pictured: Paul DeJesus, Tom Petraglia, Mike Vaccaro, and Anne Reinhardt.

**15 Years** (l to r): Senior Landscape Architect Laura Lieneck; Park System Safety Officer Brian Corrigan; and Barbara Urbinato, Receptionist at Thompson Park Administration. Not pictured: Betty Fish.



**STATISTICS CORNER** Did you know? When an old park building undergoes renovation, about 30% of the work is actually site-related; that is, preparing and upgrading the utilities. Replacing sewer and water lines and modernizing electrical systems, for instance, take a great deal of time, money and effort. For a really old building like the Seabrook-Wilson House (the oldest in the Park System, built in the early 1700s) this number may actually approach 35%.

Continued on page 2

# DIRECTOR'S CORNER



## **“CAPRA”**

As you may recall, in November of this past year we hosted a three-member visitation team responsible for making recommendations to the

National “Commission for Accreditation of Park and Recreation Agencies” (CAPRA). In order to maintain our accreditation, the Commission requires that a visitation team inspect our facilities and offices every five years to verify that we are still meeting the CAPRA standards. The team is responsible for validating our continued compliance and noting any changes in the progress of our agency. Their fact-finding report to the Commission is the basis for the Commission granting our continued accreditation, expected sometime in March.

Our Park System has been an accredited park and recreation agency since 1994. My sincere thanks to Faith Hahn who led our effort and to each and every one of you who worked so hard in updating our responses to the CAPRA standards and in hosting the visitation team during their visit. We can all be deservedly proud of a job well done.

**“No person was ever honored for what he received; honor has been the reward for what he gave.”**  
--Calvin Coolidge



*Park staff, Freeholders, Recreation Commissioners and members of the Friends of the Parks met with the 3-person panel from CAPRA at the Manasquan Reservoir last November, during their 4-day review of Park System facilities and operations. They were Chairman Jim Grove, retired Executive Director of the Oregon Park District in Illinois; Phil Mease, Superintendent of Parks for James City County in Williamsburg, Virginia; and Bethany Timmes of the Department of Parks and Recreation in Green River, Wyoming.*

*Employees Get Recognized, continued*



**20 Years** (front row, l to r): Denise Dockweiler of Reservations; Carol Stasik of Headquarters Administration; Senior Golf Ranger Amy Pease of Howell Park Golf Course; and Supervising Data Control Clerk at Headquarters, Louise McCook. (back row, l to r): Dorbrook Principal Park Ranger Tom Dillon; Supervising Park Planner Faith Hahn; and Senior Manager Ken Thoman. Not pictured: Patti Conroy, Jim Register, Dolores DeMaria, and Diane Elwood.



**25 Years:** Senior Greenskeeper Brad Roe of Bel Aire Golf Course and Supervising Park Planner Joe Sardonía.



**30 Years:** Assistant Superintendent of Parks Mike Bennett.

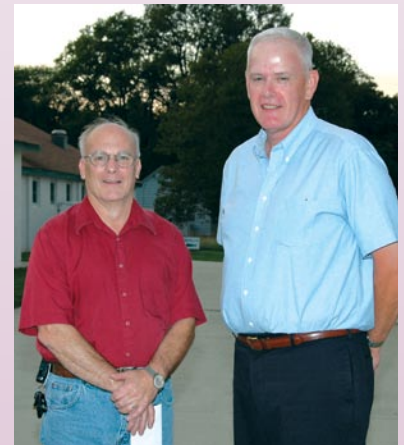

**35 Years:** Sign Maker III Dave Dellest of Construction and Repair and Turkey Swamp Park Senior Park Ranger Craig Fraser. Not pictured: Terry Normand

## Employees Honored for Accomplishments in 2008



Senior Park Ranger Andy Spears received a **Community Service Award** to recognize the expertise he brings to the parks from his years of service on his local volunteer fire department, where he is now a captain. This includes figuring out how to aerate Marlu Lake to correct an environmental problem, as well as responding to park emergencies as a skilled EMT and firefighter. He is pictured here with his son, Robert.

Supervising Park Planner Faith Hahn was honored with a **Community Service Award** for her hard work on the complicated process of securing land for open space and recreation from the closing of Fort Monmouth.



Faith, known for her terrific sense of humor, joked that perhaps a salary increase was in order too, since she appears to own only one shirt-which she wore both in the photo (see screen in background) and on the day of the ceremony.



Bel Aire Golf Center Senior Ranger Tom Ketcham was acknowledged for his **Outstanding Customer Service**, but his kindness and easy-going temperament are well-known to co-workers and staff as well.

He is pictured (left) receiving the award from Recreation Commissioner Ed Loud (center) and Fred Rummel (right).



Senior Park Ranger Ed Luzzi was honored with a **Heroism Award** for rescuing a family stranded on the trail at the Manasquan Reservoir during a lightning storm.



Golf Ranger Ilona Szabo deBucs, now at Hominy Hill Golf Course but formerly of Charleston Springs, was named **"Rookie of the Year"** for her exceptional people skills and rapport with customers.

Her work ethic, great attitude and computer expertise make her an asset to any area she works in.



Chief Landscape Architect Andy North received an **Above and Beyond Award** for his role in the coordinating the smooth transition of 30 A&D staffers into new offices, while their old building undergoes renovation. He is pictured here with his "mini-me," Ian.

Asst. Public Information Officer Lisa Bonelli received an **Above and Beyond Award** for her work on the Green Heritage newsletter. The newsletter won two awards in 2008.



Lisa is pictured with Assistant Superintendent, Personnel/Safety and Training, Andrew Spears (left) and Recreation Commission Chairman Ed Loud (right).

Barbara Berry of Administration was honored with an **Above and Beyond Award** for her round-the-clock management of the Golf Course Tee Time Reservation System.



Her dedication is demonstrated by her willingness to respond when after-hours problems occur. Barbara is pictured (left) with her supervisor, Louise McCook.



This year's **Leadership Award** went to Senior Park Manager Bill O'Shaughnessy. Bill manages operations for most of our properties out in Western Monmouth County and is considered a great role model among park staff. He was recognized for his concern for the well-being and advancement of his crew.

Last, but not least...Carol Stasik of Administration received this year's **County Fair Award** for a job amazingly well done.



She single-handedly changed the landscape of this year's Fair with loads of new acts and entertainment. Carol is pictured here with Thompson Park Supervising Park Ranger Rich Olsen who recently retired from the Park System after 36 years of service.

## MEMORY LANE: RETIREE DOROTHY HAHN DROPS US A LINE

Dorothy was an Assistant Recreation Supervisor from 1971 to 1988 and was with the Park System's pottery and ceramics program from its inception. During her tenure, the program grew to a roster of 8 ceramics classes per week (which Dorothy taught) with another 8 pottery classes offered. When Dorothy worked with us, there was no Creative Art Center! Her fledgling program was housed in the building that now holds Construction and Repair in Thompson Park (next to the 40-stall barn). Today, the Creative Art Center hosts more than 20 pottery and ceramics classes-plus another 20 craft classes such as painting and quilting-each week.



Dorothy shared some very nice memories and in particular noted how she enjoyed being given the freedom to develop the programs as she thought

they should be. She worked with a "great group of people,... who never gave her a hard time" about the direction she wanted to go.

Dorothy was happy to learn of the continued success of the program, the building of the Creative Art Center, and some of the new "extras" such as the Art Show and the pottery demos at this year's Fair.



*This photo of "Dot" appeared in the September 1988 Green Link, with an article about her retirement.*

A long-time retiree, Dorothy lives in Ocean County and is active in a program that provides crocheted lap robes for nursing home residents and retirees. She says the "thank you" letters she receives from the veterans (they get red, white and blue lap robes)

tell her that they are very grateful for the time and effort she puts in. Dorothy asked us to say "hello" to anyone who remembers her!

## STAFF AT WORK, AROUND THE PARKS



*Fair Ticket-Takers (clockwise, from bottom): Asst. Supervisor Therapeutic Recreation Lauren Gerber, Headquarters Receptionist Barbara Urbinato, Graphic Artist Laurie Marswillo, and Purchasing Asst. Stephanie Weise.*



*Hartshorne Woods Staff (l to r): Senior Park Ranger Kivin Brown; Park Rangers Larry Bork, Steven Moraghan, and Jason Miller; and Park Manager Ken Olsen.*



*Recreation Commissioners Tour the Parks (l to r): Fred Kniesler, Ed Loud, Tom Hennessy and former Commissioner Channing Irwin at Holmdel Park's new Hill Top playground.*



*Tatum Crew: Senior County Park Ranger Bob MacDonald and seasonal Park Ranger Declan French.*



*Staff at work on Wainford Day (l to r): Senior County Park Ranger Brian Sullivan, Historic Site Interpreter Matthew Douglas and Park Ranger Patrick Cardwell.*



*Park Staff Host CAPRA Meeting: Manasquan Reservoir Park Manager Matt Coleman and Superintendent of Recreation John Hoffman.*

# MEET THE “COLORFUL” BOOGIE-WOOGIE APHID

This past fall, while on a nature hike with pre-schoolers at Holmdel Park, Naturalist Janet Ryan and her students noticed a very curious site: an unusual white branch on the normally smooth grey bark of some beech trees. It couldn't be snow, yet that's what it looked like. Upon closer inspection, the coloring-culprit was revealed-lots of little white bugs. And, they seemed to be dancing--actually shaking their booty--in some type of rhythmic pattern.



*This Beech Tree branch at Holmdel Park is infested with the Beech Blight Aphid.*



*A close-up view of the aphids.*

Janet investigated and determined the bugs were an infestation of Beech Blight Aphid, a fairly common and temporary blight affecting beech trees. This bark-eating pest is also called the “Boogie-Woogie Aphid” because while its piercing mouth-part is attached to the bark, its posterior remains raised in the air and wiggles when the branch is disturbed.



*Honeydew, the excrement of the aphids, can be found all over the trees, on the leaves, branches and the ground near the roots, as well as in these ball-like structures.*

Turns out, the dancing is not even the weirdest part of the story. This species eats an awful lot of tree sap and, not surprisingly, produces copious amounts of excrement. The excrement is then expelled in large orange clumps called “honeydew.” Then, the honeydew is colonized by a type of sooty mold-which turns the honeydew black.



*The black sooty mold that colonizes the honeydew can grow so thick and tarry that it, too, becomes a sight to behold. It hasn't yet done so here.*

While the aphids don't generally cause serious harm, this colorful chain reaction can remain active for 2-3 years. Several parasites serve as a type of natural control and may eventually reduce population size. If you find yourself

near the Beech Trail at Holmdel Park next fall, keep your eyes peeled for their return.

Reference: The Beech Blight Aphid. University of Massachusetts Extension, Robert D. Childs, Entomologist. Available at: [www.umassgreeninfo.org/fact\\_sheets/piercing\\_sucking/beech\\_blight\\_aphid.pdf](http://www.umassgreeninfo.org/fact_sheets/piercing_sucking/beech_blight_aphid.pdf). Accessed December 5, 2008.

## Nature Shots:

What a Difference a Few Minutes Make...

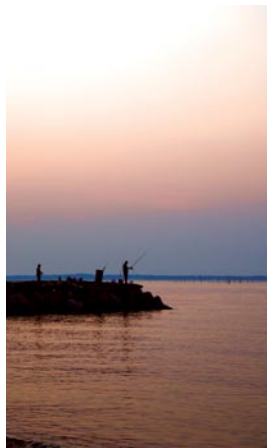
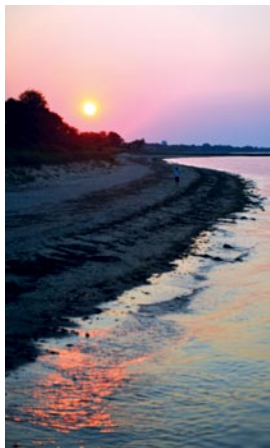
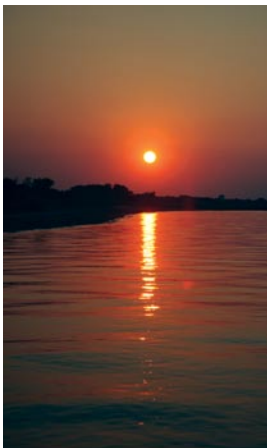

*Here's a stunning series of photos captured at Bayshore Waterfront Park last August by park photographer Andi Monick. Look how the color palette changes as the minutes pass and the sun finally sets.*



*This juvenile Red-tailed Hawk sat perched atop a fence-post outside the Visitor Center last November for a good 10 minutes, as staff viewed it from every window and photographer Maribeth Gardener gingerly approached it to take photos. From the front, it's relatively easy to identify by its characteristic dark belly-band, or chest hash-marks.*



*Just a few minutes later, once the bird has turned around, identification gets a little trickier. And, don't bother to check the tail, even though it is in full view-it won't actually turn red until the bird's second year! (A mature Red-tailed Hawk usually has a distinctive red tail.)*

# CONSTRUCTION NEWS...

- **Planning** is underway for Tony's Place, the new "universal-access" playground at Seven Presidents, and staffers are having fun with the seaside theme. Play elements under consideration include a pirate ship (ahoy, mateys!), a fishing village and sculptures of dolphins and whales.

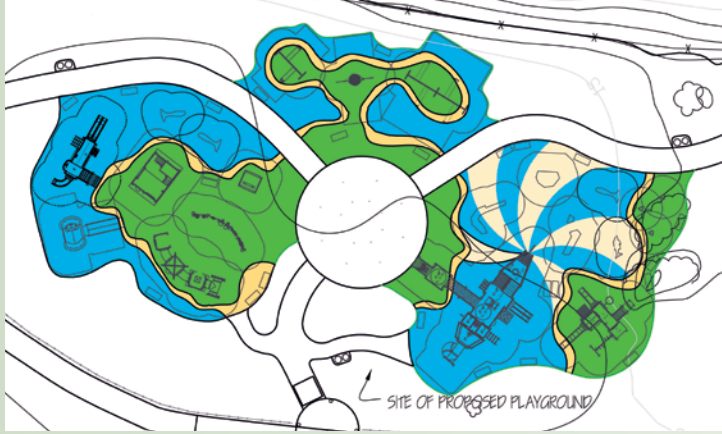

*Design plan for Tony's Place Playground at Seven Presidents. Can you find the fish sculptures and pirate ship?*

- **Completed Projects:** Dorbrook site upgrades and parking lot expansion (100 extra parking spots!); resurfacing of the Skateplex skating rink at Seven Presidents; and demolition of old buildings at Big Brook. Did you know that parts of Big Brook were once used for farming and livestock by the now-closed Marlboro Psychiatric Hospital across the street? This facility used to raise its own food, dairy and livestock (more about that in the next issue).



*This entire new row of parking spaces was added as part of a parking lot upgrade at Dorbrook—a bonus for the park's many visitors.*

- **Projects Underway:** Accessibility improvements at Turkey Swamp Park lakefront; Seabrook Wilson House renovation; Huber Woods Environmental Center—multiple renovations inside and out; rehabilitation of the A&D building; deer fencing around the Holmdel Aboretum (to protect the plants); new restrooms at the marina; and a new irrigation system for Bel Aire Golf Course.

- **Projects Coming Up:** Howell Park Golf Course Golf Center renovation, storage for records at Thompson Park, repair of Hillside walks at Deep Cut Garden, installation of solar panels at Sunnyside Equestrian Center, plus ongoing roof repairs, demolitions and plantings throughout the parks.

## & GREEN NOTES

- The siding used for the new Visitor Center is a fiber-cement called hardiplank made of Portland cement mixed with ground sand, cellulose fiber and other additives. It is considered a green building material because it saves trees (looks like wood but doesn't contain wood), is less expensive and is fire resistant. Also, wherever possible, the contractors "bought local." For instance, the custom grand staircase, was made in Linden, NJ by a company with 50 years experience.



*Bought local--Kaufman Stairs of Linden NJ is building the custom "grand staircase" for the new Visitor Center. Here it is, in progress, last November.*

- In addition to the elegant design that highlights surrounding trees (providing lots of shaded play areas) and features more green space, the new Hill Top Playground at Holmdel Park is surfaced with a state-of-the-art recycled material made of ground-up tires. This base, called the buffing, is then covered with a color-coated surface material.



*The new and very green Hill Top Playground at Holmdel Park.*

## THE VOLUNTEER CORNER

Just one group of many who pitched in on Thompson Park Day (l to r): Alexa Morales, Lukas Zirngibl, and Caroline Castro.



## BLAST FROM THE PAST



(l to r) Matt Clement, Bruce Peeples and Dave Pease stand in front of the garage at Howell Park Golf Course, circa 1984. Matt and Bruce have both left the Park System for the private

sector, while Dave is currently General Manager of all the Golf Courses.

## Farewell, Retirees!

★ **Linda Pugliesi**, Sr. Clerk Typist, Operations and Maintenance, November 1, 2008

★ **Angela Flynn Knox**, Recreation Supervisor, Performing Arts, January 1, 2009

★ **Rich Olsen**, Supervising County Park Ranger, January 1, 2009



### March

- 1 Edward Dobrosky
- 2 Erika Bozza • Andy Nunes-Vais
- 3 Chris Brawley • Susan Walsh
- Ruth Ann Zobel
- 4 Philip Andras
- 5 Bob Laauser
- 6 Christina Carlson
- 7 Ann Reinhardt
- 8 Jeff Faistl • Bruce Gollnick
- Theresa Secks
- 9 Maryann Goodwin
- 10 Matt Bezahl
- 12 Steve Matthews • Ray Moylan
- 13 Karen Jarmusz • Brad Rogers
- Scott Simpson
- 18 Peter Kucker
- 20 Jake Savage
- 21 Ryan Kimble • Debbie Tamburello
- 24 Sandy Byard
- 25 Barbara DeLorenzo • Maryann Elwood
- 26 Sharay Bartow
- 28 Chet Scalzo
- 31 Tim Mariner

### April

- 1 Greg Hyland
- 2 John Gubernat • Chris Lanza
- 4 Barbara Urbinato
- 6 Mike Bennett
- 7 Wayne Ossner
- 8 Jacques DiPane • Cindy Ross
- 9 Lisa Bonelli
- 10 Allen Boyce • Al Weaver
- 11 Susan Provost
- 12 Gloria Cohen • Al Picerno
- 13 Tom Fobes
- 16 Bill Stevenson
- 17 Dan Bisti • Jim Chase
- 18 Sam Skinner
- 19 Ed Luzzi • Sean Ramsey
- 20 Susan Madden
- 22 Patrick Farmer
- 23 Scott Schaaf
- 24 Sean O'Herron • Tom Toon
- 26 Jean Kline
- 27 Laura Schoeffling
- 28 Jeff Willever
- 29 Patty Burke
- 30 Ryan Abbott

### May

- 1 John Carey • Drew D'Apolito
- 2 Steve Clayton • Denise Dockweiler
- 3 Laura Lieneck
- 4 Leigh Schneider
- 6 Tim LaVance
- 7 Heng Chin • Craig Fraser
- Brian Sullivan
- 8 Patti Conroy • John Eisemann
- 9 Ken Thoman • Bob Ward
- 10 Ann Sage
- 11 Cathy Barfield • Marijane Bruncati
- Bob Kolczynski • Janet Ryan
- 12 Dave Compton • Peter D'Angelo
- 14 Laurie Marswillo
- 15 Chris Davidson
- 16 Ryan Shaughnessy
- 18 Helen Fiore • Karen Livingstone
- Julie Soleil
- 20 Tom Noordzy
- 21 Shawn Allen
- 25 Hank Schreiber
- 26 Michelle Scolletta Gosha
- 27 Jeff Szalc
- 30 Gary Stedman



Monmouth County Park System  
805 Newman Springs Road  
Lincroft, NJ 07738-1695

March/April 2009

PRSR STD  
US POSTAGE  
PAID  
MONMOUTH CO.  
PARK SYSTEM

## 2009 Date Minder

### Sunday, March 1

E. Murray Todd Half Marathon, 9 am  
Brookdale Community College  
Manasquan Reservoir Boat Ramp Re-Opens

### Sunday, March 8

Volunteer Recognition Luncheon,  
Noon-3pm Hominy Hill

### Sunday, March 15

Golf Courses Re-Open  
Turkey Swamp Campgrounds Re-Open  
Manasquan Reservoir Boat Rental Begins

### Saturday, April 4

Waln's Mill Re-Opens for Demos

### Saturday, April 18

Earth Day at Manasquan Reservoir, Noon-5pm

### Saturday, April 25

Deep Cut Plant Swap 10am-2pm  
Sheep Shearing, Longstreet Farm Noon-3pm

### Sunday, April 26

Friends of the Parks' Donna 5K Lane Race,  
9am Thompson Park  
Sheep Shearing, Longstreet Farm Noon-3pm

## Welcome, New Hire:

**Tanya Dinova** Park Naturalist, started 12/8/08  
Manasquan Reservoir

**A COLOR CELEBRATION...** Here is a special photo to enjoy now that the Green Link is produced in color.



*Thompson Park, June 2007.*