

**MONMOUTH COUNTY PARK SYSTEM**

**ANNUAL REPORT 2007**





## **The Monmouth County Park System welcomed its 100,000,000th visitor in 2007.**

In another milestone, 2007 was also a record-breaking year for annual attendance with over 5 million visits to the parks. But that's just part of the story. The Park System was also busy acquiring land for the county's future recreation needs, and managing the more than 14,000 acres of open space it has already preserved.

These are big numbers, certainly, but they don't reflect everything that the Park System does. So this year, we've compiled some extra figures—ones that you may not normally see.

---

**This year's annual report includes some extra figures—ones that you may not normally see.**

---

We hope they will help illustrate the depth and breadth of park services available. We also hope they will outline the scope of responsibility required by a Park System that serves millions of visitors and manages thousands of acres of public land each year.

For instance, did you know that in addition to offering approximately 4,000 individual recreation programs, the Park System hosts more than two dozen special events, races and golf tournaments each year? And, were you aware that the land we manage for parks, open space and natural resource protection also contains more than 350 buildings and other structures that require oversight?

Please take a moment to skim the following pages and see what the county parks are doing for you. From bike trails, meadows and fishing sites to playgrounds festivals and races—count on the county Park System to continue providing open space, first rate facilities and programs to meet the recreational needs of all Monmouth County's residents.



*Japanese Maple at Deep Cut Gardens*

## **\$17,700,000** **Monmouth County's 2007** **Open Space Trust Fund**

This money is earmarked to be spent as follows: \$7.9 million for Park System land acquisition in 2007; \$2.2 million for county park improvements; \$2 million to the Municipal Open Space Grant Program (for towns to purchase open space and develop recreation facilities); \$1.1 million for county farmland preservation; a \$2.7 million payment to the 2005 bond and a \$1.8 million payment to the 2007 bond (these bonds are money borrowed against future Trust Fund allocations that allow the parks to acquire tomorrow's land at today's prices).



*Repared 7,966 feet of the Henry Hudson Trail*

## **\$271,806,231**

### **Value of all land acquired by the Park System since its inception in 1960**

(Calculated at the time the land was acquired.) While the bulk of this amount (probably more than 95%) represents purchased land (and easements), this figure also includes land that was donated or exchanged. If this figure were calculated at today's going rate of about \$35,000/parkland acre, the value is almost double the figure above—\$493 million.

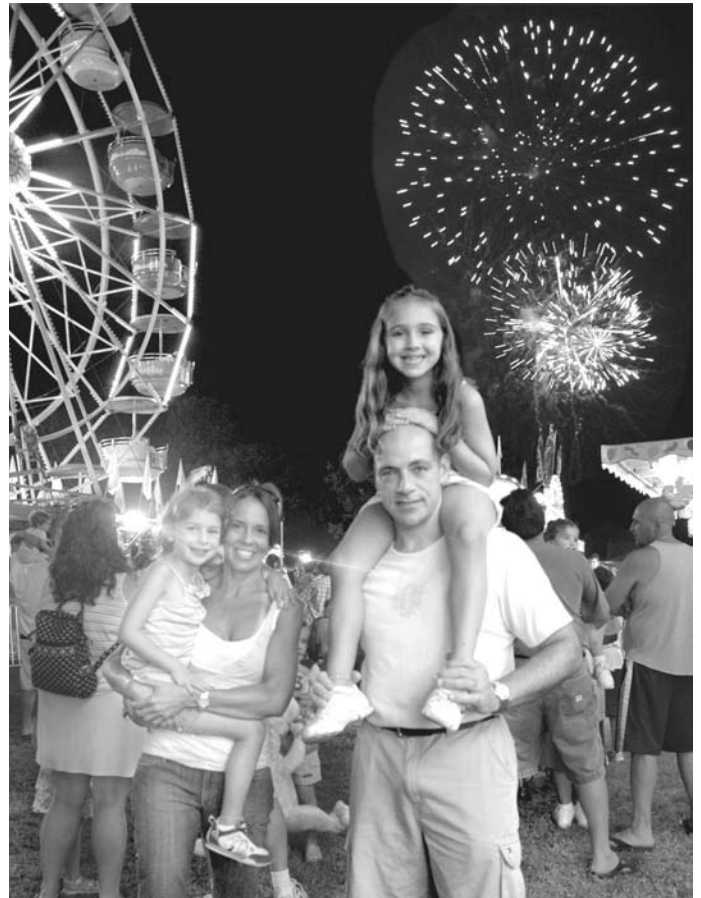

*Monmouth County Fair Visitors*

## **5,059,911**

### **Visits to the county parks in 2007**

This was the second year in a row of record-breaking park attendance; there were 4.8 million visits in 2006. With numbers like these, it's obvious the parks are a popular destination for area residents—a trend that we find very encouraging. If you haven't done so already, why not stop by a county park and see what millions of your neighbors are enjoying each year.



*Winter Golf at Bel-Aire Golf Course*

**232,944**

### **Summer visitors to Seven Presidents Oceanfront Park in 2007**

Located in Long Branch, this is one of the Park System’s most highly attended sites, and for good reason. There are plenty of amenities—from a snack bar and pavilion to outdoor showers and beach chairs for handicap access to the water. Here are a few things you may not know about the Park System’s only beach site: outside the summer months, admission is free; the site hosts two breeding populations of endangered birds; there are two playgrounds and a free SkatePlex for in-line skaters and skateboarders.



*Kids at play on Thompson Park Day*

**214,127**

### **Rounds of golf played in 2007**

With 8 county golf courses (7 18-hole courses and 1 9-hole course) at 6 different locations, the residents of Monmouth County have a lot to choose from. In 2007, the Park System began implementing a series of discounted golf rates, starting with special “Winter Golf” rates for all players at its two courses open during the cold-weather months: Shark River and Bel-Aire.



*Surfers at Seven Presidents Oceanfront Park*

**96,535**

### **Attendees at MCPS special events and races in 2007**

The Park System offers 20 special events each year. More than 66,000 people came to the Monmouth County Fair in July. Another 20,000 visited during one of the Park System’s three, free fall events—Walnford Day, Harvest Home Festival and Thompson Park Day. Park-sponsored races attracted over 4,000 participants and spectators in 2007, while golf tournaments, an annual lifeguard tournament, garden and other special events attracted an additional 6,000 visitors.



*Cross Country Meet at Holmdel Park*

## **57,473** Number of runners and spectators attending cross country meets at Holmdel Park in 2007

As one of the top-ranked cross country sites in the country, Holmdel Park draws many of the areas finest competitors. More than a dozen local teams run Holmdel as their home course. The site also hosts a series of regional and state meets, the largest of which boasts park attendance over 15,000. Holmdel Park has been hosting cross country meets since the early 1970s.

## **42,000** Visits to the Dorbrook Recreation Area Sprayground in 2007

This water playground in Colts Neck, open during the warm weather months, averaged about 340 visitors per day in 2007. But peak attendance during the height of summer reached more than 1,000 visitors per day, with two days where attendance topped 1,200!



*The Sprayground at Dorbrook Recreation Area*

## **10,794** People served by the Recreation Assistance Program each year

Because the cost of recreation is outside the reach of some Monmouth County residents, the Park System provides qualifying Urban Aid communities with a selection of low/reduced cost recreation programs. These include an after-school program in Asbury Park, a traveling Mobile Recreation Program “on wheels” for all ages, as well as week-long summer adventure camps. This program has been available for more than 20 years, and for some children, provides experiences such as their first time in a kayak, or on a rope climbing course.



*Urban Recreation's Mobile Program*

## 411

### Trees and shrubs planted during 2007

While forests regenerate, other park areas tend to lose trees to old age, disease, and damage over time. Park staff must replace them in order to maintain the landscape. New trees and shrubs are planted in the space created by the removal of invasive species. They also buffer or soften the impact of construction projects and provide shade alongside paved walking trails and open areas.



*Ice skating at Shark River Park*

## 100

### Buildings of historic significance in the parks

These include houses, barns and farm buildings, military bunkers and batteries, and other structures that embody distinctive characteristics or are associated with significant historic events, people or information. The oldest is the Seabrook Wilson House (built in the early 1700s) at the Bayshore Waterfront Park in Port Monmouth; the largest is the 40-stall barn at Thompson Park (29,900 sq. ft.); the most unique is perhaps Battery Lewis at Hartshorne Woods Park in Middletown; and the most distinctive may be the Gristmill at Historic Walnford in Upper Freehold, an award-winning structure that still operates to this day.



*New trees provide shade and structure at the Off-Leash Dog Area*

## 365

### Days per year that the county parks are open

Opening and closing times may vary by park and season, but in general the county parks are open every day from 8 am to dusk. With the exception of Seven Presidents Oceanfront Park in summer, admission to every park is free.



*Seabrook Wilson House at Bayshore Waterfront Park*



*One of many debris sites cleaned up in 2007*

## **26** Threatened/endangered bird species seen in the parks

New Jersey has a total of 29 bird species on its Threatened or Endangered Species List. The fact that 25 of them have—at some point—been spotted in the county parks is both interesting and encouraging. It helps demonstrate that the county parks are providing critical wildlife habitats for some of the area's most vulnerable avian species.



*Therapy Horses Snowflake (front) and Perfect Grammar*

## **28** Number of debris sites cleaned up, storage tanks removed, and buildings demolished in 2007

The Park System sometimes “inherits” garbage and/or undesirable structures with its land acquisitions. As stewards of the land, it is our responsibility to clean these areas up. The 28 projects completed in 2007 represent just one small part of this ongoing and often overlooked land management responsibility.



*Endangered Piping Plover at Seven Presidents Oceanfront Park*

## **16** Therapy horses for people with disabilities to ride

The Therapeutic Riding Program at the Sunnyside Equestrian Center, provided in conjunction with SPUR (see page 14), offers individuals with autism, multiple sclerosis, cerebral palsy, Down's Syndrome, and other neurological/physical disabilities access to one of the most important forms of physical therapy—horseback riding. From encouraging muscle development and balance to helping develop a sense of freedom and independence, the benefits are, in a word, amazing.

The Monmouth County Park System acquired 765 acres of land in 2007, comprised of 23 separate land transactions for 9 different park areas, plus 11 easements. The total cost of the land added in 2007 was \$24.4 million and is listed, right. Other land acquisition efforts, representing hundreds more acres, are still pending.

It is important to note that in acquiring these properties for 2007, the Park System received assistance from the Monmouth Conservation Foundation, a non-profit agency that provides financial and technical expertise, as well as the D&R Greenway Land Trust.



*Manasquan River Greenway*

**Acres Acquired in 2007**

<b>Location</b>	<b>Acres</b>
Big Brook Park.....	<b>1</b>
Clayton Park.....	<b>1</b>
Crosswicks Creek Greenway.....	<b>189</b>
Fisherman’s Cove Conservation Area.....	<b>3</b>
Huber Woods Park.....	<b>9</b>
Manasquan River Greenway.....	<b>5</b>
Perrineville Lake Park.....	<b>319</b>
Shark River Park.....	<b>13</b>
Turkey Swamp Park.....	<b>62</b>
<b>Subtotal</b> .....	<b>602</b>
<i>Easements</i> .....	<b>163</b>
<b>Total</b> .....	<b>765</b>

The total amount of land permanently preserved by the Monmouth County Park System for open space now stands at 13,153 acres (fee simple or owned outright), with another 1,135 acres managed through use agreements, for a total of 14,288 acres. Please see the map on pages 10 - 11. Another 943 acres are preserved throughout the county as easements.

With continued collaboration between non-profit and government agencies—and continued support from the residents of Monmouth County—the Park System grows closer to reaching its ultimate goal of 19,000 acres

Each year, the Board of Chosen Freeholders also awards \$2 million in matching grants so that towns may purchase land or develop recreation projects locally. In 2007, the program’s fourth year, 5 towns received grant money for land acquisition. They are Allentown, Belmar, Holmdel, Tinton Falls, and Upper Freehold.

## 2007 Accomplishments by Area

### Administration & Planning

- Awarded \$1.9 million in Open Space Grants to towns in Monmouth County
- Secured National Park Service approval to acquire surplus land at Ft. Monmouth
- Published a new County Open Space Plan. Updated every 7-8 years this is the official plan for Park System land preservation efforts
- Online registration now available for most park programs
- Expanded the “jobs” section of our website to include seasonal positions
- Recruited local students to find jobs in the parks that match their career plans/majors

### Cultural Services

- Doubled enrollment for “cross-over” programs offered with Sports and Fitness for students on Spring Break
- Secured tickets for and offered trips to such high demand outings as the King Tut exhibit at Philadelphia’s Franklin Institute and Cirque du Soleil at Madison Square Garden
- Offered a Chinese language program (for 3-8 year olds) for the first time

### Nature Programs

#### Huber Woods Environmental Center

- Marine science programs at Bayshore Waterfront Park continue to grow by leaps and bounds (40% more participants versus last year)
- Staff worked with scout groups to enhance the Discovery Trail and flower beds



*Children examine nature at Shark River Park*

### Nature Programs

#### Manasquan Reservoir Environmental Center

- Two new fish tank exhibits will highlight trout development (beginning with the hatching of eggs!)
- Boosted by great Bald Eagle news (one chick hatched on site and a foster chick was adopted), the center had 10,000 visitors in just April and May
- The Monmouth Audubon Society hosted its annual Great Backyard Bird Count at the Reservoir



*Pastoral scenery of Historic Walnford*

### Historic Sites

- Historic Walnford received designation as part of the Upper Freehold Historic Farmlands Byway, a 24-mile driving loop highlighting area landmarks

## Creative Arts Programs

- Offered more than 20 new craft programs, many for children as after-school activities
- Added two new sites for residents to enjoy a popular children's painting class

## Therapeutic Horseback Riding at Sunnyside Equestrian Center

- Served over 500 program participants in 2007
- Added a new program for advanced riders, called ARIES (Advanced Riders and Independent Equestrians of SPUR)
- Trained 47 volunteers and 3 new instructors. Ultimately, these instructors will all be NARHA certified (North American Riding for the Handicapped Association)



*Children's soccer programs*



*"Kiss Me Kate" played to sell-out crowds*

## Urban Recreation

- Enrolled the largest number of 3-5th graders at the Coastal Activity Center since the program started in 2003
- Served over 3,800 people through the division's Mobile Recreation Unit, almost 2,000 in July alone (the unit's busiest month)
- There are now 58 groups that qualify for the Park System's Recreation Assistance Program (RAP)

## Sports & Fitness

- Offered sports programs at 16 different county locations—many outside the parks—to reach new residents
- Provided almost 250 group and individual swim lessons to adults and children of all levels
- Doubled the number of skateboarding classes, added more T-ball classes and Flag Football to the program line-up

## Outdoor Recreation

- New women's programs offered weekday mornings—boating climbing, hiking, biking, sailing and more—have met with great success
- Tripled participation in this year's Fishing Derby held at the Outdoor Expo in Turkey Swamp Park last May

## Therapeutic Recreation

- Added new programs tailored to people with autism and Down's Syndrome: Taste "Buds," Afternoon Adventures, Cardio Rock and Healthy Habits
- The Adult Care Program now meets three days per week and serves 24 individuals with special needs
- The ever-popular Senior Hikers and Walkers programs continue to sell out, introducing more and more people to the beautiful park trails

# 2007 County Park Acreage - by Category

## Open Lands

Baysholm Tract.....	<b>71</b>
Yellowbrook Tract.....	<b>337</b>

## Recreation Areas

DeBois Creek Recreation Area.....	<b>135</b>
Dorbrook Recreation Area.....	<b>535</b>
Sunnyside Recreation Area.....	<b>135</b>
Wolf Hill Recreation Area.....	<b>92</b>

## Regional Parks

Bayshore Waterfront Park.....	<b>227</b>
Big Brook Park.....	<b>379</b>
Clayton Park.....	<b>422</b>
Hartshorne Woods Park.....	<b>786</b>
Holmdel Park.....	<b>565</b>
Huber Woods Park.....	<b>366</b>
Perrineville Lake Park.....	<b>804</b>
Shark River Park.....	<b>946</b>
Tatum Park.....	<b>366</b>
Thompson Park.....	<b>667</b>
Turkey Swamp Park.....	<b>2111</b>

## Special Use Areas

Deep Cut Gardens.....	<b>54</b>
East Freehold Showgrounds.....	<b>81</b>
Historic Longstreet Farm.....	<b>9</b>
Historic Walnford.....	<b>36</b>
Manasquan Reservoir.....	<b>1204</b>
Monmouth Cove Marina.....	<b>11</b>
Mount Mitchell Scenic Overlook.....	<b>12</b>
Seven Presidents Oceanfront Park.....	<b>38</b>

## Unclassified

Durand Tract (leased to Freehold).....	<b>94</b>
Weltz Park.....	<b>165</b>

## Conservation Area

Fisherman's Cove.....	<b>55</b>
-----------------------	-----------

## Golf Courses

Bel-Aire.....	<b>101</b>
Charleston Springs.....	<b>781</b>
Hominy Hill.....	<b>183</b>
Howell Park.....	<b>308</b>
Pine Brook.....	<b>61</b>
Shark River.....	<b>176</b>

## Greenways

Crosswicks Creek.....	<b>1436</b>
Henry Hudson Trail.....	<b>100</b>
Manasquan River.....	<b>337</b>
Metedeconk River.....	<b>98</b>
Union Transportation Trail.....	<b>4</b>

**Total acres owned and/or managed by the Park System.....14,288\***

\*This includes 1,135 park acres under Use Agreements: 1052 acres of the Manasquan Reservoir are owned by the NJ Water Supply Authority and leased to the Park System for perpetual use; 83 acres of the Henry Hudson Trail are county owned, but purchased for transportation purposes.

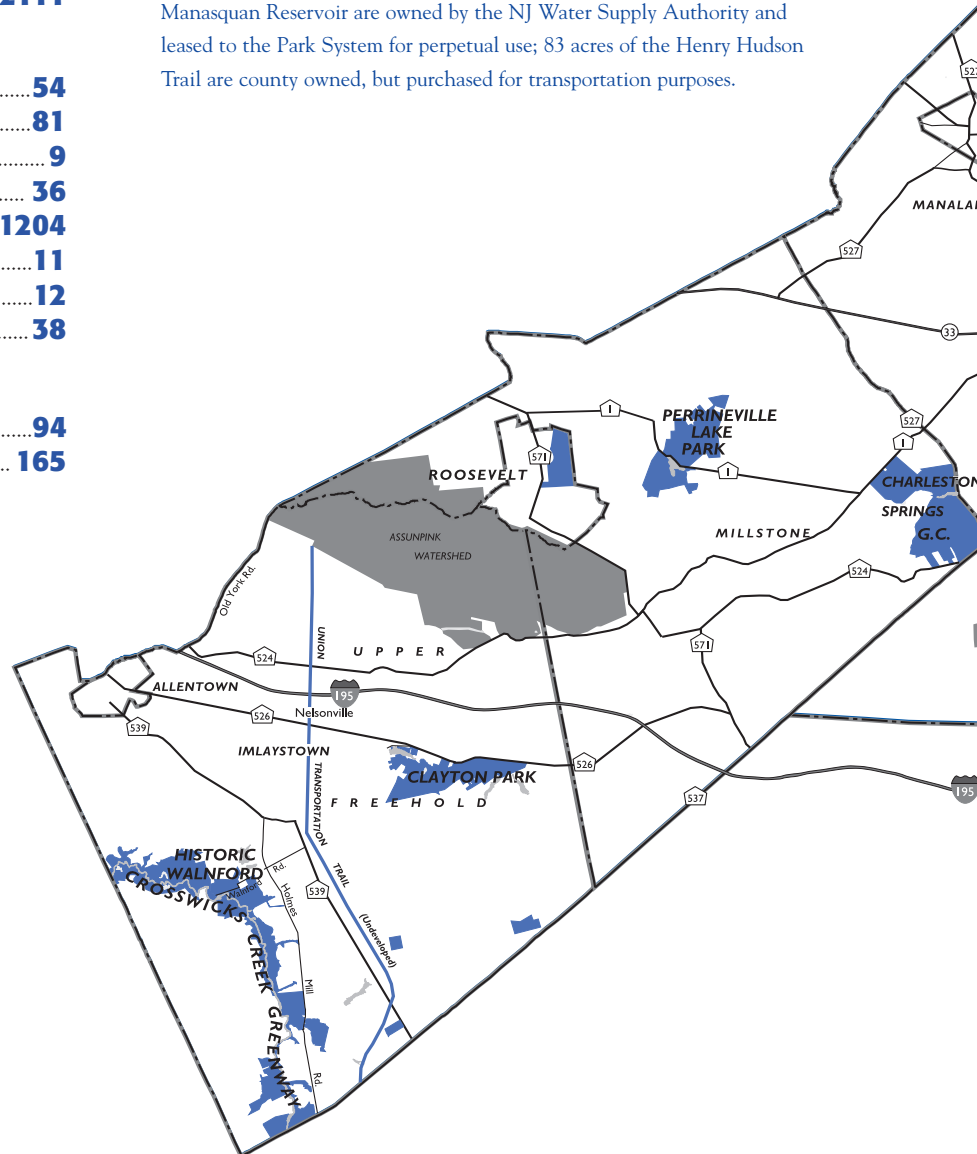



## 2007 New Facilities & Park Improvements



*New cabins at Turkey Swamp Park*

- Expanded the paved trail at **Thompson Park** by about 1 mile; the total length is now over 5 miles. This park also received a new parking lot, access road, directional signs, ephemeral ponds (to handle storm run-off), and a lot of new trees.
- Added a new 0.7 mile paved trail at **Holmdel Park**. This site's Shelter Building also received a new roof, a new group picnic shelter was built at the Hilltop section, and a new trail bridge was constructed in the Ramanessin section of the park.
- Installed a new Orientation Exhibit at **Longstreet Farm**. Also restored the Wagon House and foundation of the Potato House at Longstreet Farm.
- Opened a new 1.3 mile trail at **Perrineville Lake Park** and created two temporary parking areas for trail access.
- Installed new patios and walkways at **Shark River Golf Course**. Also added a new Starter Building.
- Restored more than a dozen golf bunkers in-house at **Howell Park, Hominy Hill, and Shark River Golf Courses**.
- Removed aggressive, invasive trees/shrubs at **multiple park sites**. Species removed include Norway Maple (*Acer platanoides*), Tree of Heaven (*Ailanthus altissima*), Porcelain Berry (*Ampelopsis brevipedunculata*), Autumn Olive (*Elaeagnus umbellata*), and Garlic Mustard (*Alliaria petiolata*).
- Built a new parking lot and gave a "facelift" to the **Henry Hudson Trail**, north. Sections of the south trail also underwent clean-up. The new parking lot is located on Lloyd/Gerard Rd. in Aberdeen (near Parkway Exit 117) and offers greater access to the trail.
- Built two new camping cabins at **Turkey Swamp Park**; each sleeps 6 and one is ADA accessible. Also, opened the 1 mile Metedeconk Trail connecting the main park with the Nomoco Activity Area.
- Added 5,200 sq. ft. of program and visitor space to **Sunnyside Recreation Area** at the Arena, and rehabilitated the Historic Barn.
- Began planning for a second Off-leash Dog Area at the **Wolf Hill Recreation Area** (the first Off-leash Dog Area is at Thompson Park).

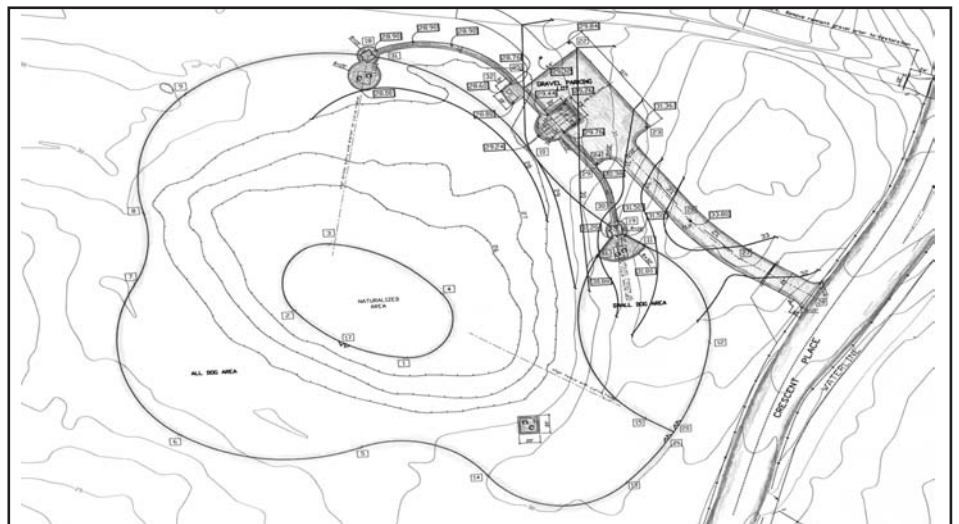

*Design for the new Off-Leash Dog Area at Wolf Hill Recreation Area*

- Resurfaced the playground at **Shark River Park**.
- Hosted more than 30 events at the **East Freehold Park Showgrounds**.
- Added shade shelters with seating, cubbies, and a water mister to the Skateplex at **Seven Presidents Oceanfront Park** and paved the parking lots.
- Dredged the basin and inlet of **Monmouth Cove Marina**.
- Constructed a new septic system for the Visitor Center and color coded the courts at **Dorbrook Recreation Area**.



*Removed Garlic Mustard, an invasive species*



*New shade shelters at the Skateplex at Seven Presidents Oceanfront Park*



*New trail bridge in the Ramanessin section of Holmdel Park*

## 2007 Park Attendance

Bayshore Waterfront Park.....	<b>149,418</b>
Bel-Aire GC, 18-hole.....	<b>24,225</b>
Bel-Aire GC, 9-hole.....	<b>13,566</b>
Clayton Park.....	<b>39,720</b>
Charleston Springs GC.....	<b>48,795</b>
Deep Cut Gardens.....	<b>77,413</b>
Dorbrook Recreation Area.....	<b>719,983</b>
East Freehold Showgrounds.....	<b>106,963</b>
Hartshorne Woods Park.....	<b>193,155</b>
Henry Hudson Trail.....	<b>167,753</b>
Historic Longstreet Farm.....	<b>90,132</b>
Historic Walnford.....	<b>9,887</b>
Holmdel Park.....	<b>818,143</b>
Hominy Hill Golf Course.....	<b>36,510</b>
Howell Park Golf Course.....	<b>31,784</b>
Huber Woods Park.....	<b>58,447</b>
Manasquan Reservoir.....	<b>918,106</b>
Monmouth Cove Marina.....	<b>28,533</b>
Mount Mitchill Scenic Overlook.....	<b>158,844</b>
Pine Brook Golf Course.....	<b>24,685</b>
Seven Presidents Oceanfront Park.....	<b>395,707</b>
Shark River Golf Course.....	<b>34,562</b>
Shark River Park.....	<b>226,101</b>
Tatum Park.....	<b>122,236</b>
Thompson Park.....	<b>317,890</b>
Turkey Swamp Park.....	<b>247,353</b>
<b>Total.....</b>	<b>5,059,911</b>

## Park Supporters



In 2007, 1,018 dedicated volunteers contributed a total of 26,125 hours of service to the Park System. From performing in and producing summer musicals (more than 5,500 hours) to providing therapeutic horseback riding lessons (over 4,500 hours), a variety of important jobs are performed by volunteers. Additional volunteer accomplishments in 2007 include program assistance for seniors and challenged individuals; demonstrations at Longstreet Farm and Historic Walnford; leadership for dozens of trips and cultural events; instruction for

Outdoor Recreation programs; garden maintenance at Thompson Park (pictured), Deep Cut Gardens and Mount Mitchell Scenic Overlook; representation at lifeguard competitions; dune restoration at Seven Presidents Oceanfront Park; beach clean-ups at Fisherman's Cove Conservation Area, Henry Hudson Trail and Seven Presidents Oceanfront Park; 1,089 hours toward building and maintaining the Park System trails; production assistance for the annual Creatures of the Night program; student service-learning projects; staffing for special events, races, and office work; and technical assistance for developing park presentations. Since 1993, the Park System has recognized 52 people for contributing over 1,000 hours of service. **Want to make a difference? Contact the Park System's Coordinator of Volunteers at 732-842-4000, ext. 4283 or email [volunteer@monmouthcountyparks.com](mailto:volunteer@monmouthcountyparks.com).**

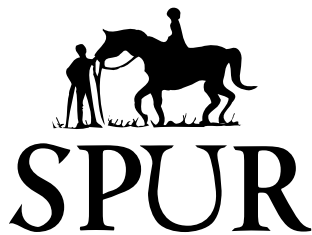

Special People United to Ride (SPUR) provides year-round horseback riding opportunities to people with disabilities at the Park System's Sunnyside Equestrian Center in Middletown. A non-profit 501(c) 3 charitable organization, SPUR has raised money to help the Park System build and update facilities—including the arena addition completed in 2007, as well as to buy horses and equipment,

provide scholarships, and train volunteers/instructors. In 2007, 119 riders with disabilities received the benefits of individually designed and supervised therapeutic riding lessons. SPUR provided 45 of these students with "riderships." Built on the success of the therapeutic riding program, the Advanced Riders and Independent Equestrians of SPUR (ARIES) program (pictured) was developed in 2007.

**Contact SPUR at 732-224-1367, or by visiting [www.spuronline.org](http://www.spuronline.org). Write to SPUR c/o Monmouth County Park System, 805 Newman Springs Rd., Lincroft, NJ 07738**





The “Friends of the Parks,” a not-for-profit 501(C)3 charitable organization, is comprised of citizens and businesses committed to supporting the Monmouth County Park System. Since 1991, the Friends have had a positive impact on the landscape of the parks by providing additional funding for recreation programs and special improvement projects. In 2007, the Friends funded four major projects: an orientation exhibit for the Longstreet Farm Visitor Center in Holmdel Park (pictured), upgrading the “Streams of Consciousness” exhibit at the Manasquan Reservoir Environmental Center, repairs to the mill at Historic

Walnford, and conservation of the Robert Trent Jones original drawing of the Hominy Hill Golf Course. Other projects funded by the Friends include Urban Recreation “camperships,” Therapeutic Recreation trips and social events, historic clothing and antiques, and various volunteer appreciation recognitions. Annual Friends events include: the Donna 5K Lane Race, the Annual Golf Tournament at Hominy Hill Golf Course, the Monmouth County Fair Super 50/50 and regular 50/50 raffles, the Strut Your Mutt Doggie Costume Contest at Thompson Park Day, and an annual fundraising dinner, Ballads in the Woods.

**To learn more log onto [friendsofmonmouthcountyparks.com](http://friendsofmonmouthcountyparks.com), call the Friends Office at (732)975-9735, or write: Friends of the Parks, PO Box 686, Lincroft, NJ 07738-0686.**



The Monmouth Conservation Foundation (MCF) celebrated 30 years of open space and farmland preservation in 2007. The Foundation continues to partner with your Park System, local municipalities, and other organizations to ensure a green and open landscape in Monmouth County. MCF, a not-for-profit 501(C)3 charitable organization, is dedicated to acquiring and holding our county’s rapidly diminishing open space

until the Park System or a local municipality is able to purchase and permanently preserve and manage the land. In 2007, the agency helped the Park System acquire land at Turkey Swamp Park and the Crosswicks Creek Greenway (pictured). To date, MCF has assisted in the permanent preservation of over 6,000 acres, of which more than 2,500 acres are part of your Park System.

**To learn how you can help, contact Monmouth Conservation Foundation, PO Box 4150, Middletown, NJ 07748; [www.monmouthconservation.org](http://www.monmouthconservation.org); or 732-671-7000.**



# 2007 Park System Volunteers

(More than 40 hours of service)

## 40 - 99 Hours

Catherine Apgar	Linda Jensen	Leslie E. Roche	Harden Fowler	Danielle Mitola
Kate Barron	Donald Karwacky	Claire Ryan	Kendall Galante	Eileen Murphy
Stavros Basis	Charles Katten	Alexandra Sarnataro	Ruth Gariepy	Shannon Murphy
John Bauer	Carl Kowalski	Melissa Schaefer	Jonathan Goldfarb	Chelsea Murray
Josephine Belluardo	Stephen Krzyzanowski	Marlis Schlegel-Steadman	Michael Graw	Jennifer Nelson
Beth Bickerton	William Landuyt	Anna Schoeffling	Martin Grubman	Lauren O'Connell
Maggie Boyce	Mary Leather	Richard Scott	Kara Gurrieri	Alexandra Palazzo
LoriJane Burns	Brooke Lichter	Richard Siessel	James Henry	Stephanie Platko
Nancy Cagliostro	Jeanette Lingelbach	Clare Skeen	Frank Inman	Alex Rauchman
Jaelyn Campis	Gerry Lingner	Hannah Skolnik	Billy Introcaso	David E. Roche
Alyssa Caprara	Kaitlyn Low	Mackenzie Slade	Tatiana Johnson	Marcus Scott
Landon Carter	Gail Mahoney	Loren Slutter	Erika Leigh Johnson	Katherine Scott
Courtney Chan	Sue Malmi	Kimberly Souza	Ian Kelly	David Shirley
Hugh Chang	Michele Mancino	Anne Sweetman	Kathryn Kroeper	Matthew Simpson
Hubert Chang	Nano Mardones	Natalie Wagner	Caitlin B. Krow	Connor Spahn
Karen Coppola	Patrice McCoy	Marianne White	Christine Landuyt	James Steele
Joe Coppola	Jonathan McPherson	Laury Wills	Linda Lawton	Samantha Vallone
Linda Corder	Beverly Miller	Joyce Wingerter	Chelsea M Livingstone	Barbara A. Venanzini
Eric Cresson	Michael S. Miller	Sandra Wolfe	Catherine Luick	Helen Weber
Chelsie Davis	Barry I. Miller	Kayla J. Wroblecky	Peter MacConnell	Tara Welsh
Danielle Decker	Victoria C. Monks	<b>99 + Hours</b>	Ralph Maratea	Lyndsay Williams
Arthur Dietrich	Christina Montalbano	Werner Aehlich	Brendon Maroney	Kira Womble
Frederick Einhorn	Melinda Mordarski	Bob Beccarelli	Kevin T. McGee	Jessica Wu
Genowefa Einhorn	Heather Muh	David Beil	Bob McMahon	Rebecca Wu
Kristie Eshelman	Abree Murch	Patricia Bernstein	Alisha Mejia	Anthony Younes
Patricia A. Farrell	Joan Myers	Pete Brady	Jessica Mejia	Amanda Zablocky
Ashley Fletcher	Drew Nathanson	Christine Brienza	Jessica Mennella	Daniel Zablocky
Brittany Fletcher	Alexanne Neff	Stacy B. Brody		
Page Fulton	Arthur Neill	Emma Caccavale		
Michelle Gagliardi	Jackie Neill	John Caddock		
Michael Galanti	Jessica Nelson	Corrine Clark		
Lydia Gallo	Lindsey Norton	Stacy Coppola		
Debbie Glenn	Joanne O'Leary	James Cusick		
Melissa Good	Alex Osnato	Raymond Dademo		
Diane L. Gulbenkian	Argo Parrello	Cynthia Dannen		
Nancy Haaren	Dina Parrello	Sarah Dean		
David Harris	Cameron Patchett	Louise Del Collo		
Ian Harvey	Wende Pickens	Michael DeVito		
Theresa Hauge	Stephanie Pilot	Ed Donovan		
Joyce Henry	Linda Pollack	Craig Doyle		
Suzanne Herlihy	Robert L. Randall	Brenin Ford		
Robert Isley	Betty Randall	Leslie Fornino		
Jean Isley	Kathryn Reese			
	Jason Reilly			

## 2007 Volunteer Groups

Deep Cut Bonsai Society  
Garden State Daylily Growers  
High Tech High School  
Huber Woods Equestrian Association  
Jersey Off-Road Bicycle Association  
Middletown North High School  
Middletown South High School  
Millstone Trail Blazers  
Monmouth Boy Scouts of America, *Order of the Arrow*  
Monmouth Council of Girl Scouts  
Red Bank Catholic High School  
Rutgers Cooperative Extension, *Master Gardeners*  
Shore Regional High School  
St. John Vianney High School  
Timberland Stores; Jackson and Freehold

# 2007 Value of In-Kind Donations, Contributions and Grants

(Unaudited, not included in Financial Statement on the following page)

## Donations and Contributions

### Friends of the Park

RAP and Other Programs	15,736.00	
Longstreet Farm Exhibit	57,691.00	
Various Park Improvements	10,066.00	
9/11 Memorial	10,315.00	
		93,808.00

### Monmouth University Urban Rec. Camps

14,910.00

### Monmouth Conservation Foundation (MCF)

Acquisition and Support Services		9,000.00
----------------------------------	--	----------

### Special People United to Ride (SPUR)

Scholarships	11,449.00	
In Kind Donations/Misc. Items	600.50	
Equipment/Furnishings	3,400.00	
Building Capital/Phase 2	107,022.16	
		122,471.66

### Miscellaneous Donated Items

1,720.00

## Grants

### N.J. Green Acres Grants

Various Acquisition Projects		750,000.00
------------------------------	--	------------

## Volunteer Hours

1,018 volunteers for a total of 26,245 hours @ \$18.77/hr*		492,618.65
--	--	------------

**Total**      **\$1,484,528.31**

\* Based on 2006 Independent Sector value ([www.independentsector.org](http://www.independentsector.org))

# 2007 Financial Statement

(Unaudited)

## Combined statement of revenue, expenses and fund balances for year ending December 31, 2007

	<b>Total</b>	<b>General</b>	<b>Trust</b>	<b>Donations</b>
<b>BEGINNING FUND BALANCE</b>	<b>\$8,266,032</b>		<b>\$8,158,499</b>	<b>\$107,533</b>
<b>INCOME</b>				
<b>County Appropriation</b>				
Salaries/Wages	<b>17,120,801</b>	<b>17,120,801</b>		
Other Expense Approp.	<b>3,338,118</b>	<b>3,338,118</b>		
<b>Revenue</b>				
Donations	<b>5,506</b>			<b>5,506</b>
Golf Courses	<b>9,159,671</b>	<b>6,086,350</b>	<b>3,073,321</b>	
Parks	<b>2,093,753</b>	<b>940,920</b>	<b>1,152,833</b>	
Monmouth Cove Marina	<b>807,277</b>		<b>807,277</b>	
Visitor Services	<b>2,053,285</b>		<b>2,053,285</b>	
<b>Total Income</b>	<b>\$34,578,411</b>	<b>\$27,486,189</b>	<b>\$7,086,716</b>	<b>\$5,506</b>
<b>EXPENDITURES</b>				
<b>Personnel</b>	<b>17,956,769</b>	<b>17,255,501</b>	<b>701,268</b>	
<b>Operations</b>	<b>7,541,575</b>	<b>1,641,083</b>	<b>5,892,753</b>	<b>7,739</b>
<b>Line Item Capital Expenditures</b>				
Bldgs & Facilities	<b>22,900</b>	<b>22,900</b>		
Equipment- Add'l	<b>231,853</b>	<b>210,583</b>	<b>21,270</b>	
Equipment - Replaced	<b>1,145,299</b>	<b>1,057,129</b>	<b>88,170</b>	
Site Improvements	<b>57,404</b>	<b>57,404</b>		
<b>General Revenue Returned to County Treasurer</b>				
Golf Courses	<b>6,086,350</b>	<b>6,086,350</b>		
Parks	<b>940,920</b>	<b>940,920</b>		
<b>Total Expenditures</b>	<b>\$33,983,070</b>	<b>\$27,271,870</b>	<b>\$6,703,461</b>	<b>\$7,739</b>
<b>Excess (Deficit) in Revenue</b>	<b>595,341</b>	<b>214,319</b>	<b>383,255</b>	<b>(2,233)</b>
<b>ENDING FUND BALANCE</b>	<b>\$8,861,373</b>	<b>\$214,319</b>	<b>\$8,541,754</b>	<b>\$105,300</b>

## **CAPITAL CASH & OPEN SPACE EXPENDITURES** (not included above)

Site Improvements	<b>\$4,311,213</b>
Land Acquisition	<b>20,942,638</b>
<b>Total</b>	<b>\$25,253,851</b>

# 2007 Monmouth County Budget

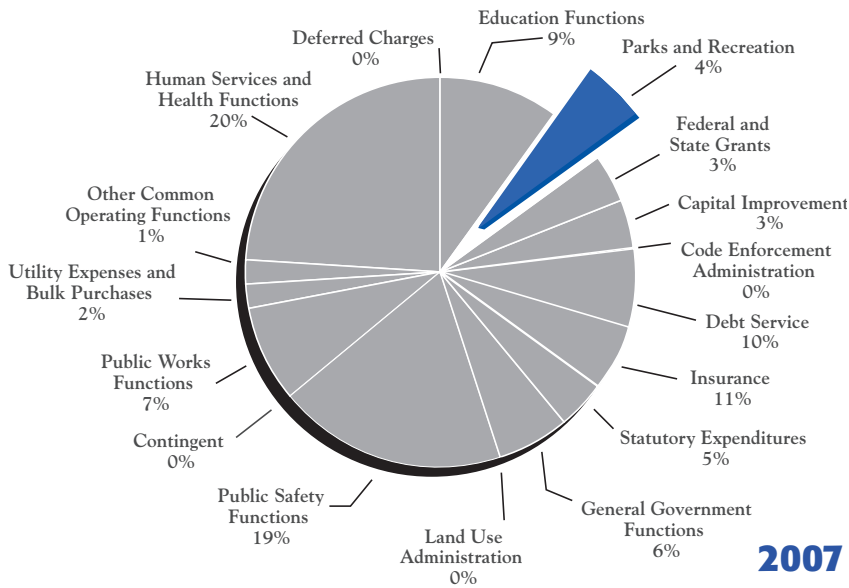

## 2007 Park System Revenue (\$34,578,411) by Source

**\$14,119,492**  
 Total amount of revenue earned by the Park System through programs, sales, admission fees, rentals, etc.

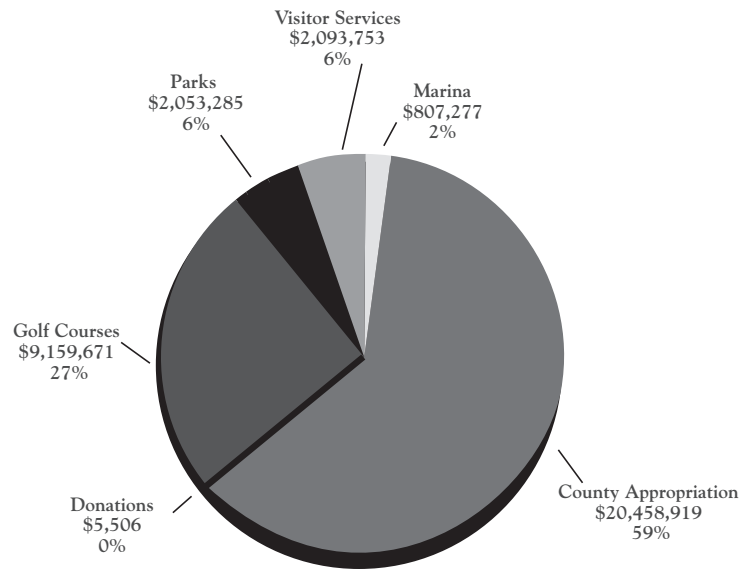

## 2007 Park System Expenditures (\$33,983,070) Excluding Capital

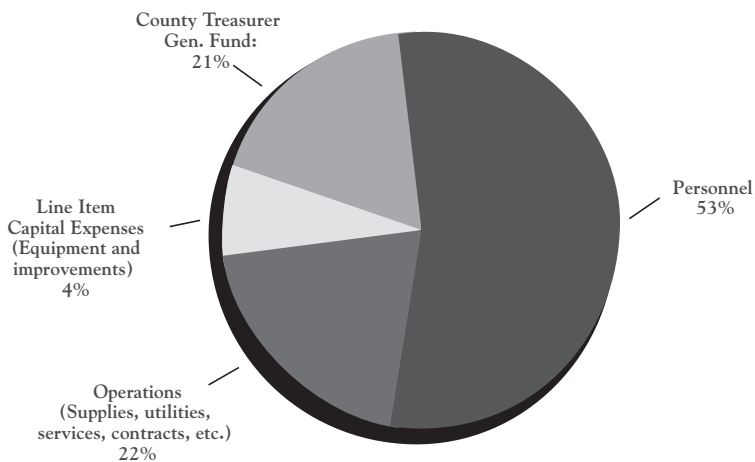

## 2007 Quick Facts

---

### Park Operations Acreage

Total Acres in Monmouth County.....	<b>301,804</b>
Total Acres in County Park System.....	<b>14,288</b>
Acres Acquired by Park System in 2007.....	<b>765</b>
Largest Park (in Acres) – Turkey Swamp Park.....	<b>2,111</b>
Smallest Park (in Acres) – Mount Mitchill Scenic Overlook.....	<b>12</b>
Total Miles of Park System Trails.....	<b>116</b>
Acres Managed as Natural Field Areas.....	<b>1,533</b>

### Visitation

Total Population of Monmouth County (Planning Board Estimate).....	<b>655,674</b>
Total County Park Visitation in 2007.....	<b>5,059,911</b>
Park With Highest Visitation in 2007 – Manasquan Reservoir.....	<b>918,106</b>
Summer Visitation at Seven Presidents Oceanfront Park.....	<b>232,944</b>

### Recreation Programming

Total Number of Recreation Programs Offered.....	<b>3,955</b>
Total Number of Program Participants.....	<b>116,936</b>
Participants in Recreation Assistance Program.....	<b>10,794</b>
Attendance at the 5-day Monmouth County Fair (1 rain day).....	<b>66,500</b>
Attendance at Thompson Park Day.....	<b>10,000</b>

### Golf

Total Number of Golf Courses.....	<b>8</b>
Total Yards in Golf Courses.....	<b>42,613</b>
Total Rounds of Golf Played.....	<b>214,217</b>
Resident Golf I.D. Cards Sold.....	<b>21,039</b>
Non-resident Golf I.D. Cards Sold.....	<b>77</b>

### Personnel

Full-time Staff.....	<b>347</b>
Part-time Staff (seasonal).....	<b>366</b>
Program/Contract Employees (Estimate: peak season average).....	<b>300</b>
Volunteers.....	<b>1,018</b>
Total Volunteer Hours.....	<b>26,125</b>

## 2007 Monmouth County Board of Chosen Freeholders

William C. Barham, Director • Lillian G. Burry, Deputy Director  
Robert D. Clifton • Anna C. Little • Barbara J. McMorrow

## Monmouth County Board of Recreation Commissioners



(top row, l to r) Park System Secretary-Director James J. Truncer, Fred J. Rummel, Violeta Peters, Michael G. Harmon, Freeholder Liaison Lillian G. Burry, N. Britt Raynor, Channing P. Irwin and Kevin Mandeville. (bottom row seated, l to r) Past Chairman Adeline H. Lubkert, Chairman Edward Loud and Vice Chairman Frederick C. Kniesler. (Note: Adeline Lubkert was replaced by Thomas E. Hennessy, Jr. in November of 2007.)

The Monmouth County Park System is proud to report accreditation by the National Commission for Accreditation of Parks and Recreation Agencies (CAPRA), which is sanctioned by the American Academy for Parks and Recreation Association (AAPRA) and the National Park and Recreation Association (NRPA). We were one of the first of 55 accredited agencies in the nation and one of only two organizations in New Jersey to have achieved such an honor.



805 Newman Springs Road, Lincroft, New Jersey 07738  
732-842-4000 [monmouthcountyparks.com](http://monmouthcountyparks.com)

