



Monmouth County Park System Creative Arts Center Parking Lot Expansion at Thompson Park PROJECT INFORMATION

PROJECT DESCRIPTION: With the completion of the Creative Arts Center addition in Thompson Park, this next phase will expand the existing parking lot by 29 spaces. The project also includes new curbs and concrete walkways as well as replacement of more efficient light standards. A new trail will connect to the Old Orchard Lot.

REASON FOR PROJECT: The 2,900 SF new wing on the Creative Arts Center adds an art gallery with an outdoor patio, another studio and an existing studio was replaced by a larger one. The additional space necessitates expanding the parking to accommodate additional users. This parking lot serves not only the Creative Arts Center but also the off leash dog area, two activity barns and parking for access to nearby trails. Parking spaces will be increased from 121 to 150 spaces. The parking lot is almost 30 years old and is in need of overall repairs, including necessary improvements to the subsurface drainage.

DESIGN APPROACH: Public parking design standards; accessibility; fit into the landscape.

PROJECT STATUS: The construction contract has been awarded and will be completed this Fall.

CONTACT INFORMATION: Joseph Sardonía, Supervising Landscape Architect
Monmouth County Park System, Acquisition & Design Department
Joe.Sardonía@co.monmouth.nj.us



Existing Parking Area

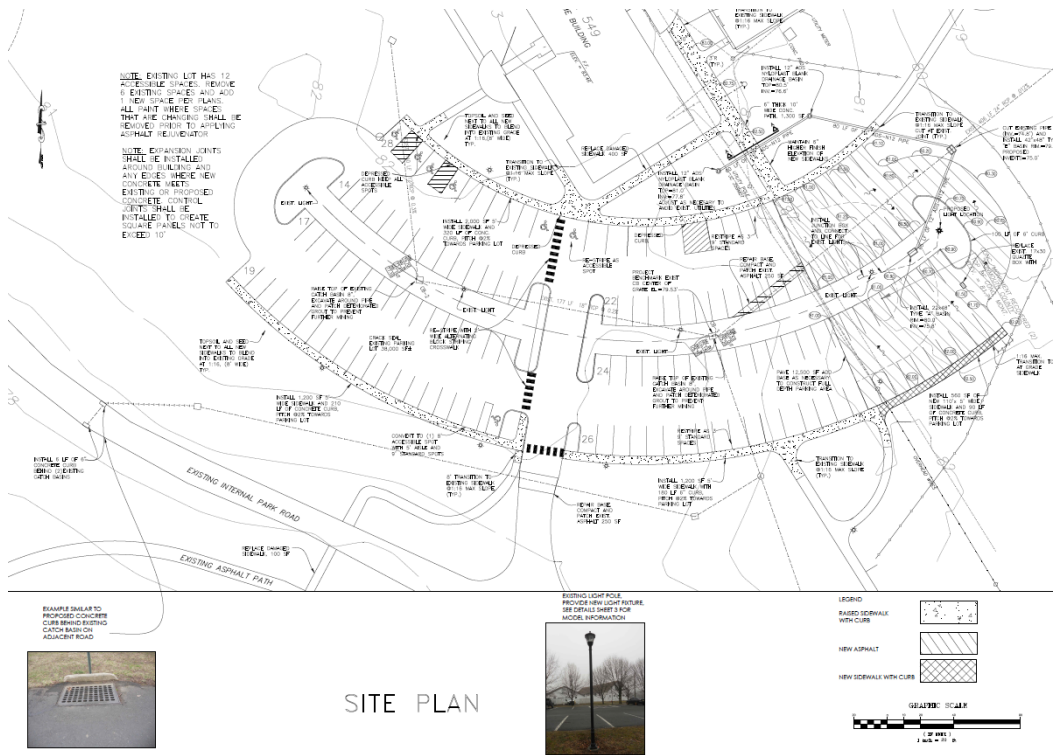

1 Creative Arts Center Parking Lot Expansion

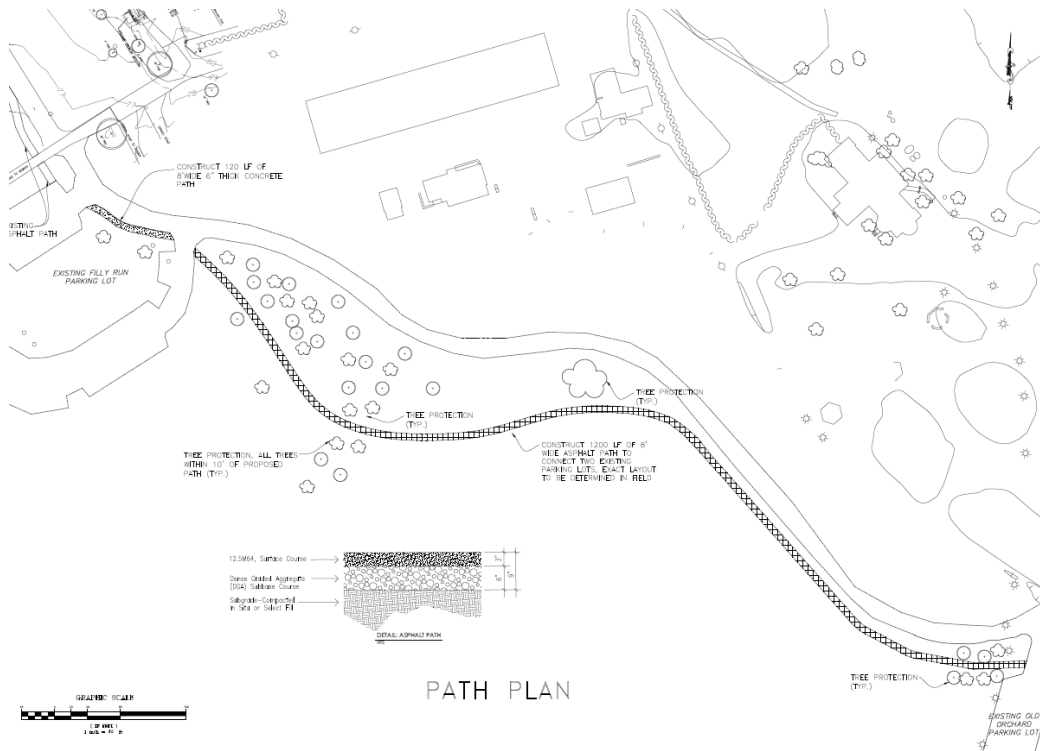

2 Trail connection to Old Orchard Lot