

ePACT For Families

Please access the ePACT Family App by going to www.epactnetwork.com/us/login and clicking the QR Code symbol. Add it to your home screen and once that is done, it will function like any other app.

(if you have an [Android phone](#), please use Chrome to add ePACT to your home screen, if you have an [iPhone](#), please use Safari)

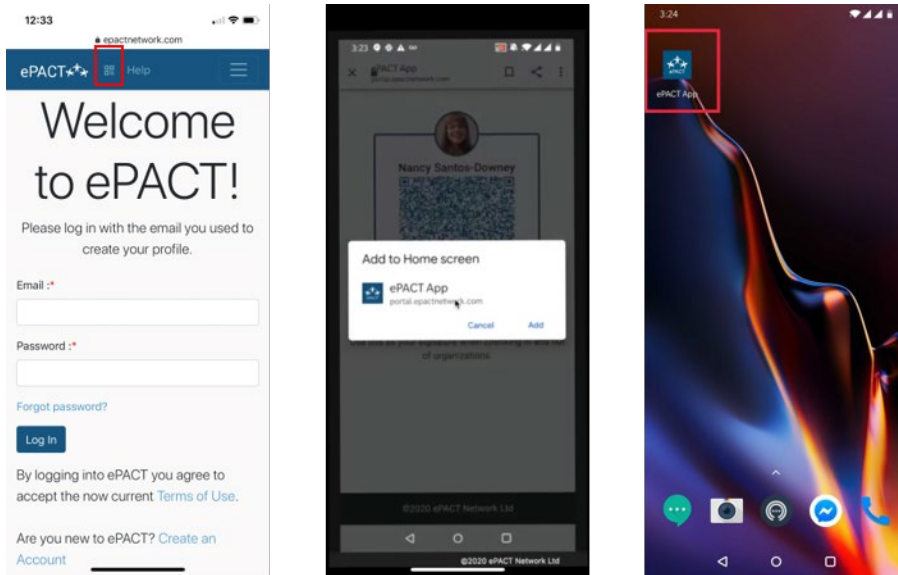

Once logged in, you will be able to access both the QR Code and the Health Screening Questions. Please click on "Health Screening Questions" and you will see a list of your children.

Once the questions are answered for your first child, you can answer questions for the next one.

(Please note that if your organization is not using pre-screening, you will see that no questions are available for your children at this time).

