

Park Hours

The park is open 6 a.m. to dusk from April 1-October 31, and 7 a.m. to dusk from November 1-March 31. The Visitor Center is open during regular park hours. The Environmental Center is open every day from 10 a.m.-4:30 p.m.; summer hours are 10 a.m.-5 p.m., and 10 a.m.-8:30 p.m. on Fridays.

For More Information If you would like additional information about any of the 42 parks, golf courses and open spaces of the Monmouth County Park System, or for the more than 6,000 programs offered each year; please call 732-842-4000, ext. 4312 (TTY-TDD 711) or visit us online.

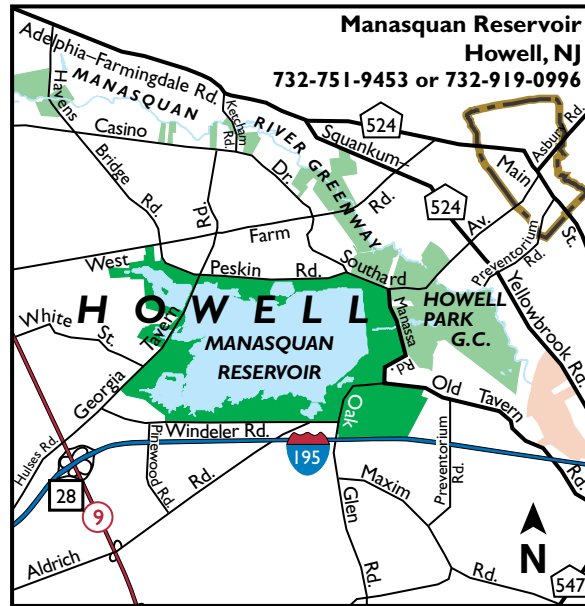

From the Garden State Parkway: Exit 98 to I-195 West. At Exit 28B, take Route 9 North-Freehold and stay in right lane. At first traffic light, turn right onto Georgia Tavern Road.

For Environmental Center: Continue on Georgia Tavern Road for 1 mile, entrance on right.

For Visitor Center and Boat Docks: Follow Georgia Tavern Road for 0.3 miles, turn right onto Windeler Road, continue for 1.5 miles to entrance on left.

Monmouth County
Board of Chosen Freeholders
Board of Recreation Commissioners



Monmouth County Park System

Manasquan Reservoir

Howell, NJ



www.monmouthcountyparks.com

Welcome to the Manasquan Reservoir

The Manasquan Reservoir is both a water source for towns and utilities and a natural setting for recreation and outdoor pursuits. The 770-acre reservoir is part of a larger 1,200-acre site that includes woods and wetlands, a beautiful 5-mile perimeter trail, areas for fishing and boating, a Visitor Center and an Environmental Center.

About the Reservoir

The reservoir is an important part of the water supply in Monmouth County. Water from the Manasquan River enters and exits the reservoir through the inlet/outlet tower in front of the main dam. With a 4 billion gallon water capacity and maximum 40' depth, the reservoir can supply up to 30 million gallons of water a day.



Protect Your Parks

The Park System preserves and manages natural and cultural resources on more than 16,000 acres of land in Monmouth County. Protecting water quality, eliminating invasive plant species, and promoting healthy wildlife habitats are just a few of the objectives. Please protect the park by leaving plants, animals, and other features as you found them; adhering to posted rules; using designated containers for trash, recyclables, and pet waste; and keeping your pets leashed. Alcoholic beverages are not permitted.

An overabundance of white-tailed deer around the Manasquan Reservoir is threatening the health of native plant and animal species. Areas next to this park (Bear Swamp Tract and Howell Park Golf Course) may be open during some or all of the State-regulated hunting season. All hunting areas are clearly posted.

For more information, please pick up a copy of the Deer Management Program brochure, call 732-842-4000, ext. 4237 or visit www.monmouthcountyparks.com.



Visitor Center 732-919-0996

This is the site for boating activities at the reservoir and features a boat rental area, bait shop, vending machines, and a fireplace. Enjoy spectacular views from the second level observation deck.



Boating

Boats with electric motors, sailboats, kayaks, and canoes (at least 8') are permitted on the reservoir March 1-November 30. All vessels are launched from the Visitor Center, and require purchase of a daily or seasonal launch pass (sold on site). Rowboats (with or without electric motors) and kayaks can be rented from April 1/Memorial Day Weekend-October 31. Canoe, kayak and sailing lessons available.

Fishing

The reservoir is open year round for fishing and is stocked with large- and small-mouth bass, hybrid striped bass, tiger muskie, bullhead catfish and panfish species. A NJ state fishing license is required for anglers age 16-69. Please consult signs for restrictions/advisories. Shoreline anglers can park inside the Main Entrance or at Chestnut Point. Wading prohibited.

Playground

A wildlife-themed playground, highlighting species found at the reservoir, is located near the Visitor Center.

Winter Activities

The reservoir is open for ice-skating, ice-boating and ice-fishing, depending on weather conditions.

Environmental Center 732-751-9453

Visitors can explore wetland ecology and learn about wildlife protection through interactive exhibits, multi-media presentations, wildlife observation areas, and educational activities. Park Naturalists offer boat tours and a variety of nature programs - from eagle viewing to pond studies - for individuals, schools and community groups.



Nature & Wildlife

Forests at the reservoir are an interesting mix of species. The park also has six created wetlands and trailside wildflower meadows. More than 20 varieties of fish, 20 types of mammals, 25 different reptiles and amphibians, and 200 species of birds inhabit the Manasquan Reservoir and its surroundings. Stop by the Environmental Center for news of current wildlife sightings, including seasonal listings of mammals, birds, reptiles, amphibians and "watchable insects," such as butterflies and dragonflies.



Photo by Dennis Ruffe



Manasquan Reservoir

311 Windeler Road, Howell, NJ 07731 (VC)
 331 Georgia Tavern Road, Howell, NJ 07731 (EC)
 732-919-0996, 732-751-9453
 732-938-6760 (Ranger Station)

www.monmouthcountyparks.com



LEGEND

- | | | | |
|--|--|--|-----------------------|
| | Building | | Vending Machines |
| | Reservoir | | Wildlife Viewing Area |
| | Wooded/Forests | | Fishing |
| | Cleared Area | | Ice Skating |
| | Wetland Area | | Boat/Launch |
| | Restricted Area
(Trail users remain on trail)
(Boaters avoid busy lines) | | Playground |
| | Stream | | Parking |
| | Milepost | | Accessible |
| | Easy Trail | | Information |
| | Moderate Trail | | Restrooms |
| | Road | | First Aid |
| | Property Line | | Portable Toilet |
| | Boardwalk | | Nature Trail |
| | Bridge | | |

NOTES: Each person boating on the reservoir must wear a US Coast guard approved, type I, II, III, or IV hybrid personal flotation device.

NJ State Police Boater Safety Certificate required to operate powered vessels.

For personal vessels, children under 14 must be accompanied by an adult. NJ State boating laws and Park System rules and regulations are posted.

Swimming is prohibited.

Trails

When using the trails please plan your route, take a trail map with you and wear appropriate safety gear. Stay on marked trails and avoid entering unmarked wetland areas; they are designated wildlife habitats. Most trails in the Monmouth County Park System are open to walkers, runners, hikers, bicyclists and equestrians. Please obey the rules of protocol for yielding right of way.

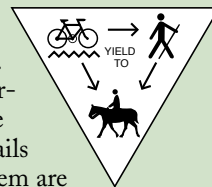

NOTE: It takes approximately 20 minutes to walk 1 mile (1.6 km) at a brisk pace.

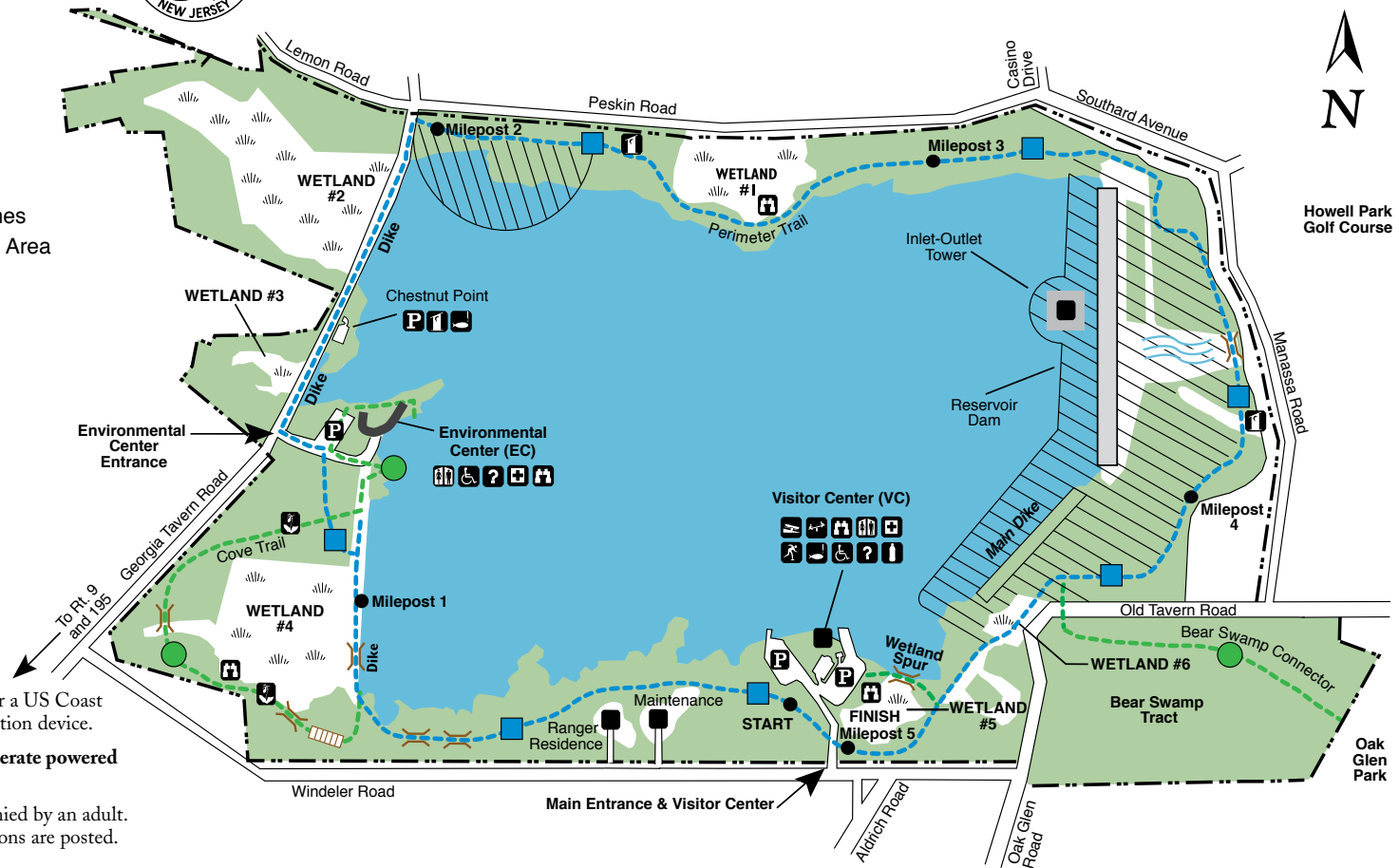

Trail Key

- Cove Trail:** This 1.1 mile (1.8 km) scenic nature trail explores the lakeshore around the Environmental Center. Pedestrians only.
- Bear Swamp Connector:** An easy 0.5 mile (0.8 km) connection to Howell Township's Oak Glen Park.
- Wetland Spur:** This 0.2 mile (0.3 km) walk across a dike is a quick, scenic connection from the Visitor Center to Perimeter Trail.
- Perimeter Trail:** This scenic, 5.1-mile (8.3 km), multi-use trail loops all the way around the reservoir. It has a fairly even, well-maintained natural surface but has been designated as a MODERATE trail due to its length. Mileposts are marked on the map.

Trail Standards

- EASY:** short, well-maintained trails intended for casual walking
- MODERATE:** longer trails with some grades/obstructions; intended for hikers, equestrians and all-terrain bicyclists; may also be suitable for some walkers and runners
- CHALLENGING:** long, more primitive trails with steep grades/obstructions; intended for highly experienced hikers, equestrians and all-terrain bicyclists (none at this site)