



BOARD OF ELECTIONS



Poll Worker Press

2026 Primary Edition - Focus on voting as a positive, meaningful experience

2026 PRIMARY ELECTION DATES

Early Voting	May 26 — May 31, 2026
General Election	June 2, 2026

**POLL WORKER
HOTLINE NUMBER**
(General Election Day Only)
732-431-7040



PLEASE MAKE SURE WE HAVE YOUR CORRECT EMAIL ADDRESS & REMEMBER TO CHECK YOUR SPAM FOLDER!



SPOTLIGHT ON...

LITTLE SILVER EARLY VOTING 2025 GENERAL



Happy Poll Workers (l-r) John Guarino; Albert Doty; William Gillespie



Thank You! KEANSBURG AND LONG BRANCH FOR PARTICIPATING IN OUR ONLINE POLL WORKER ASSIGNMENT SYSTEM!



ATTENTION!!



WHEN REFERRING VOTERS TO THE JUDGE, PLEASE DIRECT THEM TO THE COURTHOUSE, 71 MONUMENT STREET, FREEHOLD, NJ. POLL WORKERS SHOULD ALSO CALL BOE OFFICE ASAP!

MONMOUTH COUNTY BOARD OF ELECTIONS STAFF

Robin, Tracee, Kim, Julia, John, John, Gary, Ed, Nikita, Lia





PETER KAPSALES (Zone 2)
CYNTHIA McMILLIAN (Zone 2)
ANNETTE FIGUEROA (Zone 4)
JEREMY MASELKO (Zone 5)
VANDANA SHAH (ZONE 6)

2026 EARLY VOTING LOCATIONS

COLTS NECK TOWNSHIP	MANALAPAN TOWNSHIP	HOWELL TOWNSHIP	HAZLET TOWNSHIP	MIDDLETOWN TOWNSHIP
Colts Neck Public Library 2 Veterans Way Colts Neck, NJ 07722	Monmouth Cty Library—HQ (Meeting Rooms 1-2-3) 125 Symmes Drive Manalapan, NJ 07726	Church of St. Veronica (Gymnasium) 4219 Route 9 North Howell, NJ 07731	Hazlet Fire Co #1 570 Holmdel Road Hazlet, NJ 07730	Croydon Hall (Assembly Hall) 900 Leonardville Road Leonardo, NJ 07737
LITTLE SILVER BOROUGH	NEPTUNE TOWNSHIP	LONG BRANCH CITY	SPRING LAKE HEIGHTS	UPPER FREEHOLD TWP
Woman's Club of Little Silver (Main Lobby) 111 Church Street Little Silver, NJ 07739	Neptune Twp Senior Center (Fitness Center) 1607 Corlies Avenue Neptune, NJ 07753	Long Branch Senior Center (Coca Cola Room) 85 2nd Avenue Long Branch, NJ 07740	Cornelius V. Kelly Community Center 902 Ocean Road Spring Lake, NJ 07762	Hope Fire Company #1 (Meeting Room) 82 Route 526 Allentown, NJ 08501



DISABILITY CERTIFICATES FOR ASSISTANCE

To: John Smith Reg # A1234567890
(name of voter)

Do you solemnly swear (or affirm) that you are
Disability
(physical disability – state nature of)

(*Blindness)
and that by reason thereof, you are unable to enter and remain in a booth,
or prepare your ballot therein for voting at this election, without assistance;
so help me God. [R.S. 19:31 A-6]

Name of member of Board of Registry and Election taking oath

Must be signed by 2 members
of board of Registry and Election
of opposite political party
assisting voter.

Jane Smith

*Name of voter assisting blind voter
123 Main Street, Middletown NJ

Address of voter assisting blind voter

PRIMARY
GENERAL
SPECIAL 20 23

DISABILITY CERTIFICATE FOR ASSISTANCE FORM

If someone (including a Poll Worker) assists a voter during the voting process, they must complete a Disability Certificate for Assistance form.

DISABILITY CERTIFICATES FOR ASSISTANCE

To: John Smith Reg # A1234567890
(name of voter)

Do you solemnly swear (or affirm) that you are
Disability
(physical disability – state nature of)

(*Blindness)
and that by reason thereof, you are unable to enter and remain in a booth,
or prepare your ballot therein for voting at this election, without assistance;
so help me God. [R.S. 19:31 A-6]

Jane Pollworker

Name of member of Board of Registry and Election taking oath

Must be signed by 2 members
of board of Registry and Election
of opposite political party
assisting voter.

Joe Pollworker
Joann Pollworker

*Name of voter assisting blind voter
123 Main Street, Middletown NJ

Address of voter assisting blind voter

PRIMARY
GENERAL
SPECIAL 20 23

POLL WORKER ASSISTANCE

VOTER REPRESENTATIVE ASSISTANCE

ADA PARKING SPACES

Do not park in the ADA spaces—they are for ADA voters only! Park next to these parking spots. (Poll Workers parking in these spaces during the election are in violation of the DOJ.)

Offer Voters 4 Easy Steps to "How to Cast Your Vote"

English!

Spanish!

This two-sided form is to be used with the voting machines. Poll Workers will offer the voter to bring it into the voting booth to help cast their vote. Keep this form on the back of the machine when not in use so it is easily accessible for all Poll Workers working the voting machines.

- Friendly Reminder**
1. PLEASE MAKE SURE TO TURN ON THE SURGE PROTECTORS FOR YOUR POLLBOOKS AND PRINTERS.
 2. RETURN ALL CORDS TO THE BACK OF THE MACHINE AT THE END OF THE NIGHT.
 3. THE TOP ACCESS DOOR, WHICH CONTAINS THE FLASH DRIVE ON MACHINES, MUST BE COMPLETELY CLOSED.
 4. ONLY DOCUMENTED SERVICE ANIMALS ARE ALLOWED IN THE POLLING LOCATIONS.
 5. VOTING AUTHORITIES ARE NOT ISSUED TO PROVISIONAL VOTERS.
 6. REFRAIN FROM DISCUSSING POLITICAL VIEWPOINTS AT THE POLLS (GROUNDS FOR IMMEDIATE DISMISSAL!)
 7. DO NOT BRING OUTSIDE WORK-RELATED ITEMS TO THE POLL SITES.
 8. ALL POLL WORKERS NEED TO RESPOND TO THE AVAILABILITY LETTER IF THEY PLAN TO WORK AN ELECTION.
 9. POLL WORKERS ARE SCHEDULED TO BE PAID FOR THE PRIMARY ELECTION **AFTER JULY 1ST**.
 10. **ALL PAYCHECK QUESTIONS SHOULD BE DIRECTED TO THE BOE OFFICE ONLY!**

On behalf of the BOE Commissioners and Staff,
"THANK YOU" for your dedicated commitment to the election process.



EQUIPMENT & TECHNOLOGY UPDATES



FLIP STYLE POLLBOOKS

The May Municipal (Early Voting) Election will introduce the new Flip Style Pollbooks in Long Branch City.

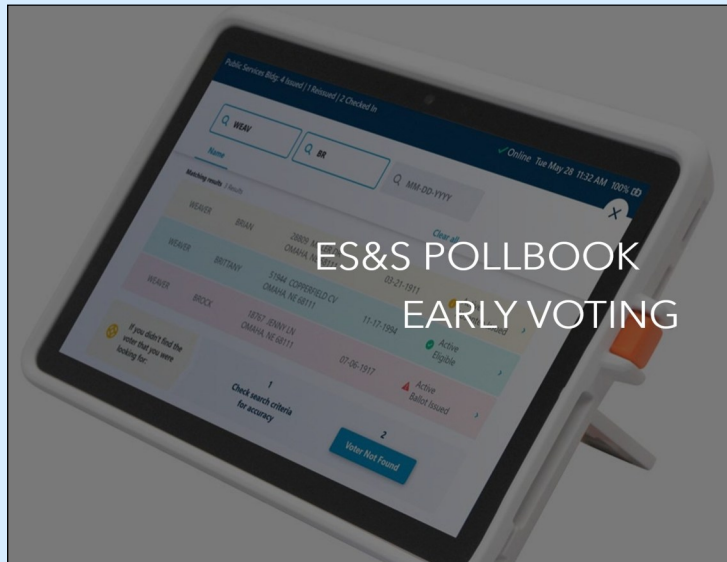

POCKET TALK TRANSLATORS

We're rolling out translator devices for the upcoming May Municipal (Early Voting) Elections. This device will assist voters needing support in a language other than English.



NEW POLLBOOK ADDRESS CHANGE FEATURE

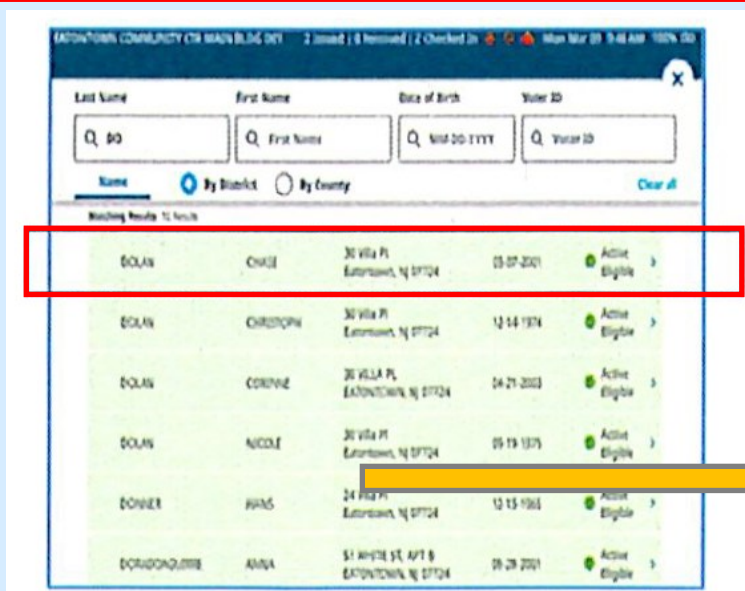

Step 1: When you are searching on the pollbook for a voter and the address information does not match.

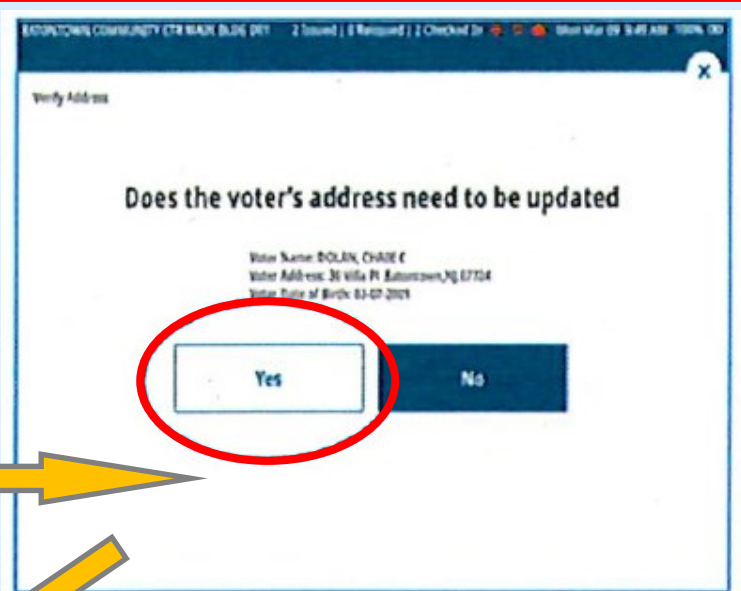

Step 2: This screen will pop up asking if voter's address needs to be updated. Click the 'Yes' button.

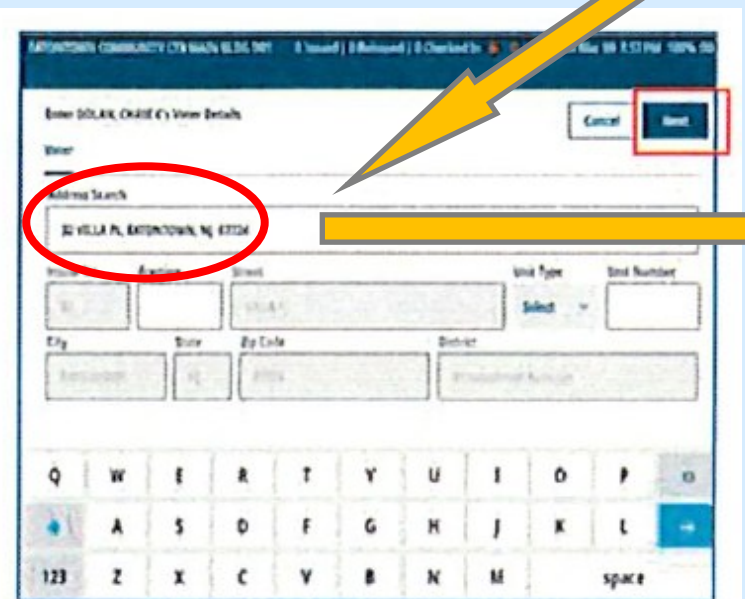

Step 3: Enter address information, then click 'Next' button when address is complete.

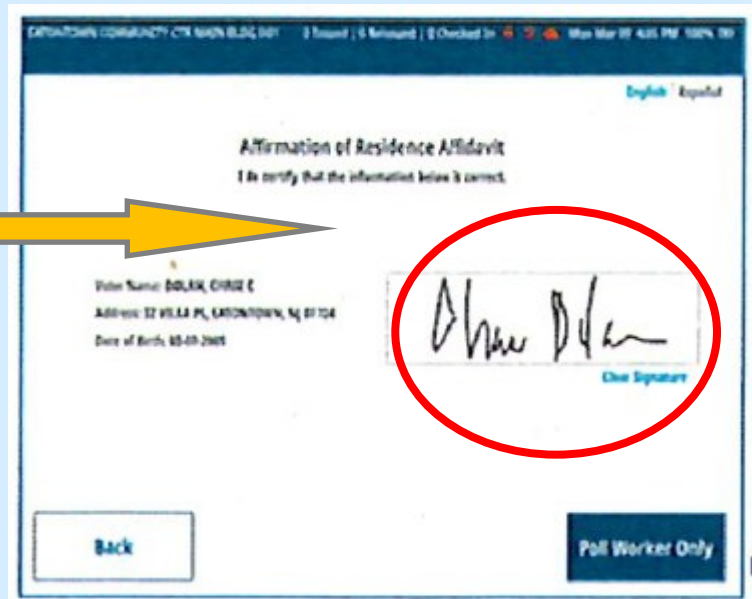

Step 4: Voter signature required to affirm updated address.

NEW POLICY CHANGES FOR MONMOUTH COUNTY

2026 REDISTRICTING IN MONMOUTH COUNTY

The Board of Elections approved redistricting maps for 2026 as indicated below.

DISTRICTS IN MONMOUTH COUNTY 2026

Aberdeen Township	15	Long Branch City	17
Allenhurst Borough	1	Manalapan Township	31
Allentown Borough	2	Manasquan Borough	4
Asbury Park City	9	Marlboro Township	34
Atlantic Highlands Borough	4	Matawan Borough	7
Avon-by-the-Sea Borough	2	Middletown Township	52
Belmar Borough	5	Millstone Township	7
Bradley Beach Borough	4	Monmouth Beach Borough	2
Brielle Borough	4	Neptune City Borough	4
Colts Neck Township	8	Neptune Township	20
Deal Borough	1	Ocean Township	19
Eatontown Borough	9	Oceanport Borough	5
Englishtown Borough	2	Red Bank Borough	9
Fair Haven Borough	4	Roosevelt Borough	1
Farmingdale Borough	1	Rumson Borough	6
Freehold Borough	7	Sea Bright Borough	2
Freehold Township	28	Sea Girt Borough	2
Hazlet Township	17	Shrewsbury Borough	3
Highlands Borough	4	Shrewsbury Township	1
Holmdel Township	10	Spring Lake Borough	4
Howell Township	38	Spring Lake Heights Borough	5
Interlaken Borough	1	Tinton Falls Borough	15
Keansburg Borough	6	Union Beach Borough	5
Keyport Borough	6	Upper Freehold Township	5
Lake Como Borough	1	Wall Township	23
Little Silver Borough	5	West Long Branch Borough	6
Loch Arbour Village	1		



Monmouth County Board of Elections
300 Halls Mills Road • Freehold, NJ 07728
732-431-7802 x7150

REDISTRICTING EXPLAINED

NJSA

TITLE 19

- The size and quantity of election districts are determined by the number of active registered voters in a municipality
- Voter counts should average between 250 and 1,500 registered voters in each election district
- Other factors such as number of available booths or voter convenience can also impact the size of an election district
- For example, no election district should be so large that any voters in that district would have to travel great distances to reach their assigned polling place

NJSA

TITLE 15

- "No election district shall be divided during the period commencing 85 days before the primary or the general election. No election districts shall, except with the prior approval of the Secretary of State, be created, abolished, divided, or consolidated between January 1 of a year whose last digit is seven, and December 1 of any year whose last digit is zero."



EFFECTIVE FOR THE 2026 PRIMARY ELECTION:

VOTERS TURNING 18 YEARS OLD BY THE 2026 GENERAL ELECTION (NOVEMBER 3)
ARE ELIGIBLE TO VOTE IN THE JUNE 2026 PRIMARY ELECTION PROCESS



NO ELECTIONEERING!



Do Not Enter the Polling Place, or Stand within 200 feet of the Outside Entrance of the Polling Place or Ballot Drop Box, **WEARING** or **DISPLAYING** Anything that may offer Support for or Opposition against any Candidate, Party or Public Question on the Ballot. Any political badge, button, insignia, t-shirt, hat or other display that can be read or viewed to identify support or opposition of a candidate, political party or public questions on the ballot is banned from this polling location. This prohibition extends to ballot drop boxes and is applicable for **ALL** elections.

19-34-15 a. If a person shall distribute or display any circular or printed matter or offer any suggestion or solicit any support for any candidate, party or public question within the polling place or room or within a distance of 100 feet of the outside entrance to such polling place or room, or within 100 feet of a ballot drop box in use during the conduct of an election, the person shall be guilty of a disorderly persons offense.

b. Each county board of elections shall have the discretion to extend the prohibition against electioneering provided under subsection a. of this section to be within a distance of 200 feet of the outside entrance to a polling place or room, or of a ballot drop box in use during the conduct of an election within the county. Each county board of elections shall provide a clear and conspicuous notice of the electioneering prohibition outside the polling place, room, or ballot drop box prior to placing the prohibition into effect, including the penalties for any violation of that prohibition. A person who violates an electioneering prohibition established by a county board of elections pursuant to this subsection shall be guilty of a disorderly persons offense.

19-34-19. No person shall display, sell, give or provide any political badge, button or other insignia to be worn at or within one hundred feet of the polls or within the polling place or room, on any primary, general or special election day or on any commission government election day, except the badge furnished by the county board as herein provided.

A person violating any of the provisions of this section shall be guilty of a disorderly persons offense.

UPDATE 2026

**NO ELECTIONEERING
WITHIN 200 FEET
OUTSIDE THE
POLLING LOCATIONS**

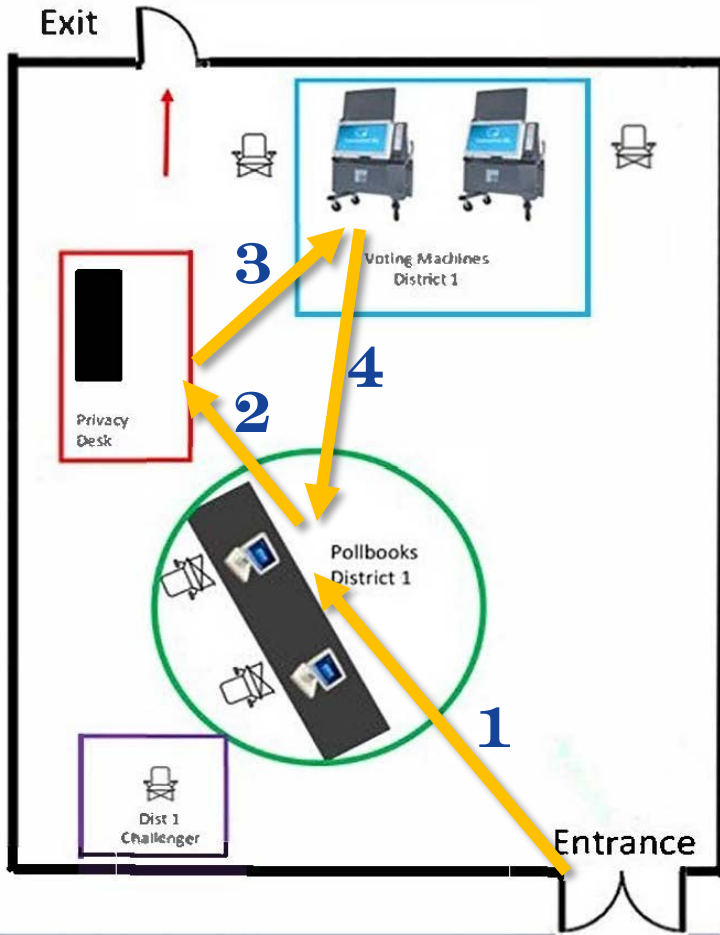

PROVISIONAL PROCESS

The Provisional Voting Process no longer has the Voter coming back to the check in table for an activation card. The instructions below and the diagram on the left will guide you through the new provisional process.

1 VOTER CHECK IN

If a Provisional Ballot is necessary, Poll Worker issues an Activation Card along with the Provisional Ballot Affirmation Statement.

2 FILL OUT PROVISIONAL FORM

Direct voter to take Provisional Affirmation Statement and Activation Card to privacy table and complete the Provisional form.

3 VOTING MACHINE

Voter completes form and takes Provisional Affirmation Statement and Activation Card to the Voting Machine to cast their ballot.

4 COMPLETING THE VOTING PROCESS

Once voter casts their ballot, voter will insert the Activation Card into the Provisional Affirmation Statement envelope, seal it, and bring it back to the Poll Worker Check In table. Poll Worker will check it for completion and place it inside the Orange Provisional Bag.

PRIMARY 101

1. ONLY REPUBLICAN, DEMOCRATIC AND UNAFFILIATED VOTERS MAY VOTE IN NJ PRIMARY ELECTIONS.
2. REPUBLICAN VOTERS SHOULD RECEIVE A BLUE VOTING AUTHORITY AND PINK FOR DEMOCRATIC VOTERS.
3. UNA (UNAFFILIATED) VOTERS CAN VOTE AT THE POLLS BUT MUST DECLARE EITHER REP OR DEM.
4. REP/DEM VOTERS CAN ONLY CHANGE PARTY AFFILIATION **55 DAYS** BEFORE PRIMARY ELECTION-NOT AT POLLS.
5. VOTERS NOT IN THE POLLBOOK ARE TO BE ISSUED A PROVISIONAL BALLOT DESIGNATING THEIR PARTY (DEM OR REP).

RESULTS REPORTS:

- Print and sign 4 copies of the **Final Results Report** and 1 copy of the **Write-In Report** and **Zero Proof Report** per machine.
- 1 copy of Final Results Report (per machine) will remain at the polling place; remaining copies put in the clear envelope in blue bag.
- Write-In Report (per machine) must be returned to the County Clerk, placed in the clear envelope in the blue bag.



March Madness at the BOE! (l-r) (Back row) John; Kim; John. (Middle row) Gary; Ed; Nikita. (Front row) Lia; Julia.



Our Success is Because of You!